



78 Elder Court | Mead Lane | Hertford | SG13 7FZ

£1,200 pcm

A one bed roomed ground floor apartment conveniently situated close to the town centre, Hertford East rail station and Hartham Park. Allocated parking and secure entry phone system. Unfurnished. EPC rating-B. Council Tax band-C. Deposit will be equal to one month rent'

- communal secure entrance
- One bedroom apartment
- Entrance hall
- Fitted Kitchen
- Car parking bay



Property Description

COMMUNAL ENTRANCE

ENTRANCE HALL

KITCHEN/LOUNGE

13' 3" x 21' 10" (4.04m x 6.65m)

BEDROOM

8' 9" x 15' 9" (2.67m x 4.8m)

BATHROOM

7' 3" x 5' 6" (2.21m x 1.68m)

ALLOCATED PARKING SPACE

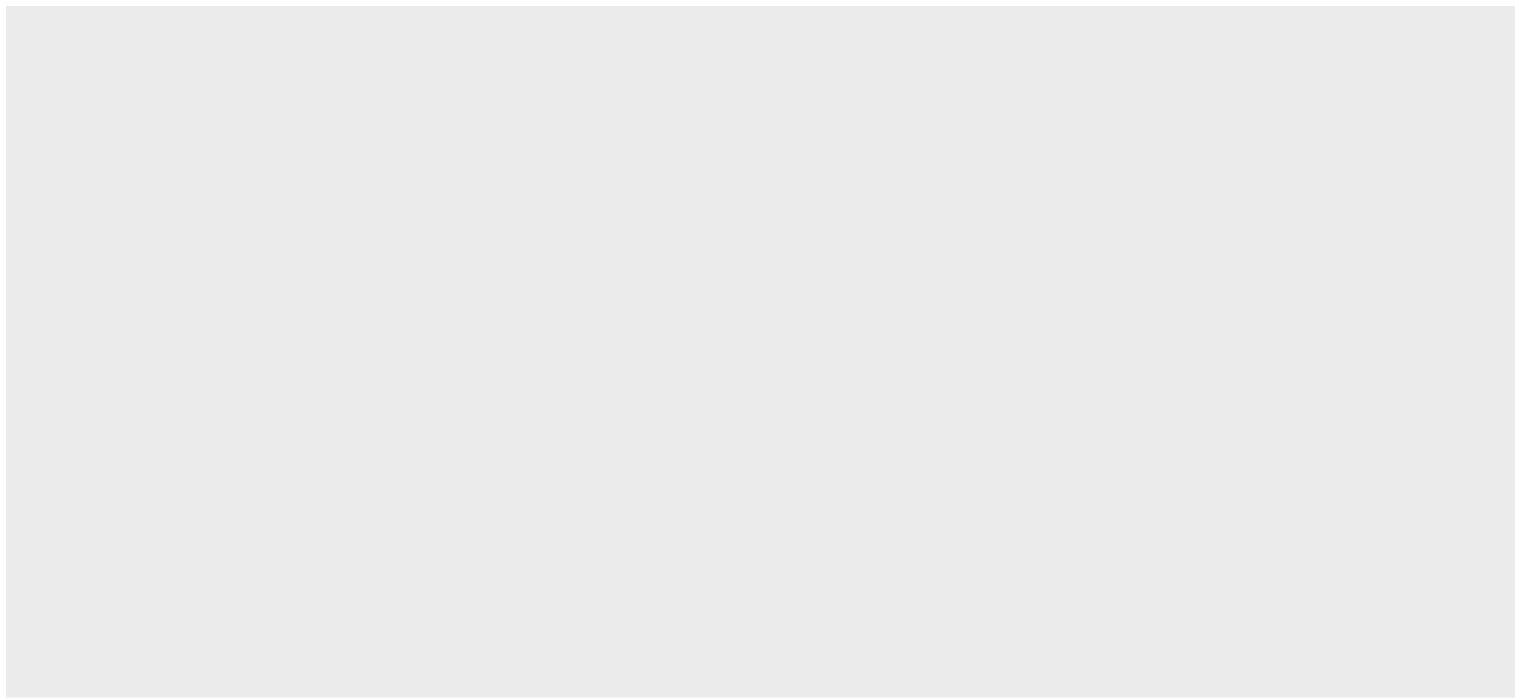

Approx Gross Internal Area
46 sq m / 493 sq ft

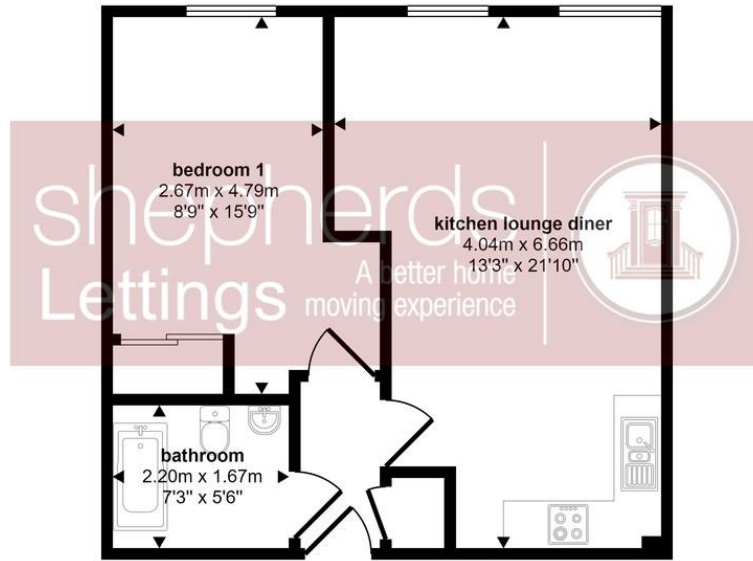

Floorplan

This floorplan is only for illustrative purposes and is not to scale. Measurements of rooms, doors, windows, and any items are approximate and no responsibility is taken for any error, omission or mis-statement. Icons of items such as bathroom suites are representations only and may not look like the real items. Made with Made Snappy 360.

Council Tax Band

C

Viewing Arrangements

Strictly by appointment

Contact Details

6 Millbridge

Hertford

Hertfordshire

SG14 1PY

www.shepherdsfhertford.com

lettings@shepherdsfhertford.co.uk

01992 551955

Energy Efficiency Rating

Score	Energy rating	Current	Potential
92+	A		
81-91	B	81 B	83 B
69-80	C		
55-68	D		
39-54	E		
21-38	F		
1-20	G		

Agents Note: Whilst every care has been taken to prepare these sales particulars, they are for guidance purposes only. All measurements are approximate are for general guidance purposes only and whilst every care has been taken to ensure their accuracy, they should not be relied upon and potential buyers are advised to recheck the measurements