

Aldreds
Estate Agents



37 Somerville Avenue

Gorleston, Great Yarmouth, NR31 7NP

£200,000



37 Somerville Avenue

Gorleston, Great Yarmouth, NR31 7NP

This 3 bedroom end terraced house with a good size rear garden and off road parking is offered for sale with no onward chain. The property benefits from gas central heating and UPVC double glazed windows. and is ideally located for access to the James Paget Hospital.

Entrance Hall

10'9" x 6'5" (3.28m x 1.96m)

UPVC entrance door with two double glazed panels. Radiator. Electronic thermostat control for heating. Under stairs recess with fitted shelves. Built-in under stairs storage cupboard. Staircase to first floor landing. Smooth plaster ceiling.

Lounge

13'5" x 10'10" plus recess (4.09m x 3.30m plus recess)

Radiator. Cable television point. Feature fireplace. Recess of 1.35m x 0.76m (4'5" x 2'6"). Coving. Smooth plaster ceiling. UPVC double glazed window to front aspect.

Kitchen

11'1" x 9'9" (3.38m x 2.97m)

Worktops with cupboards below. Stainless steel one and a half bowl single drainer sink with mixer tap. Tiled splashback. Built-in fan assisted oven and grill. Four ring electric hob. Utility space below worktop with plumbing for washing machine. Recess for fridge/freezer. Wall mounted gas fired combination boiler. Textured ceiling. UPVC door with double glazed panel to side. UPVC double glazed window to rear aspect. Opening through to dining area.

Dining Area

10'1" x 9'11" max, 8'9" min (3.07m x 3.02m max, 2.67m min)

Two radiators. Built-in storage cupboard. Smooth plaster ceiling. UPVC double glazed window to rear aspect.

First Floor

Landing

Smooth plaster ceiling with loft access hatch. UPVC double glazed window to side.

Bedroom 1

11'2" x 9'9" plus door recess (3.40m x 2.97m plus door recess)

Radiator. Smooth plaster ceiling. Coving. UPVC double glazed window to front aspect.

Bedroom 2

11'9" x 9'11" plus door recess (3.58m x 3.02m plus door recess)

Radiator. Open wardrobe with two hanging rails. Smooth plaster ceiling. UPVC double glazed window to rear aspect.





Bedroom 3

8'10" x 7'10" max, 5'1" min (2.69m x 2.39m max, 1.55m min)

Radiator. Built-in wardrobe. Coving. Smooth plaster ceiling. UPVC double glazed window to front aspect.

Bathroom

5'6" x 5'5" (1.68m x 1.65m)

Fully tiled walls and a white panelled bath with mixer tap and shower attachment. Pedestal wash basin. Towel radiator. Extractor. Coved and textured ceiling. UPVC double glazed window to rear.

Separate WC

WC. Part tiled walls. Coving. UPVC double glazed window to side.

Outside

The front garden has been laid to lawn with the remainder left for off-road parking for two vehicles. A door to the side of the property leads to the rear garden which is laid partly to lawn with established trees and shrubs. There is a brick built storage shed and a timber built garden shed.

Tenure

Freehold.

Services

Mains water, gas, electricity and drainage are connected.

Council Tax

Great Yarmouth Borough Council - Band B

Location

Gorleston-on-Sea is a coastal town 2 miles from Great Yarmouth centre and has a varied selection of local shops * Golf Course * Modern District hospital * Schools for all ages * Library * Regular bus services to the main shopping areas and a sandy beach.

Directions

From the Gorleston office head south along the High Street, at the traffic lights turn right into Church Lane, at the roundabout turn left into Middleton Road, turn right into Gloucester Avenue, turn right into St Benets Road, turn left into Somerville Avenue where the property can be found on the left hand side.

what3words

///conclude.rare.absent

Ref: G18460/03/26



Floor Plan

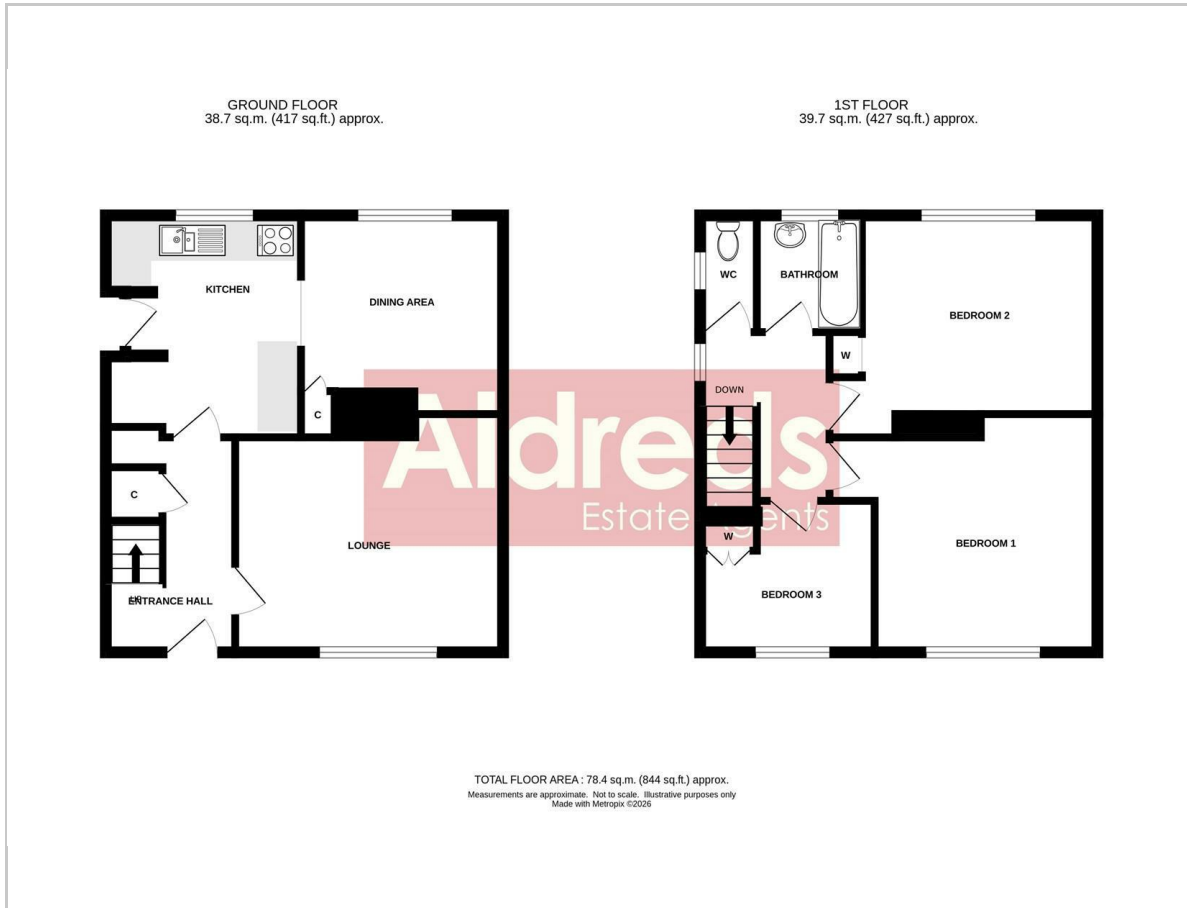

Area Map

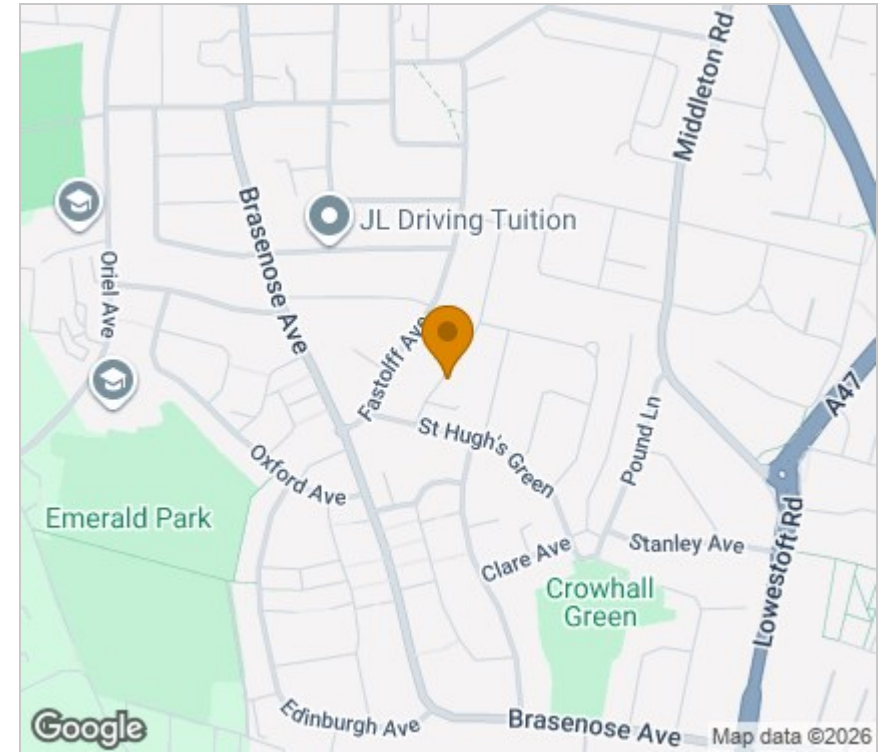

Viewing

Please contact our Aldreds Gorleston Office on 01493 664600 if you wish to arrange a viewing appointment for this property or require further information.

Disclaimer

These particulars are issued on an understanding that all negotiations shall be conducted through Messrs. Aldreds. Please note: Messrs. Aldreds for themselves and for the vendors or lessors of this property whose agents they are given notice that: 1. Particulars are set out as a general outline only for guidance of intending purchasers or lessees, and do not constitute nor constitute part of, an offer or contract. 2. All descriptions, dimensions, references to condition and necessary permissions for use and occupation, and other details are given without responsibility and any intending purchasers or tenants should not rely on them as statements or representations of fact but must satisfy themselves by inspection or otherwise as to the correctness of each of them. 3. No person in the employment of Messrs. Aldreds has any authority to make or give any representation or warranty whatever in relation to this property. 4. If you are proposing to visit the property and are travelling some distance please check with Aldreds on the issue of availability prior to travelling. 5. Aldreds Property Consultants and associated services may offer additional services to the prospective purchaser for which they will be entitled to receive a commission.

Aldreds are pleased to be working with Mortgage Advice Bureau. They're an award-winning mortgage broker with over 1,400 advisers across the UK, and have access to over 12,000 mortgage products from over 90 lenders. Aldreds Estate Agents Ltd receive a commission of £200 on each completed case. Your home may be repossessed if you do not keep up repayments on your mortgage. There may be a fee for mortgage advice. The actual amount you pay will depend upon your circumstances. The fee is up to 1%, but a typical fee is 0.3% of the amount borrowed. Mortgage Advice Bureau is a trading name of Mortgage Seeker Limited which is an appointed representative of Mortgage Advice Bureau Limited and Mortgage Advice Bureau (Derby) Limited which are authorised and regulated by the Financial Conduct Authority. Mortgage Seeker Limited Registered Office: Lovewell Blake, Sixty Six North Quay, Great Yarmouth, Norfolk, NR30 1HE. Registered in England Number: 03721415. 6. Potential purchasers should check with their providers that the broadband and mobile phone coverage they would require is available.

Energy Efficiency Graph

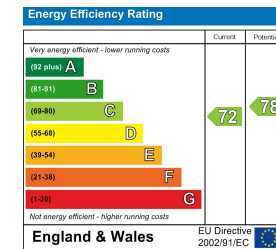

149 High Street, Gorleston, Norfolk, NR31 6RB

Tel: 01493 664600 Email: gorleston@aldreds.co.uk <https://www.aldreds.co.uk/>

Registered in England Reg. No. 08945751 Registered Office: 17 Hall Quay, Great Yarmouth, Norfolk NR30 1HJ

Directors: Mark Duffield B.S.c. FRICS. Dan Crawley MNAEA Paul Lambert MNAEA