

47 Comfrey Way - Offers In The Region Of £240,000

Thetford Norfolk IP24 2UU

chilterns

Estate & Letting Agents



"Consistently providing outstanding service to our clients"

Offers In The Region Of £240,000

The Property

Chilterns are pleased to launch to the market this three bedroom end of terrace house which we believe would make an ideal family home. Tucked away within a cul-de-sac on the ever popular Cloverfields development, this property is offered to the market with no onward chain and presents an excellent opportunity for families and investors alike.

The property is within easy reach of Thetford's wide range of amenities, including supermarkets, primary & secondary schools and excellent transport links.

Internally, the accommodation is well presented throughout. A welcoming entrance hall with doors leading to the downstairs cloakroom, lounge/diner and kitchen. Beyond the lounge/diner there is a conservatory which is an added benefit.

To the first floor, the property continues to impress with three well proportioned bedrooms and a modern family bathroom, completing the internal accommodation.

Externally, the home benefits from off road parking, a single garage and a fully enclosed rear garden.

AGENTS NOTE

Please be aware that images of the property may have been digitally enhanced, edited, or staged using artificial intelligence, and may not reflect the current presentation or furnishings.

Features

- **POPULAR CLOVERFIELDS DEVELOPMENT**
- **WITHIN EASY REACH OF A11**
- **GREAT CONDITION THROUGHOUT**
- **FAMILY HOME**
- **THREE BEDROOM END OF TERRACED HOUSE**
- **CONSERVATORY ADDITION**
- **DOWNSTAIRS CLOAKROOM**
- **FULLY ENCLOSED REAR GARDEN**
- **OFF ROAD PARKING & SINGLE GARAGE**
- **OFFERED FOR SALE WITH NO ONWARD CHAIN!**





These sales particulars have been produced as a general guide only and we would draw to your attention that we have not carried out a detailed Survey of the property nor have we tested services, appliances or specific fittings. Whilst measurements and statements given within the details are provided in good faith, their accuracy should not be relied upon. If there are any points about which you may be uncertain or would like further clarification, we would suggest that you telephone this office and speak to our staff who will endeavour to assist you.

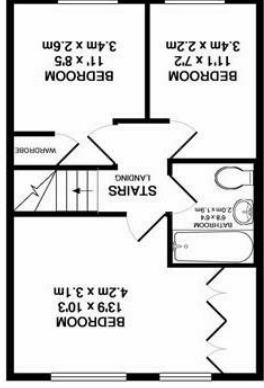

GROUND FLOOR
 APPROX. FLOOR AREA 606 SQ.FT. (56.3 SQ.M.)

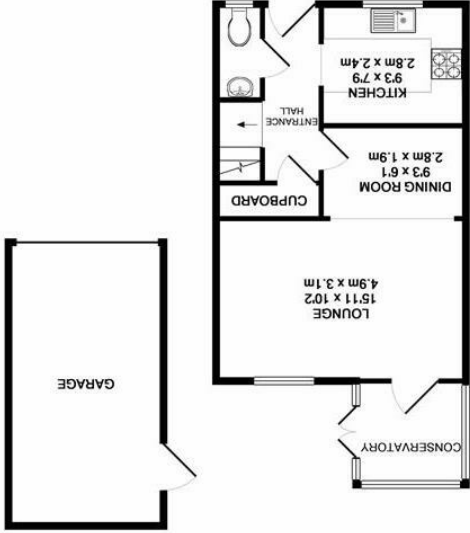

14 Bridge Street, Thetford, Norfolk, IP24 3AA
 T: 01842 754161
 E: thetford@chilternsestateagents.co.uk