

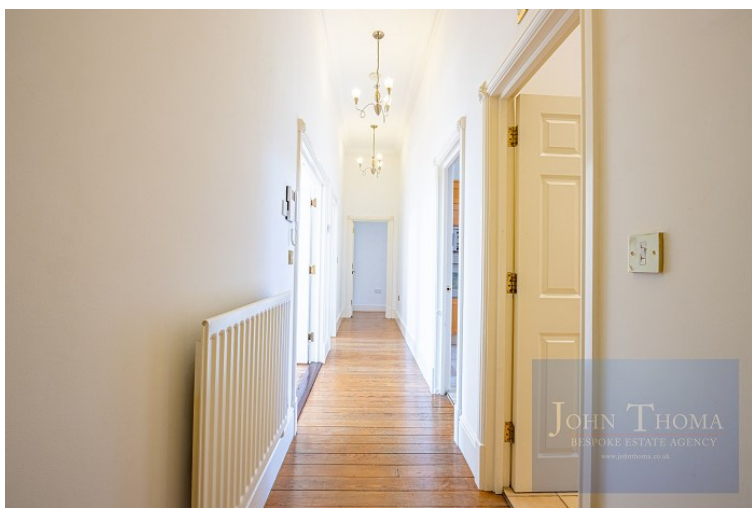

A stunning spacious two double bedroom first-top floor apartment in the amazing and picturesque gated development of Repton Park just off Manor Road, Chigwell.

Wentworth House is one of the original buildings in Repton Park and offers high ceilings with ornate covings, tall sash windows and the original flooring throughout.

Wentworth House, Repton Park



- ◆ OFFERED CHAIN FREE
- ◆ STUNNING FIRST / TOP FLOOR APARTMENT WITH A SPACIOUS LOUNGE MEASURING 16' x 14' 1"
- ◆ LOCATED IN THE GATED DEVELOPMENT OF REPTON PARK WITH ACRES OF LANDSCAPED GROUNDS
- ◆ THIS AMAZING APARTMENT HAS HIGH CEILINGS AND TALL SASH WINDOWS
- ◆ A WELL-PROPORTIONED FITTED KITCHEN BREAKFAST ROOM MEASURING 10' 9" x 10'

- ◆ THE MASTER BEDROOM MEASURES 14' x 11' 9" WITH A FITTED DEEP WARDROBE AND EN-SUITE SHOWER ROOM
- ◆ BEDROOM TWO MEASURES 14' 1" x 10' WITH A LARGE SASH WINDOW
- ◆ A WELL-PROPORTIONED BATHROOM WITH A WHITE SUITE
- ◆ THIS APARTMENT HAS TWO ALLOCATED PARKING SPACES AND ADDITIONAL VISITORS PARKING

Floor Plan

Approx. 81.9 sq. metres (881.2 sq. feet)

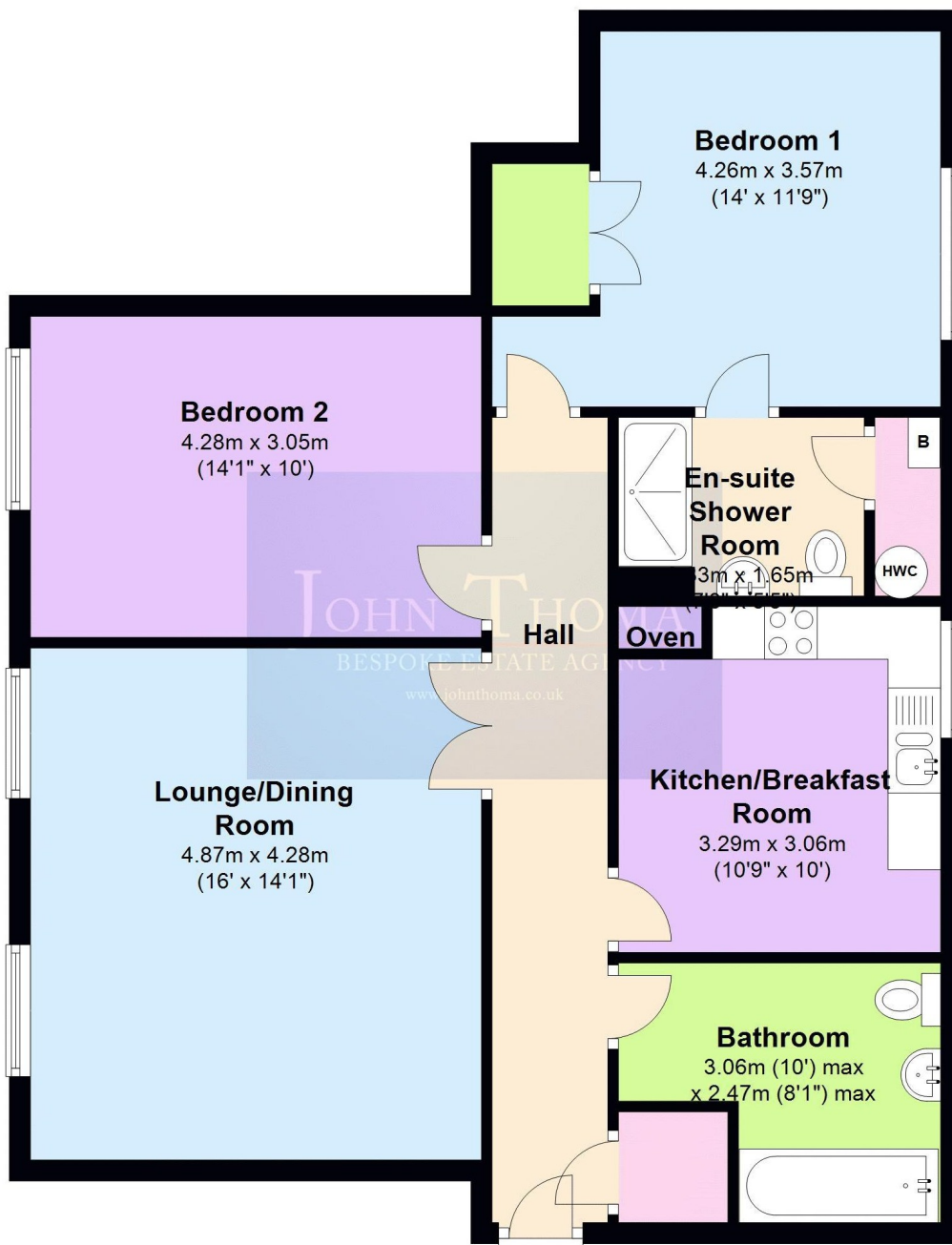

Total area: approx. 81.9 sq. metres (881.2 sq. feet)

| Score | Energy rating | Current | Potential |
|-------|---------------|---------|-----------|
| 92+ | A | | |
| 81-91 | B | | |
| 69-80 | C | 74 C | 77 C |
| 55-68 | D | | |
| 39-54 | E | | |
| 21-38 | F | | |
| 1-20 | G | | |

[John Thoma Bespoke Estate Agency, Chigwell Branch](#)

The Coach House 201 High Road Chigwell Essex IG7 5BJ
020 8340 8833 Local call rate