



£1,500 pcm
Charcot Road, Colindale



1

Bedroom



1

Bathroom

211 Edgware Rd, London, NW9 6LP |
colindale@warrenbradleystates.co.uk

020 8200 7007

£1,500 pcm
Charcot Road, Colindale



Warren Bradley Estates are pleased to offer for rent this spacious studio/ 1 bedroom apartment with a seperate bedroom.

Located on the fourth floor with lift access, this property is situated in the popular Pulse Development, close to Colindale tube station.

Benefitting from a large separate sleeping area, fully fitted kitchen with fridge/freezer, washing machine, oven and dishwasher, a fully tiled bathroom double glazing and an allocated parking space.

Offered furnished the property is available from 06/06/26



Crawford Court

Approx. 34.6 sq. metres (372.9 sq. feet)

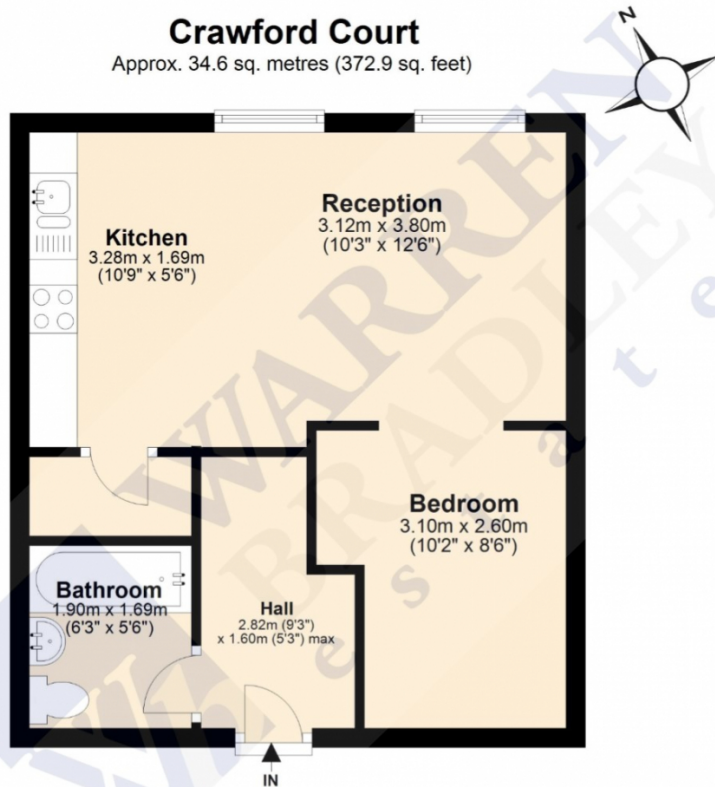

Disclaimer: Please note this floor plan is for marketing purposes and is to be used as a guide only.
Plan produced using PlanUp.

Energy Efficiency Rating		Current	Potential
Very energy efficient - lower running costs			
(92-100) A			
(81-91) B		83	83
(69-80) C			
(55-68) D			
(39-54) E			
(21-38) F			
(1-20) G			
Not energy efficient - higher running costs			
England, Scotland & Wales		EU Directive 2002/91/EC	

Environmental Impact (CO ₂) Rating		Current	Potential
Very environmentally friendly - lower CO ₂ emissions			
(92-100) A		97	97
(81-91) B			
(69-80) C			
(55-68) D			
(39-54) E			
(21-38) F			
(1-20) G			
Not environmentally friendly - higher CO ₂ emissions			
England, Scotland & Wales		EU Directive 2002/91/EC	

