



63 Stein Road, Southbourne,
Emsworth PO10 8LE



OFFERED WITH NO FORWARD CHAIN.... Three Bedroom, Semi-detached Bungalow in the popular West Sussex village of Southbourne, conveniently located close to local shops, schools and with easy access to road, rail and bus links.

The accommodation comprises: Entrance Hall, Bedroom One, Bedroom Two, Bathroom, Kitchen, Sitting/Dining Room, Bedroom Three/Study. Externally the property benefits from off road parking for multiple cars, a Garage and a private enclosed West-facing Garden, mainly laid to lawn with patio area and mature shrubs.

- SEMI DETACHED BUNGALOW
- THREE BEDROOMS
- SITTING/DINING ROOM
- WELL PRESENTED
- WEST-FACING GARDEN
- GARAGE AND AMPLE OFF ROAD PARKING
- CLOSE TO SCHOOLS, SHOPS AND TRANSPORT LINKS
- REQUESTED SOUTHBOURNE LOCATION

Asking Price
£335,000
Freehold





ACCOMMODATION

- Entrance Hall
- Bedroom One
- Bedroom two
- Bathroom
- Kitchen
- Sitting/Dining Room
- Bedroom Three/Study



External:

- Off-road parking
- Garage
- West Facing Garden

EPC: D

Council Tax: C





LOGIK



Biscuits

Coffee

Sugar

Tea

Miele

Blomberg

LOCATION

LOCATION: This property is situated within easy reach of local Shops, Schools, Pub, Church, Dentist/Doctors surgeries. There is a nearby local Farm Shop with weekly fishmonger stall. To the south is Chichester Harbour, A National Landscape (formerly AONB), with access to the water via a public slipway at nearby Prinsted and footpath from Southbourne Village.

Southbourne nestles between the South Downs National Park, with its country pursuits, and Chichester Harbour, favoured for its water pursuits. It is well placed for easy access to the Cathedral City of Chichester by both rail (Southbourne has its own halt) and road links. There are also excellent transport links with its local bus service and nearby railway station on the South Coast Line with routes to London & South Coast cities.





63, Stein Road, PO10 8LE

Approximate Gross Internal Area = 77.0 sq m / 829 sq ft
Garage = 13.0 sq m / 140 sq ft
Total = 90.0 sq m / 969 sq ft

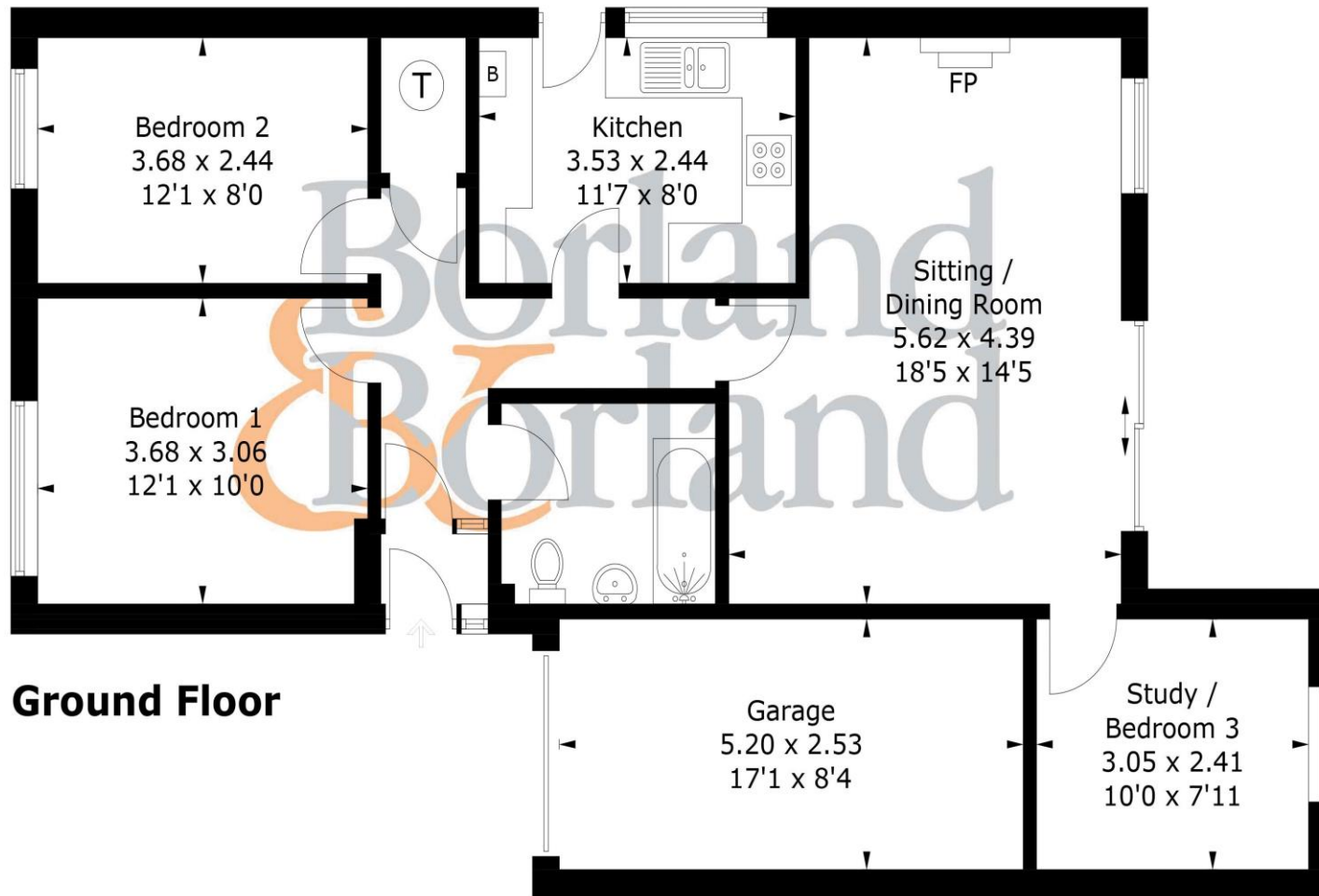

Ground Floor

PRODUCED FOR BORLAND & BORLAND ESTATE AGENTS

Whilst every attempt has been made to ensure the accuracy of the floorplan, measurements of doors, windows and rooms are approximate. These plans are for representation purposes only as defined by RICS Code of Measuring Practice and used as such by any prospective purchaser. (ID1277731)



Directions

SAT NAV: PO10 8LE

‘IMPORTANT NOTICE Borland & Borland gives notice that: 1. These particulars do not constitute an offer or contract or part thereof. 2. All descriptions, photographs and plans are for guidance only and should not be relied upon as statements or representations of fact. All measurements are approximate and not necessarily to scale. Any prospective purchaser must satisfy themselves of the correctness of the information with the particulars by inspection or otherwise. 3. Borland & Borland does not have any authority to give any representations or warranties whatsoever in relation to this property (including but not limited to planning/building regulations), nor can it enter into any contract on behalf of the Vendor. 4. Borland & Borland does not accept responsibility for any expenses incurred by prospective purchasers in inspecting properties which have been sold, let or withdrawn. 5. If there is anything of particular importance to you, please contact this office and Borland & Borland will try to have the information checked for you.

9a High Street, Emsworth, Hampshire PO10 7AQ

Tel: 01243 377655

property@borlandandborland.co.uk

www.borlandandborland.co.uk

rightmove

naea | propertymark
PROTECTED