



**Taylors**



# Webb Court, Drury Lane, Stourbridge, DY8 1BN

🛏 2 🍽 1 🛋 1





A beautifully presented two-bedroom apartment, located within a popular purpose-built retirement development for those aged 60 and over, ideally positioned close to local amenities. Offered for sale with no upward chain, the property boasts a thoughtfully designed layout, stylish finish throughout, and is ideally located close to the lift for added convenience.

The accommodation includes a welcoming reception hall, a spacious sitting room enhanced by a dual aspect window that fills the room with natural light, and a well-fitted kitchen. There are two well proportioned bedrooms, with one benefiting from fitted wardrobes. A modern fitted shower room adds a contemporary and practical touch to the home.

Residents of Webb Court enjoy a comfortable and secure lifestyle, with access to a sociable residents' lounge, a convenient laundry room, the reassurance of an on-site house manager, and a 24-hour emergency pull cord system for peace of mind. Resident and visitor parking is available on a first-come, first-served basis.

Tenure: Leasehold. Lease: 125 years from 1 November 2005, Service Charge: £5089, Ground Rent: £460, Construction: Purpose Built. Services: All mains (no gas). Broadband/Mobile coverage: Visit: [checker.ofcom.org.uk/en-gb/broadband-coverage](http://checker.ofcom.org.uk/en-gb/broadband-coverage). Council Tax Band D. EPC B.

**Entrance Hall** - 2.74m x 2.16m (9'0" x 7'1") At widest points

**Living Room** - 5.26m x 3.38m (17'3" x 11'1")

**Kitchen** - 2.67m x 1.7m (8'9" x 5'7") At widest points

**Shower Room** - 2.13m x 1.65m (7'0" x 5'5") At widest points

**Bedroom One** - 4.06m x 2.62m (13'4" x 8'7") At widest points

**Bedroom Two** - 3.53m x 2.77m (11'7" x 9'1")





- NO UPWARD CHAIN
- TWO BEDROOMS
- DUAL ASPECT WINDOW TO LIVING ROOM
- MODERN FITTED SHOWER ROOM
- CONVENIENTLY LOCATED CLOSE TO THE LIFT
- SUITABLE FOR THOSE AGED 60 AND OVER

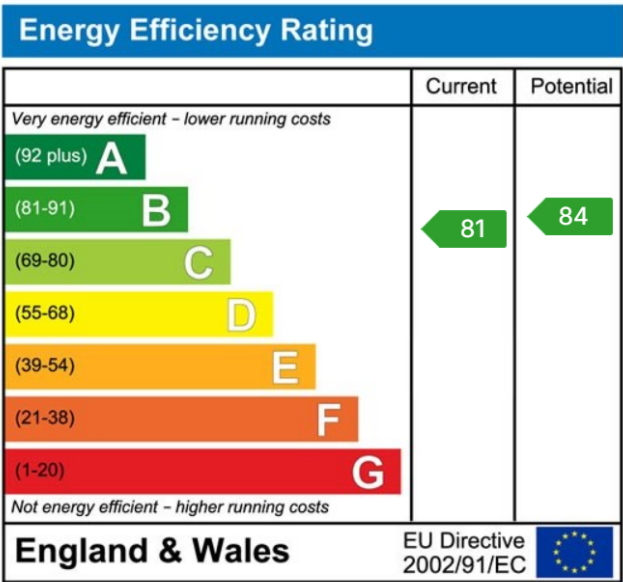
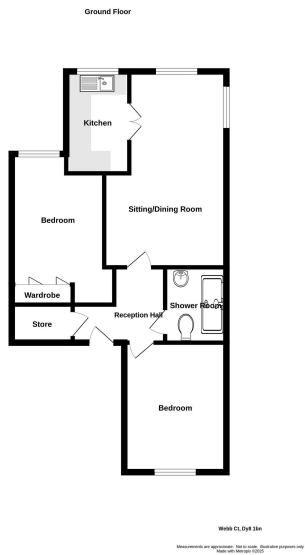

**MISREPRESENTATION ACT 1967:** These particulars do not constitute any part of an offer or a contract. Whilst every care is taken to ensure accuracy, no responsibility for errors or misdescription is accepted. Any intending purchaser must satisfy themselves by inspection or otherwise as to the correctness of each of the statements in these particulars. The vendor does not make nor give, and neither Taylors nor any person in their employment has any authority to make or give any representation or warranty whatsoever about this property. As the seller's estate agents, we are not surveyors or conveyancing experts, and we cannot comment on the property's condition or issues relating to the title or other legal issues that may affect this property unless we have been made aware of such matters. Interested parties should employ professionals to make such enquiries before making transactional decisions. **EPC:** can be supplied free of charge. **CONSUMER PROTECTION REGULATIONS (2008):** These particulars have been prepared with care and approved by the vendors (where possible) but are intended as a guide only, with measurements being approximate and usually the maximum size, which may include alcoves, recesses or otherwise as described, and you must NOT rely on them for any other purpose. The appearance of an item in any photograph does not mean that it forms part of the property or sale price. **FIXTURES AND FITTINGS:** Only those items specifically mentioned in these sales particulars are included in the sale price. Taylors have NOT tested any apparatus, equipment, fixture or fitting and cannot verify they are in working order or fit for their purpose. **PLANNING PERMISSION / BUILDING REGULATIONS:** Any reference to the property being extended, altered or converted in any way does not infer that planning permission or building regulations have been granted or applied for, nor do Taylors accept any responsibility for such not having been obtained. **FLOOR PLAN:** This plan is for illustrative purposes only. The services, systems and appliances shown have not been tested and no guarantee as to their operability or efficiency can be given.