



**Millfields Road, E5**

**£1,250,000**

**Dexters**



## Millfields Road, E5

A three bedroom Victorian end of terrace, measuring over 1,850 sq ft, with a south facing garden in Lower Clapton. Available for the first time in 40 years the home offers a buyer renovation and extension potential with a converted garage, loft space, grand proportions and period features retained. It is being sold chain free.

Entering on Rushmore Road the L-shaped home offers a grand double reception room with sliding doors onto the private well kept garden. The kitchen has room to dine and the garage has been converted into a study & utility room with skylights, separate W/C and storage space. Upstairs has three larger than average bedrooms and family bathroom. There are four feature fireplaces throughout and loft space.

Only half a mile from Millfields Park, Hackney Downs and Hackney Marshes, the home is surrounded by green spaces offering many opportunities for outdoor recreation. It is within the catchment area of many 'Outstanding' primary and secondary schools and also in walking distance to the independent shops, cafés, weekend market of Chatsworth Road and Lower Clapton Road. Clapton Overground is half a mile away offering direct trains into the transport hub Liverpool Street and there are numerous bus links on Lower Clapton Road providing excellent transport links.

### Features

- Victorian End of Terrace
- Three Bedrooms
- Renovation Potential
- South Facing Garden
- Converted Garage Space
- Chain Free







# Millfields Road, London, E5

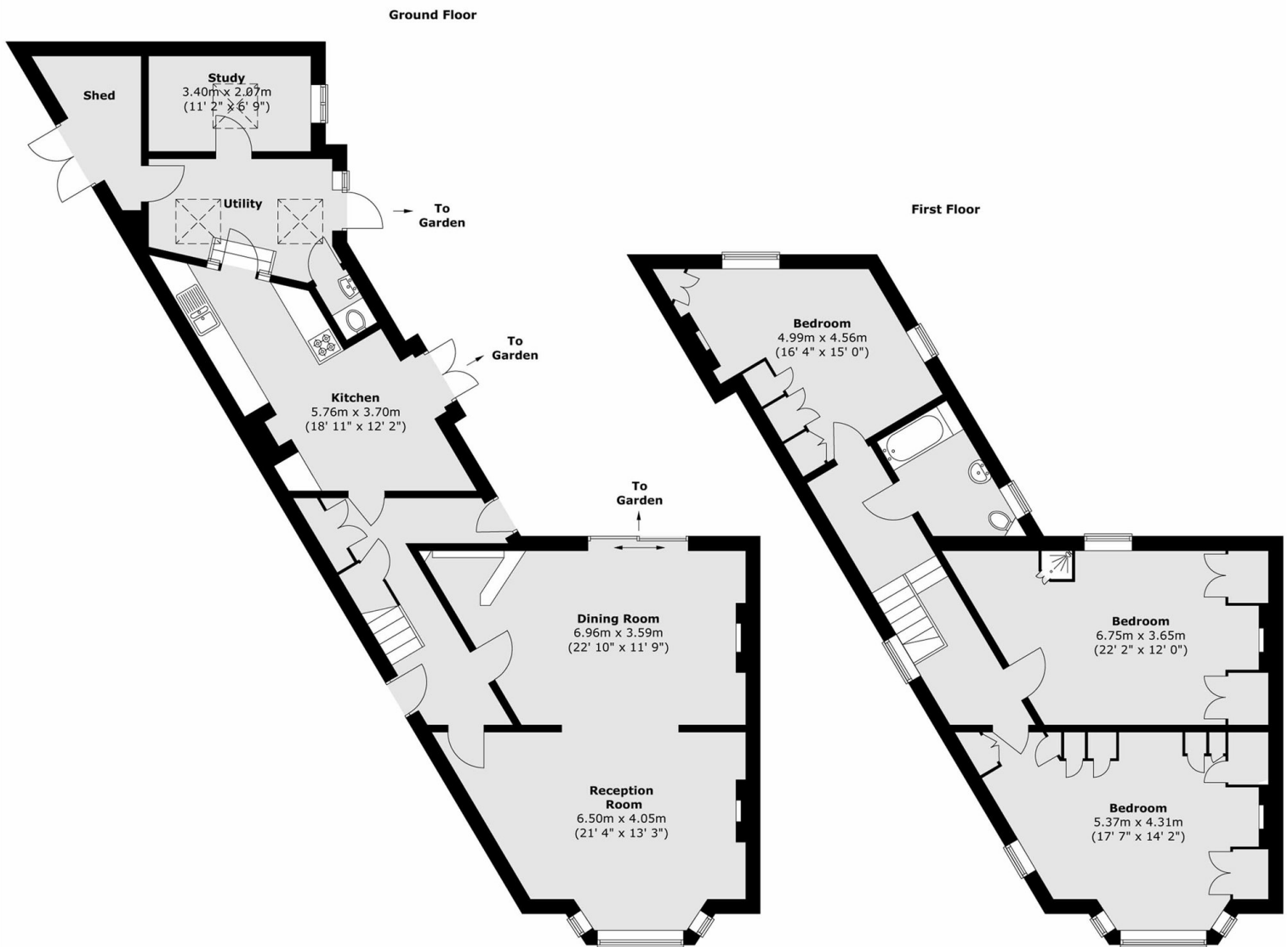

Total area (approx.) : 172.2 sq. m (1854 sq. ft)