



Webbs  
Helping people move since 1994

**Belt Road | Hednesford, Cannock | WS12 4JJ**

**Offers Invited £280,000**

 **Webbs**  
estate agents



# Summary

\*\* TRADITIONAL DOUBLE FRONTED DETACHED BUNGALOW \*\* THREE BEDROOMS \*\* TWO RECEPTION ROOMS \*\* SUNROOM \*\* SUPERBLY PROPORTIONED \*\* DETACHED GARAGE \*\* LARGE GARDEN \*\*

WEBBS ESTATE AGENTS are delighted to welcome to market the deceptively spacious Belt Road a majestic three bed detached bungalow . This stunning bungalow sits on Belt road just outside of Hednesford town. There is a plethora of space having two reception rooms , Sun Room, three great sized bedrooms, kitchen and bathroom . Belt Road is oozing potential, boasting double rooms and some traditional features .

## EXTERNALLY

The drive has ample parking with side access leading to a large detached garage . The well established garden is a good size which has potential for extensions or for gardening enthusiasts. The location is perfect been just outside Hednesford a small vibrant bustling market town . All good school all within walking distance . The local transport links are all with easy reach as well as the Hednesford train station with a direct link to Birmingham City .

# Key Features

- TRADITIONAL DETACHED BUNGALOW
- TWO RECEPTION ROOMS
- SUN ROOM
- CLOSE TO ALL LOCAL AMENITIES
- THREE BEDROOMS
- DETACHED GARAGE
- GREAT SIZED REAR GARDEN
- SEVERAL VEHICLES

# Rooms and Dimensions

## ENTRANCE HALLWAY

16'0" x 4'6" (4.883 x 1.384)

## LOUNGE

16'2" x 11'10" (4.94 x 3.609)

## DINING ROOM

11'5" x 11'5" (3.505 x 3.501)

## SUNROOM

8'8" x 8'7" (2.656 x 2.624)

## MASTER BEDROOM

10'10" 14'8" (3.319 4.483)

## BEDROOM TWO

10'4" x 10'11" (3.167 x 3.329)

## BEDROOM THREE

14'6" x 6'9" (4.444 x 2.074)

## FAMILY BATHROOM

## EXTERNALLY

## GREAT SIZED ENCLOSED REAR GARDEN

## DRIVE FOR SEVERAL VEHICLES

## DETACHED GARAGE

24'0" x .108'3" (7.317 x .033)

## IDENTIFICATION CHECKS - C







Webbs  
Helping people move since 1994



Webbs  
Helping people move since 1994



Webbs  
Helping people move since 1994



Webbs  
Helping people move since 1994



Webbs  
Helping people move since 1994



Webbs  
Helping people move since 1994

# GROUND FLOOR

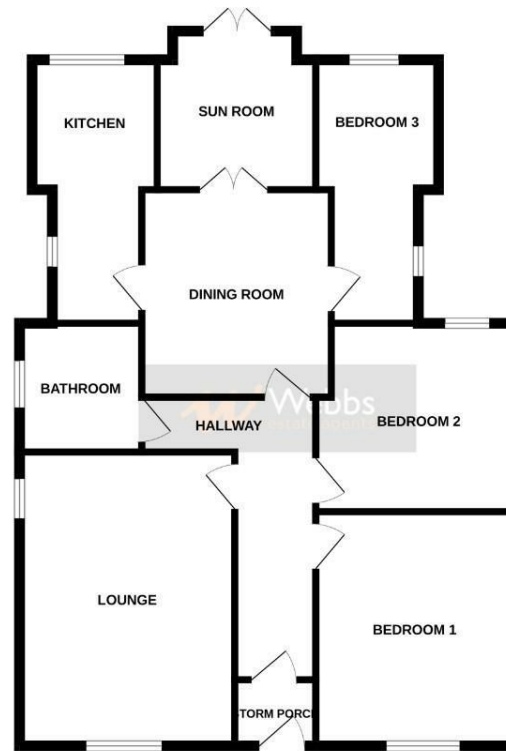

Whilst every attempt has been made to ensure the accuracy of the floorplan contained here, measurements of doors, windows, rooms and any other items are approximate and no responsibility is taken for any error, omission or mis-statement. This plan is for illustrative purposes only and should be used as such by any prospective purchaser. The services, systems and appliances shown have not been tested and no guarantee as to their operability or efficiency can be given.  
Made with floorplan 6/2025

Webbs Estate Agents - endeavour to maintain accurate depictions of properties in Virtual Tours, Floor Plans and descriptions, however, these are intended only as a guide and purchasers must satisfy themselves by personal inspection.

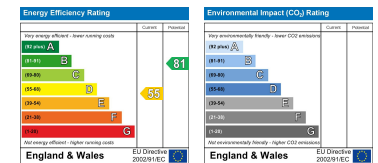

153 Avon Road, Cannock, WS11 1LF

Tel: 01543 468846 | Email: [sales@webbestateagents.co.uk](mailto:sales@webbestateagents.co.uk) | [www.webbestateagents.co.uk](http://www.webbestateagents.co.uk)

