



Victoria Court, Whitefield, Manchester

Price £149,950

Ascend
Built on higher standards

Entrance Hallway

From the communal hall and landing - Front entrance door, wood effect laminate flooring, doors through to all room. Built in storage cupboard. Radiator.

Open Plan Living Room & Kitchen

Furnished with a range of fitted wall mounted and base level units with work top surfaces over incorporating a breakfast bar. Stainless steel sink and drainer unit with mixer tap. Fitted electric oven and grill with a four ring ceramic hob and an extractor hood over. Space for an automatic washing machine, space for a fridge freezer. Tiled splashback, Double glazed window.

The living room area features the continuation of the wood effect laminate flooring. a double glazed window and overhead skylight, feature internal window into hallway and radiators.

Bedroom One

Continuation of the wood effect laminate flooring, double glazed window, radiator. Door to the jack and jill bathroom.

Jack & Jill Bathroom

Furnished with a four piece suite comprising panelled bath, walk in shower enclosure, pedestal wash hand basin and a low level WC.

Bedroom Two

Continuation of the wood effect laminate flooring, double glazed window and radiator.

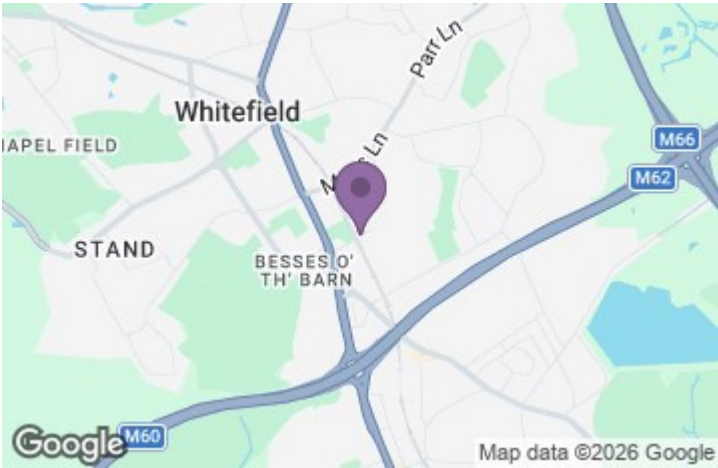

2ND FLOOR
608 sq.ft. (56.5 sq.m.) approx.

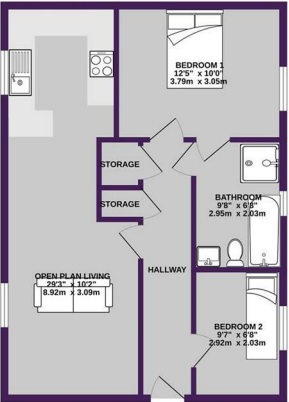

TOTAL FLOOR AREA: 608 sq.ft. (56.5 sq.m.) approx.
While every effort has been made to ensure the accuracy of the information contained herein, Ascend Properties Limited does not accept any liability for any errors or omissions. The information is provided for general guidance only and should not be used as a basis for any financial or other decisions. The actual floor area may vary slightly from the approximate figures given. Ascend Properties Limited 2026

