



📍 6 The Thorns, Marlborough, Wiltshire, SN8 1DY

🔗 £995 PCM

- Mid-Terrace House
- Walking Distance to Town
- Close to Countryside
- Two Bedrooms
- Well Presented
- Garden and Parking
- Council Tax Band: C
- Available Early July



🏠 EPC Rating C



Well presented two bedroom house tucked away in a quiet cul de sac location on the edge of town within walking distance to Marlborough High Street. Accommodation comprises an entrance porch with built in storage, a sitting room, kitchen/diner with electric cooker, two bedrooms and bathroom with underfloor heating and shower over bath. Further benefits include UPVC double glazed windows and a gas fired central heating system. There is one allocated parking space (further unrestricted on road parking), a small front garden and a south-facing rear garden. Available Early July unfurnished, £995pcm



Ground Floor

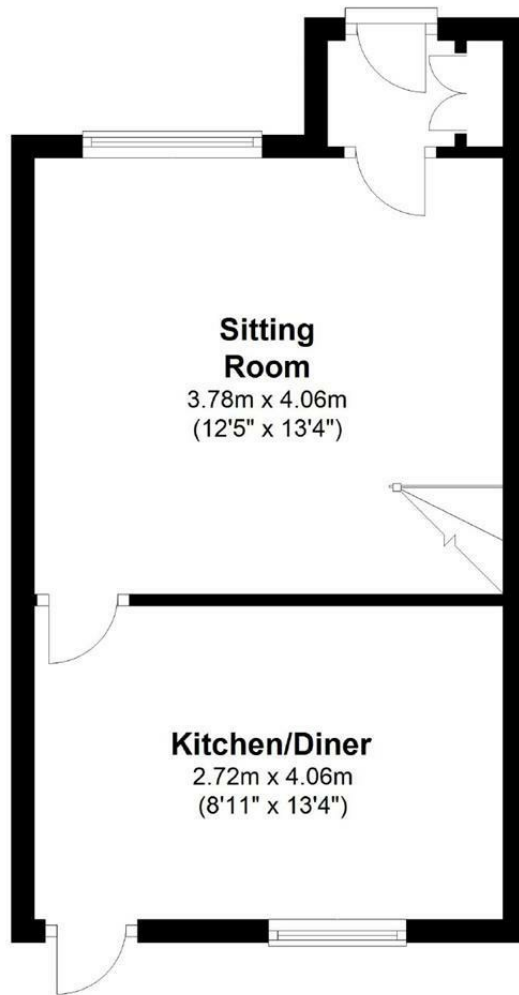

First Floor

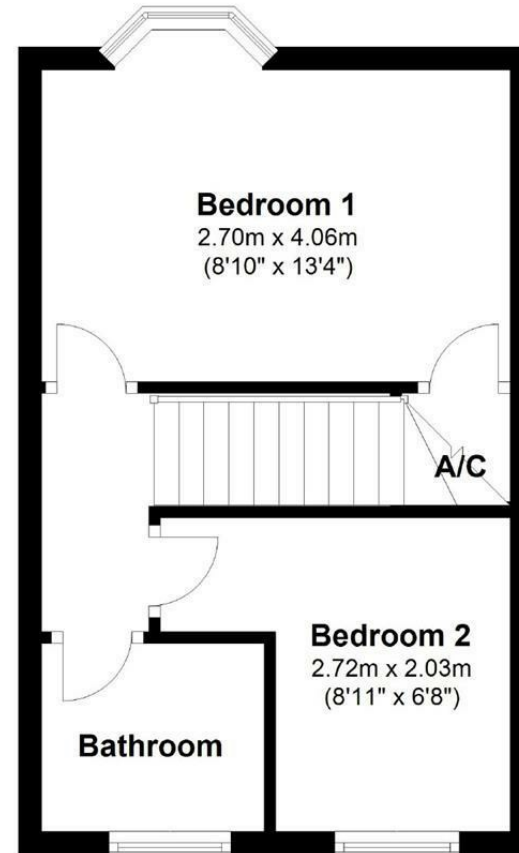

Disclaimer These particulars, whilst believed to be accurate are set out as a general outline only for guidance and do not constitute any part of an offer or contract. Intending purchasers should not rely on them as statements of representation of fact, but must satisfy themselves by inspection or otherwise as to their accuracy. No person in this firm's employment has the authority to make or give any representation or warranty in respect of the property. All measurements and distances are approximate only. Your home is at risk if you do not keep up repayments on a mortgage or other loan secured on it.