



Claremont Grove, W4

£461 Per week

A well presented two bedroom apartment in a purpose-built block. The property offers an open-plan kitchen-reception room, direct access to communal gardens and near the river.

Located within a mile from Chiswick mainline station which has frequent services to Waterloo, local bus links and right next to the River Thames.

Features

- Two Bedroom
- Close To Riverside
- Close To Transport
- Direct Access To Shared Garden
- Allocated Parking
- Good Condition

Claremont Grove,
London, W4

Ground Floor

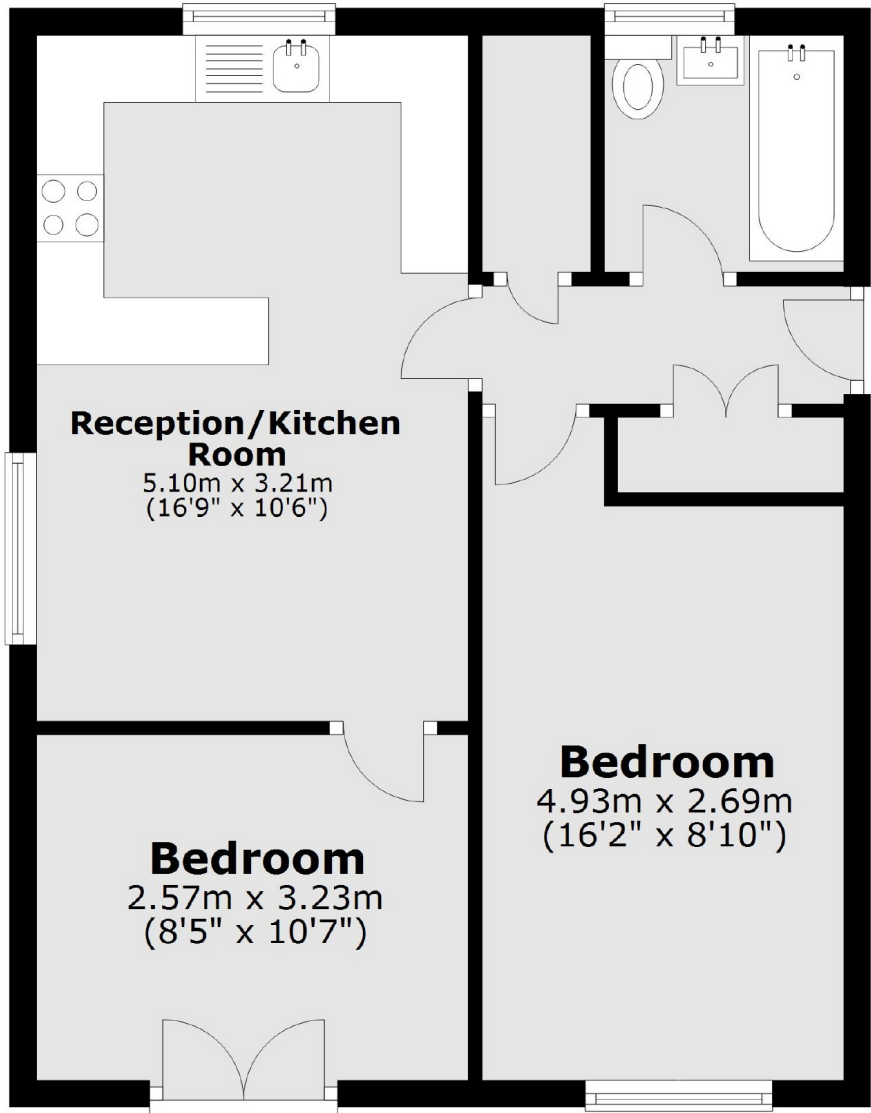

Total area: approx. 46.8 sq. metres (504.2 sq. feet)