



11 Manor Park Avenue, Portsmouth

Offers in Region of £220,000





11 Manor Park Avenue

Portsmouth

Step inside this inviting two-bedroom terraced house, an ideal starter home for those looking to step onto the property ladder or enjoy a comfortable, low-maintenance lifestyle. The open-plan kitchen and dining area forms the heart of the home, offering a bright and sociable space for everyday living. Upstairs, two well-proportioned bedrooms provide flexibility for sleeping, working from home, or creative use, alongside a modern and practical family bathroom.

Outside, the private west-facing garden is a real highlight, enjoying afternoon and evening sun—perfect for relaxing, entertaining, or summer barbecues. The space is both manageable and versatile, suiting a range of lifestyles.

With no onward chain, this home is ready for a smooth move. Conveniently located close to local shops, schools, and amenities, it offers everything you need within easy reach.

Material Information • Tenure: Freehold • Council Tax: Band B • Electricity: Mains Supply • Heating: Gas • Water Supply: Mains Supply • Sewage: Mains Supply • Broadband: Standard, Superfast and Ultrafast Fibre are all available in this area • Parking: On Street • Mobile: Ofcom official website checker states that EE, Vodafone, O2 and Three available in the area • Flood Risk: Low Risk





Ground Floor

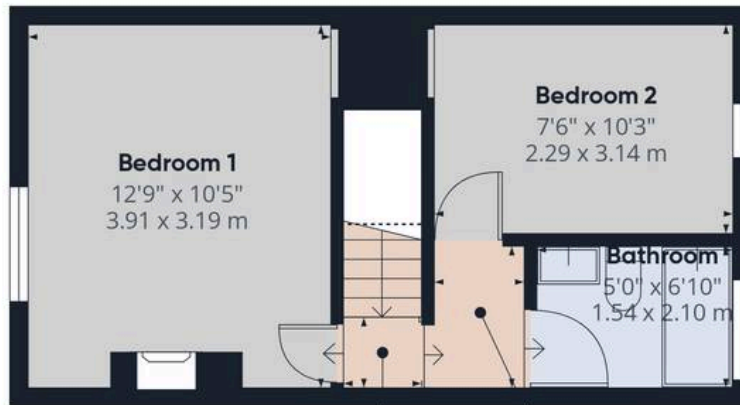

Floor 1



Approximate total area⁽¹⁾

795 ft²

73.7 m²

(1) Excluding balconies and terraces

Reduced headroom

----- Below 5 ft/1.5 m

Calculations reference the RICS IPMS 3C standard. Measurements are approximate and not to scale. This floor plan is intended for illustration only.

GIRAFFE 360

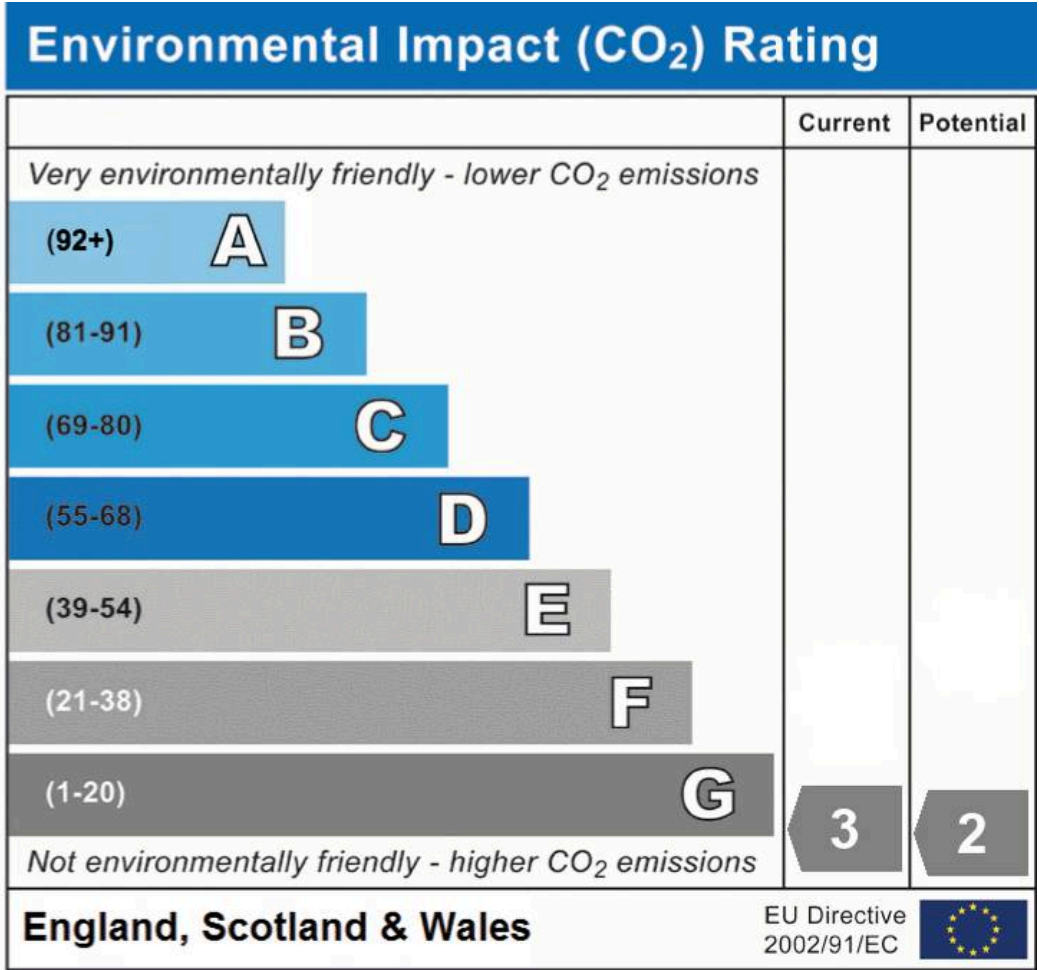
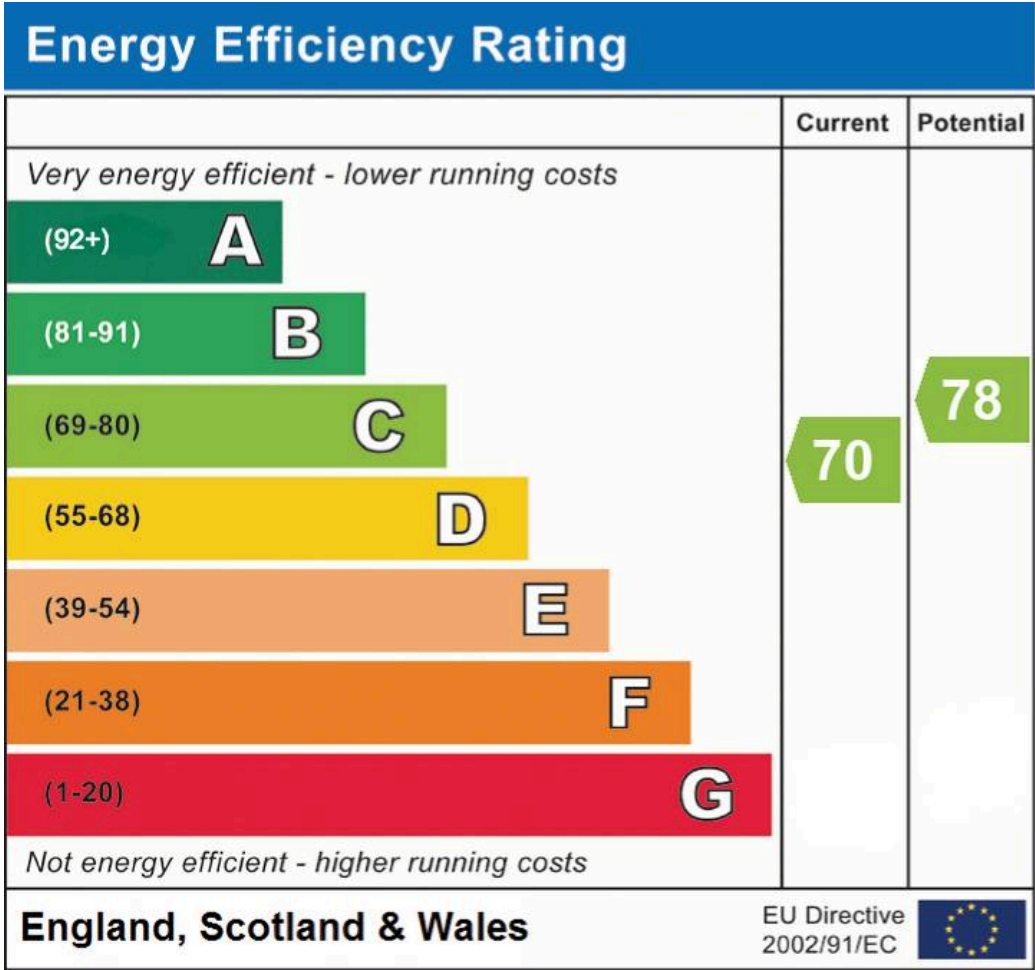

Chinneck Shaw

Bridge House, Milton Road, Portsmouth – PO3 6AN

023 9282 6731

hello@chinneckshaw.co.uk

www.chinneckshaw.co.uk/

Chinneck Shaw, Bridge House, Milton Road, PO3 6AN Consumer Protection from Unfair Trading Regulations 2008: These details are for guidance only and complete accuracy cannot be guaranteed. If there is any point which is of particular importance, verification should be obtained. They do not constitute a contract or part of a contract. All measurements are approximate. No guarantee can be given with regard to planning permissions or fitness for purpose. No apparatus, equipment, fixture or fitting has been tested. Items shown in the photographs are NOT necessarily included. Interested Parties are advised to check availability and make an appointment to view before travelling to see a property.