



Aylestone Avenue, NW6

TO LET - £3,100 Per Month

AVAILABLE TO LET NOW AND OFFERED UNFURNISHED is this bright and spacious three bedroom apartment, set on the Ground Floor of this imposing detached property on the prestigious and highly sought after Aylestone Avenue.

The property covers 871 sq ft of internal accommodation and boasts a large bay fronted reception room followed by a modern eat-in kitchen/diner and three-piece bathroom suite. There are also two double bedrooms, access to communal gardens and off-street parking available on a first-come basis.

Aylestone Avenue is ideally located to access the amenities of Willesden Green as well as a wonderful array of shops, delis, restaurants & bars in Kensal Rise & Queen's Park. The open space of Tiverton Green is also nearby. Transport links via Brondesbury Park (Mildmay- Zone 2) and Queens Park (Bakerloo & Lioness- Zone 2), offer quick access into Central London. Viewing is highly recommended.



020 8450 9377

rentals@cameronsstiff.co.uk

cameronsstiff.co.uk

Aylestone Avenue, NW6

Approximate Area = 80.9 sq m / 871 sq ft

For Identification only - Not to Scale

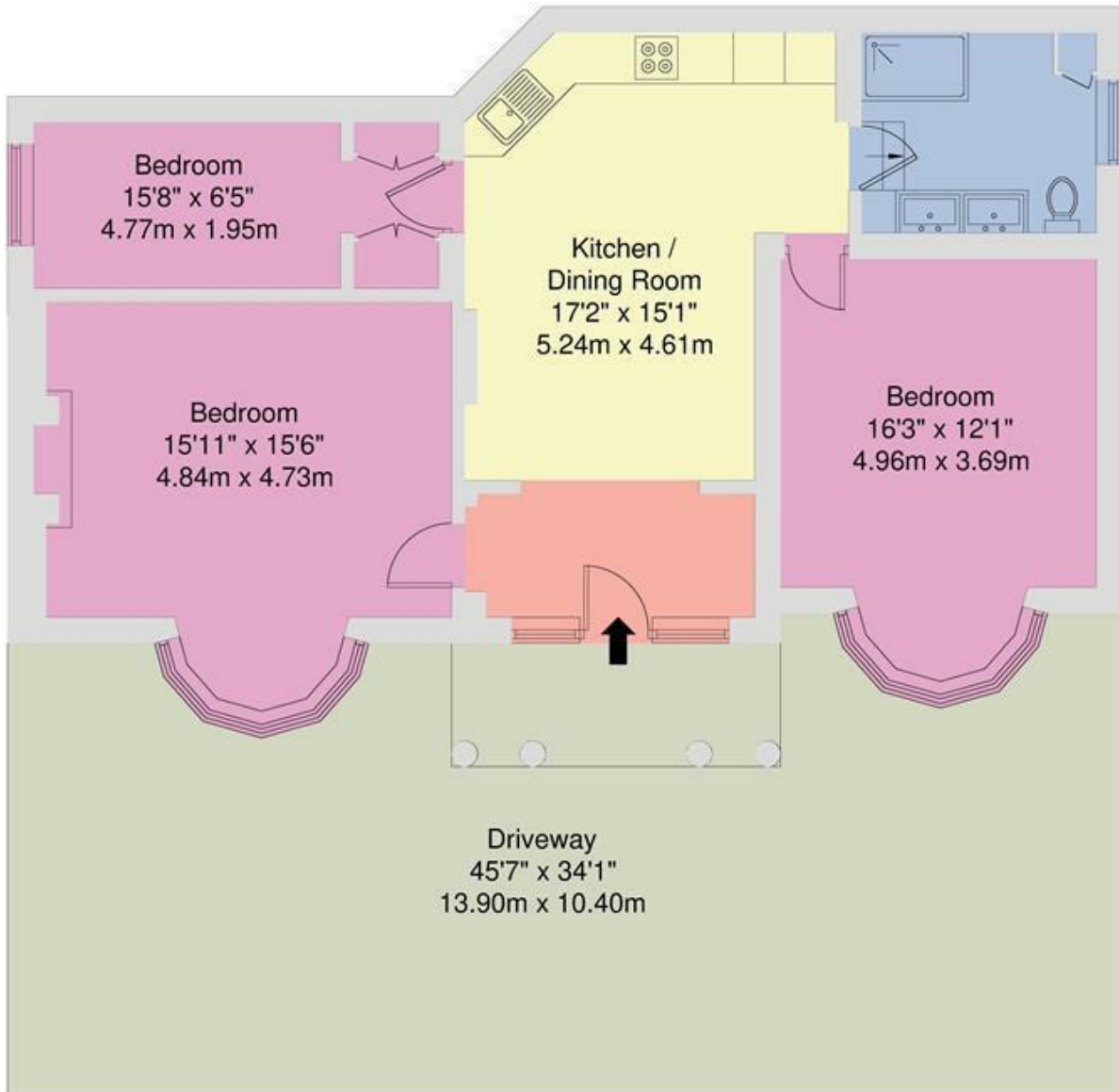

GROUND FLOOR

EPC: D
Ref: 16548886

Disclaimer: Floorplan produced in accordance with RICS guidelines. While we do not doubt the floorplan accuracy and completeness, you or your advisors should conduct a careful, independent investigation of the property in respect of monetary valuation. Produced for Camerons Stiff & Co.

