

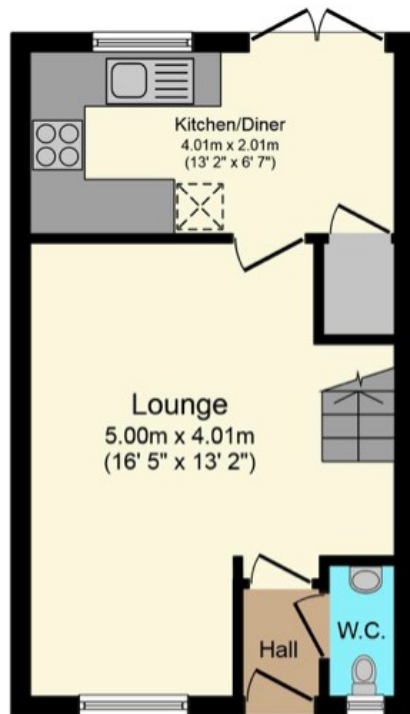

82 Middlepeak Way, Handsworth, Sheffield, S13 9DL

£1,100 PCM

- Modern semi-detached house
- Modern kitchen with built-in appliances
- Available now
- Three bedrooms
- Driveway
- Viewing highly advised
- Master with en-suite shower room
- Unfurnished



Ground Floor

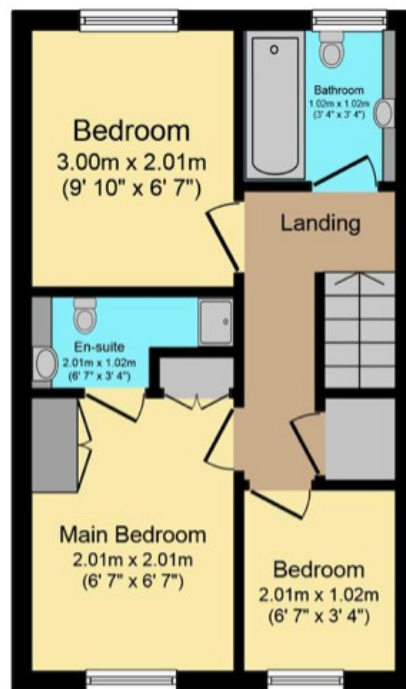

First Floor

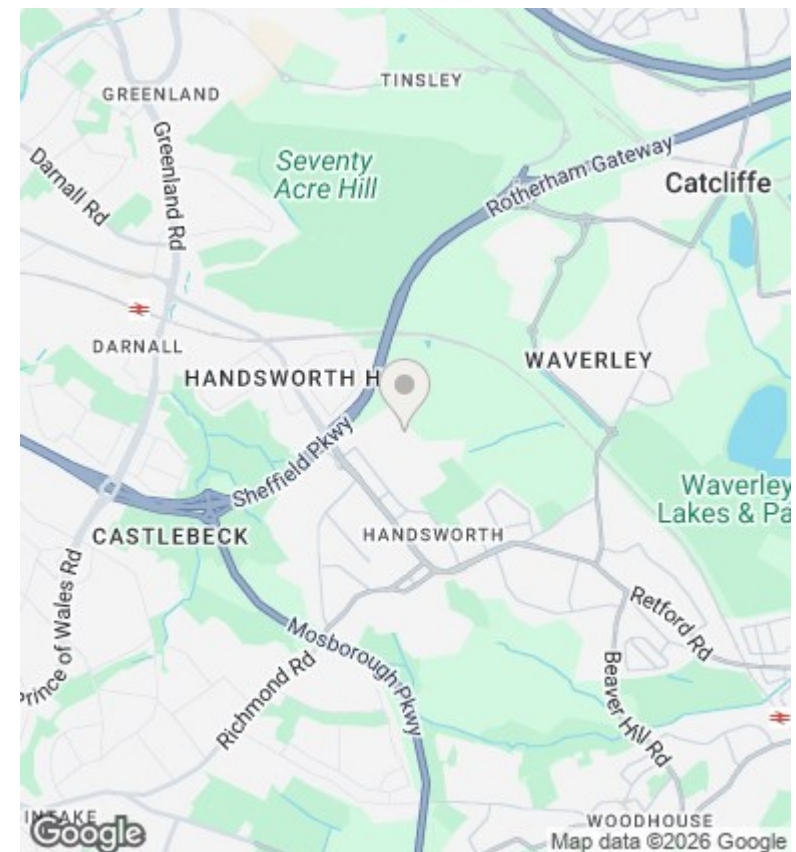

Directions

Viewings

Viewings by arrangement only. Call 01142 687777 to make an appointment.

Council Tax Band

B

EPC Rating:

C

Energy Efficiency Rating		
	Current	Potential
Very energy efficient - lower running costs		
(92 plus) A		
(81-91) B		89
(69-80) C	76	
(55-68) D		
(39-54) E		
(21-38) F		
(1-20) G		
Not energy efficient - higher running costs		
England & Wales	EU Directive 2002/91/EC	