



Haighs Close, Chatteris, Cambs, PE16 6HU

Mid Terraced House - 2 Bedrooms - Kitchen/Breakfast Room & Lounge - First Floor Shower Room -
Enclosed Rear Garden - Allocated Parking - Call To View (01354) 696700

£170,000



Ground Floor

Hall

Entrance door, laminate flooring, window to side and door to:

Lounge

3.73m (12'3") x 3.50m (11'6")
Window to front, radiator, laminate flooring, stairs to first floor and door to:

Kitchen/Breakfast Room

3.48m (11'5") x 3.16m (10'4")
Fitted with a matching range of base and eye level units with worktop space over, 1+1/2 bowl stainless steel sink with tiled splashbacks, electric hob with extractor hood over, double oven, plumbing for washing machine, space for fridge/freezer, storage cupboard, radiator, tiled flooring and door and window to rear.

First Floor

Bedroom 1

3.71m (12'2") x 3.51m (11'6") max
Window to front, radiator and laminate flooring.

Bedroom 2

2.15m (7'1") x 2.02m (6'8")
Window to rear and radiator.

Shower Room

3.24m (10'8") x 1.32m (4'4")
Fitted with three-piece suite with comprising a shower enclosure, vanity wash hand basin and low-level WC, airing cupboard, heated towel rail, tiled flooring and window to rear.

Outside

The property has two allocated parking spaces to the front and an enclosed garden to the rear which is partly laid to lawn and patio.

EPC – Rating: C

Ground Floor

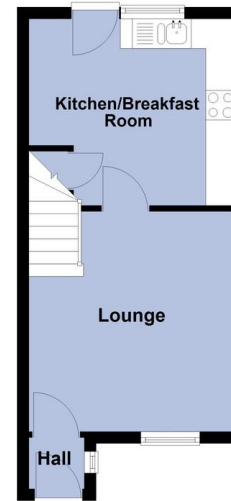

First Floor

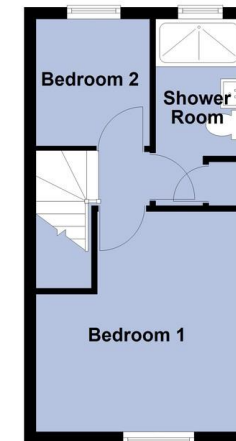

Total area: approx. 49.3 sq. metres (530.5 sq. feet)



Call to arrange a viewing **01354 696700** **T Payne & Co**
SALES & LETTINGS

Agents Notes: Whilst every care has been taken to prepare these sales particulars, they are for guidance purposes only. All measurements are approximate and for general guidance purposes only and whilst every care has been taken to ensure their accuracy, they should not be relied upon and potential buyers are advised to recheck the measurements.