

RICE+ROMAN



Matthews Lodge, Addlestone

KT15 2FB



## Living Area

Matthews Lodge, Station Road, Addlestone, Surrey

## 17 Matthews Lodge, Station Road, Addlestone, KT15 2FB

INTERNAL FLOOR AREA (APPROX.) 565 sq ft/ 52.5 sq m

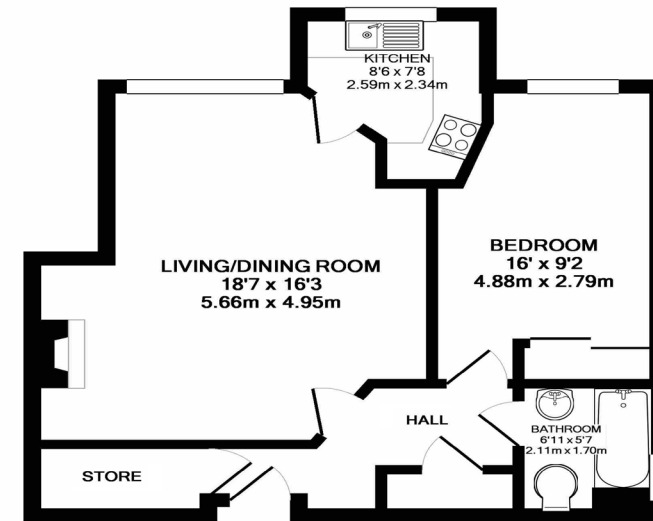

FIRST FLOOR FLAT

Whilst every attempt has been made to ensure the accuracy of this floor plan, measurement of doors, windows, rooms and any other items are approximate and no responsibility is taken for any error, omission or mis-statement. Made with Metropix © 2018.

- For Persons Aged 60+ Years Old
- First Floor Flat
- Larger than Normal
- Corner Apartment
- Parking For Residents & Guests
- On-Site Management

**Price:** £125,000

**Service Charge:** £2,711 PA

**Ground Rent:** £811 PA

**Other Charges:** £N/A

**Lease Length:** 106 years left

**Tenure:** Leasehold

**EPC Rating:** C

For more information  
please contact:

Rice & Roman  
T: 01344 981246  
E: [info@riceandroman.co.uk](mailto:info@riceandroman.co.uk)  
Lynwood Village, SL50FJ  
[www.riceandroman.co.uk](http://www.riceandroman.co.uk)

**RICE +  
ROMAN**

Agents Notices - These property details are set out as a general outline only and do not constitute any part of an Offer or Contract. Any services, equipment, fittings or central heating systems have not been tested and no warranty is given or implied that these are in working order. Buyers are advised to obtain verification from their solicitor or surveyor. Fixtures, fittings and other items are not included unless specifically described. All measurements, distances and areas are approximate and for guidance only. Room measurements are taken to be the nearest 10cm and prospective buyers are advised to check these for any particular purpose, e.g. fitted carpets and furniture. This material is protected by the laws of copyright. The owner of the copyright is Countrywide Estate Agents. This property sheet forms part of our database rights and copyright laws. No unauthorised copying or distribution without permission.