

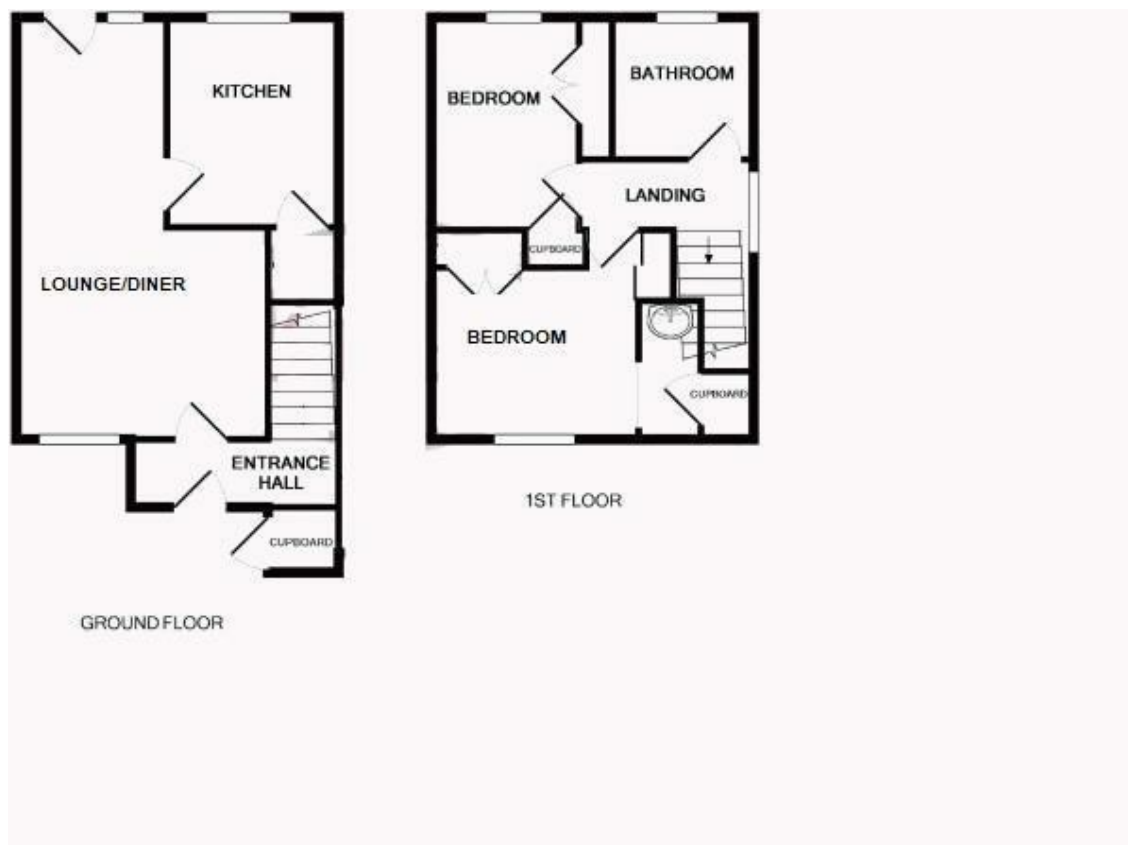

11 Webbington Road, Pewsham, Chippenham, Wiltshire, £1,050 PCM

- TWO BEDROOM
- OFF STREET PARKING
- GAS CENTRAL HEATING
- EN-SUITE SHOWER TO MASTER
- LOW MAINTENANCE GARDEN



Directions

Viewings

Viewings by arrangement only. Call 01249 466999 to make an appointment.

Council Tax Band

EPC Rating:

| Energy Efficiency Rating | | |
|---|-------------------------|-----------|
| | Current | Potential |
| Very energy efficient - lower running costs | | |
| (92 plus) A | | |
| (81-91) B | | |
| (69-80) C | | |
| (55-68) D | | |
| (39-54) E | | |
| (21-38) F | | |
| (1-20) G | | |
| Not energy efficient - higher running costs | | |
| England & Wales | EU Directive 2002/91/EC | |