



85 Caretakers Close, Melksham, SN12 8FR

£1,300 Per Month



- Three bedroom end of terrace house
- Driveway parking for two cars
- Enclosed rear garden with gated side access
- Available 1st August 2026
- Long term let preferred
- EPC - B (83)
- Council Tax - C (Wiltshire Council)

Discover Melksham: A Charming Wiltshire Town with Excellent Connectivity

Nestled along the banks of the River Avon, Melksham is a market town that blends historical charm with modern conveniences. It offers a welcoming community atmosphere complemented by a range of amenities.

Local Amenities and Lifestyle

Melksham boasts a high street filled with independent shops, cafes, and traditional pubs. For leisure and recreation, the town offers several parks and green spaces, including King George V Playing Field, which features a playground, skate park and is home to Melksham Parkrun. The nearby Melksham Community Campus enhances the town's leisure offerings with swimming pool, sports hall, gym and cafe.

THE PROPERTY

Welcome to 85 Caretakers Close, Melksham. A well presented three bedroom end of terrace home with parking for two cars to the front.

The ground floor accommodation comprises entrance hall, cloakroom, lounge with understairs storage cupboard and kitchen dining room with patio doors leading onto the rear garden. The first floor accommodation comprises landing with storage cupboard, primary bedroom with built in storage and en-suite shower room, two further bedrooms and bathroom with shower over the bath.

The property further benefits from gas central heating, double glazing, driveway parking for two cars to the front of the property and an enclosed rear garden with gated side access and an outside tap.

The landlord would prefer a longer term let and may consider pets on application.

SITUATION

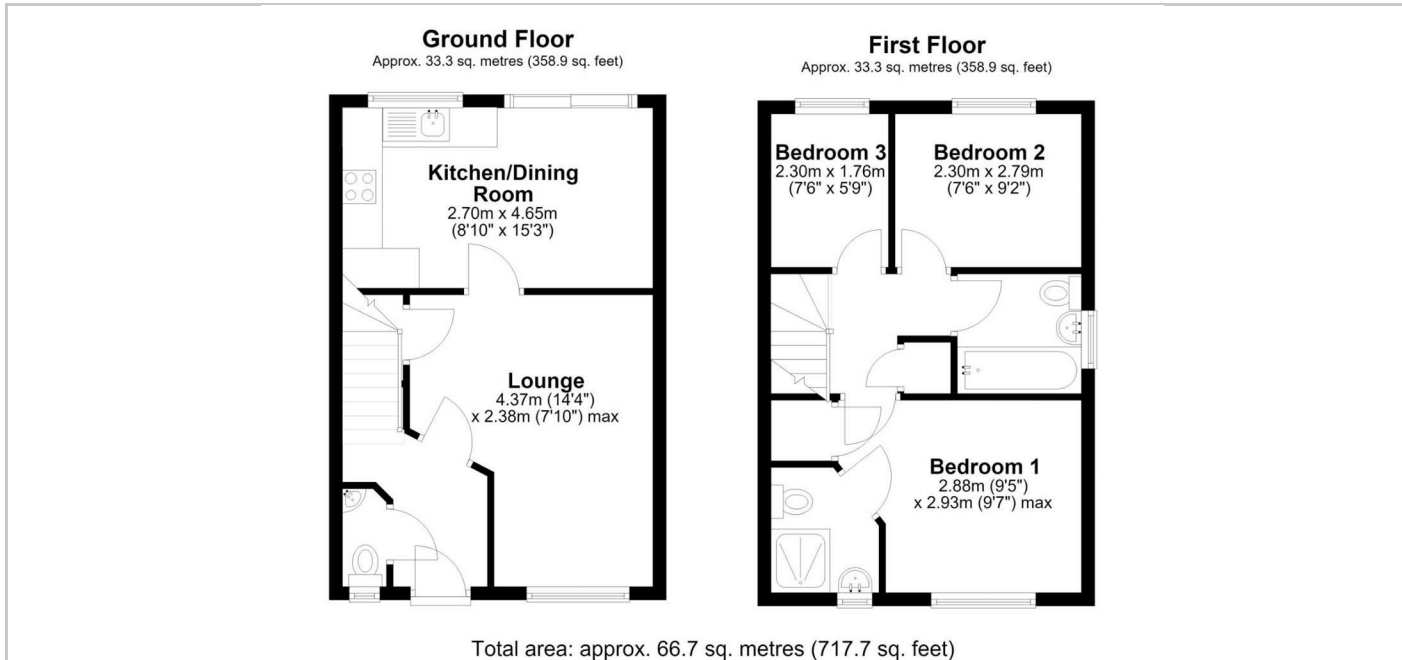

Directions

Office 4 Stockley Farm, Stockley, Wiltshire, SN11 0NT

Tel: 01225 839050 Email: hello@blueleafproperty.co.uk <https://www.blueleafproperty.co.uk>