



Trapps Cottage The Pound, Haxton, Salisbury, Wiltshire, SP4 9PP

£350,000 Freehold

About The Property

Stunning period cottage with superb character features including beams and fireplace with woodburning stove, situated in the heart of the village and offered with vacant possession. Originally two cottages this Grade II listed property has been well converted and now offers very spacious and comfortable accommodation together with a good, private garden and oil fired central heating. It is currently operating as a very successful AirBnB.

On the ground floor is a large, dual aspect sitting room with inglenook fireplace, bread oven opening and woodburning stove with shelves to side, doors to garden and staircase to first floor. The kitchen has a good range of wooden work surfaces and fitted units with butlers sink and oil fired Rayburn stove for cooking and central heating. There is then a rear lobby with stable door to the garden, plumbing and space for washing machine and fridge/freezer space. A shower room has a shower cubicle, wc and hand basin. On the first floor there are two very large double bedrooms with interlinking door and wardrobes and cupboards. There is also a single bedroom and a bathroom with panel bath and shower over, wc and wash basin. There are exposed beams and timbers throughout the cottage together with hard flooring.

There is a pedestrian access way to one side which leads to a good sized, walled and private rear garden with sitting areas, lawn, flower beds, shrubs and trees. There is a wooden garden shed and log stores.



- Period Cottage
- Spacious Rooms
- Bathroom and Shower Room
- Three Bedrooms
- Large Sitting Room
- Good Garden
- Popular Village
- Vacant Possession
- Successful AirBnB

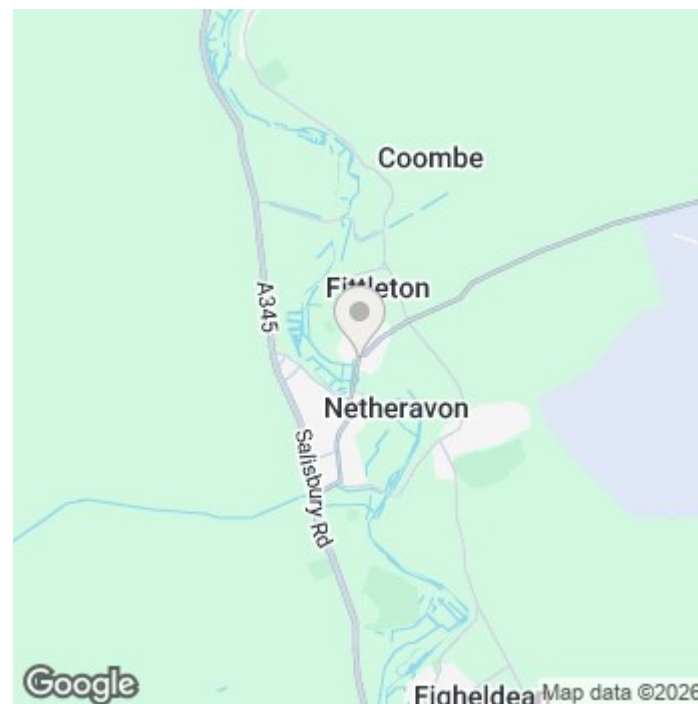



Further Information

Local authority: Wiltshire Council

Council Tax: E - £2645.49 (2025/2026)

Tenure: Freehold

Services: Mains electric, water and drainage.

Heating: Oil fired

Directions: From Salisbury take the A345 to Amesbury, proceeding over the A303 roundabout onto the A345 Countess Road. At the next roundabout continue straight over. After about 3 miles turn right signposted to Haxton, onto Lower Road. Turn next left onto the High Street and follow this road, over the bridge, bearing right where Trapps Cottage will be seen on the right hand side.

What3Words: ///options.coining.earphones

Ground Floor

Approx. 53.2 sq. metres (572.2 sq. feet)

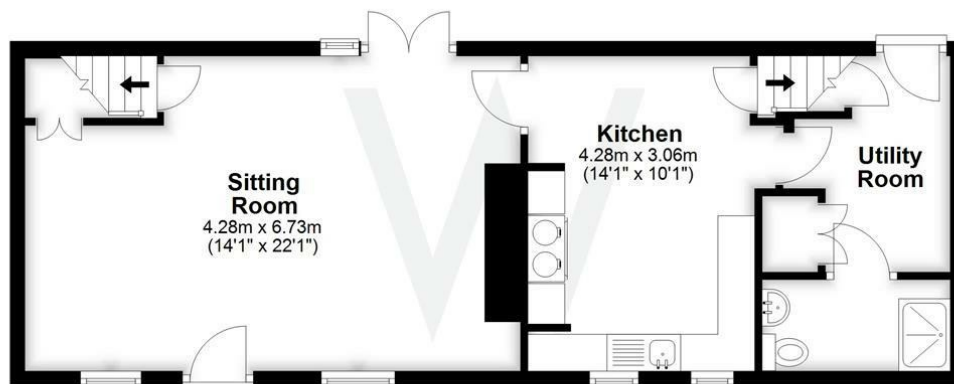

First Floor

Approx. 62.5 sq. metres (672.6 sq. feet)



Total area: approx. 115.6 sq. metres (1244.8 sq. feet)