

Road Map



Hybrid Map



Terrain Map



Floor Plan

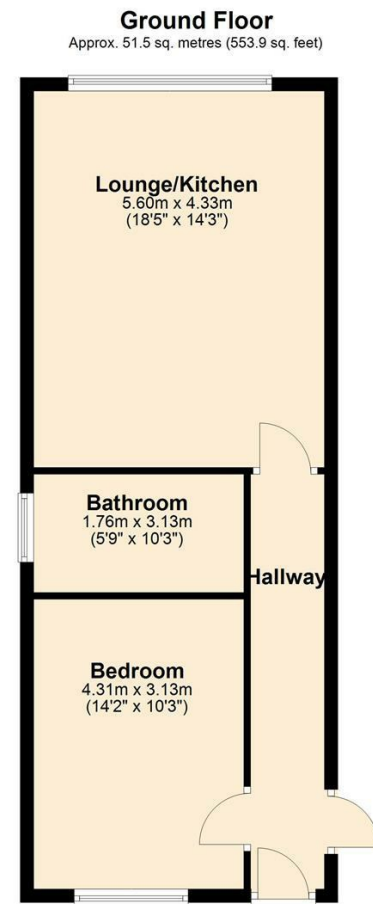

Viewings

Please contact our iMove Sales & Lettings Office on 01253 883311 if you wish to arrange a viewing appointment for this property or require further information.

These particulars, whilst believed to be accurate are set out as a general outline only for guidance and do not constitute any part of an offer or contract. Intending purchasers should not rely on them as statements of representation of fact, but must satisfy themselves by inspection or otherwise as to their accuracy. No person in this firm's employment has the authority to make or give any representation or warranty in respect of the property.

Energy Efficiency Graph

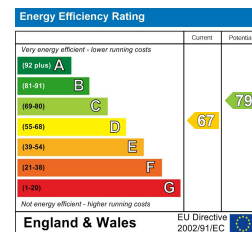

**Pennine View**

Dock Street, Fleetwood, FY7 6JN

Offers In The Region Of £55,000



Make your next move with... **imove**

Call us now on **01253 883311**

hello@imove.today.co.uk



# Pennine View

Dock Street, Fleetwood, FY7 6JN

Offers In The Region Of £55,000



## Introduction

**\*\* Deceptively spacious one bedroom first floor apartment situated close to sea front\*\***

The property is conveniently located within walking distance to Fleetwood Town Centre and it's shops and amenities. Excellent transport links close by for both bus and tram.

The property comprises a modern stylish kitchen with integrated appliances - open plan to the lounge/diner. Three piece bathroom and double bedroom.

Additional Information:

Allocated Parking  
Council Tax Band: A (Wyre)

## Hallway

**Bedroom**  
13'6" x 10'3"

**Bathroom**  
10'3" x 5'9"

**Open Plan Lounge/Kitchen/Diner**  
18'4" x 14'2"

## Additional Info

Tenure - Leasehold  
Lease Term:  
999 Years from 5th December 1973  
Ground Rent: Peppercorn - £5 Per Annum  
Block Management: Approx. £900 per Annum  
Building Insurance Approx. £330 Per Annum  
Gas central heating throughout  
Energy Rating - D  
Council Tax Band - A (Wyre Borough Council)

