

Rectory Gardens, Hingham



1 bed 1 bath 1 living

£575 pcm



Key Features

- Recently Renovated Throughout
- Ground Floor Flat
- Large Enclosed Garden
- Garage
- Electric Heating
- Available Now!

Energy Efficiency Rating		Current	Potential
Very energy efficient - lower running costs			
(92-100)	A		
(81-91)	B		
(69-80)	C		
(55-68)	D		
(39-54)	E		
(21-38)	F		
(1-20)	G		
Not energy efficient - higher running costs			
		72	48
England, Scotland & Wales		EU Directive 2002/91/EC	

Full Description



Belvoir are pleased to present an extremely well-presented ground floor flat within the desirable rural village of Hingham. Providing wonderful access to the A11 and surrounding amenities. The property has modern electric heating, en-block garage and of road parking. Being tucked away within an extremely friendly cul-de-sac the accommodation comprises one double bedroom, neutral fitted kitchen, well sized living room and 3-piece shower suite. Accompanying this is three cupboards providing further storage opportunities. The private enclosed garden can be access through patio door access in the living room and side gate to the front and provides a large area mostly laid to lawn.

A perfect home for a professional individual or couple with great surroundings.

We endeavour to make property particulars accurate and reliable, however, they do not constitute or form part of any contract and none is to be relied upon as statements of representation or fact. Any service, systems and appliances listed in this specification have not been tested by us and no guarantee as to their operating ability or efficiency is given. All measurements have been taken as a guide and are not precise. If you require clarification or further information on any points, please contact us, especially if you are travelling some distance to view.

Rectory Gardens, Hingham



Ground Floor

Approx. 45.0 sq. metres (484.6 sq. feet)

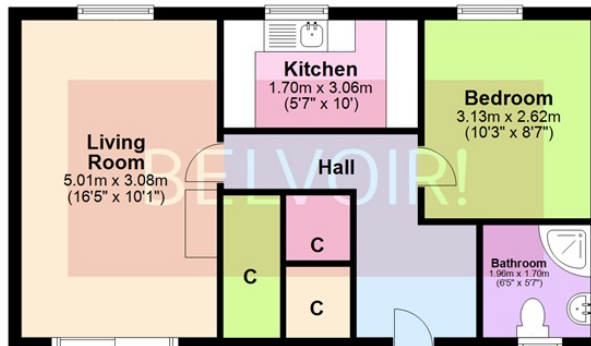

Total area: approx. 45.0 sq. metres (484.6 sq. feet)

Whilst every attempt has been made to ensure the accuracy of the floor plan contained here, measurements of doors, windows, rooms and any other items are approximate and no responsibility is taken for any error, omission or mis-statement. This is for illustrative purposes only and should be used as such.

Plan produced using PlanUp.