



Bridges Court Road, SW11

£475,000

Dexters



Bridges Court Road, SW11

An impressive, two double bedroom new-build apartment on well-connected Bridges Court Road, offering a spacious open-plan kitchen, dining and reception area that opens onto a private outside space (balcony) with far-reaching views across the London skyline and the River Thames. The apartment also benefits from an allocated off-street parking space & access to communal gardens.

As you enter, you're greeted by a bright and welcoming hallway leading into a generous reception and dining room, perfect for relaxing or entertaining. The modern kitchen opens seamlessly into this space, creating a great flow. From the reception, you step out onto a private balcony, a peaceful spot to unwind. The flat features two well-proportioned bedrooms, with the main bedroom offering plenty of space and natural light. With two bathrooms, the layout is both practical and comfortable, ideal for everyday living.

The development has excellent transport links with both Clapham Junction and Wandsworth Town stations only a short walk away. Nearby Clapham and Wandsworth offer an array of retail and leisure facilities and Battersea Park/Power Station are also close by.

Features

- Open Plan Reception/Kitchen
- Two Double Bedrooms
- Private Balcony
- Communal Gardens
- Superb Location
- Allocated Parking Space







Bridges Court Road, London, SW11

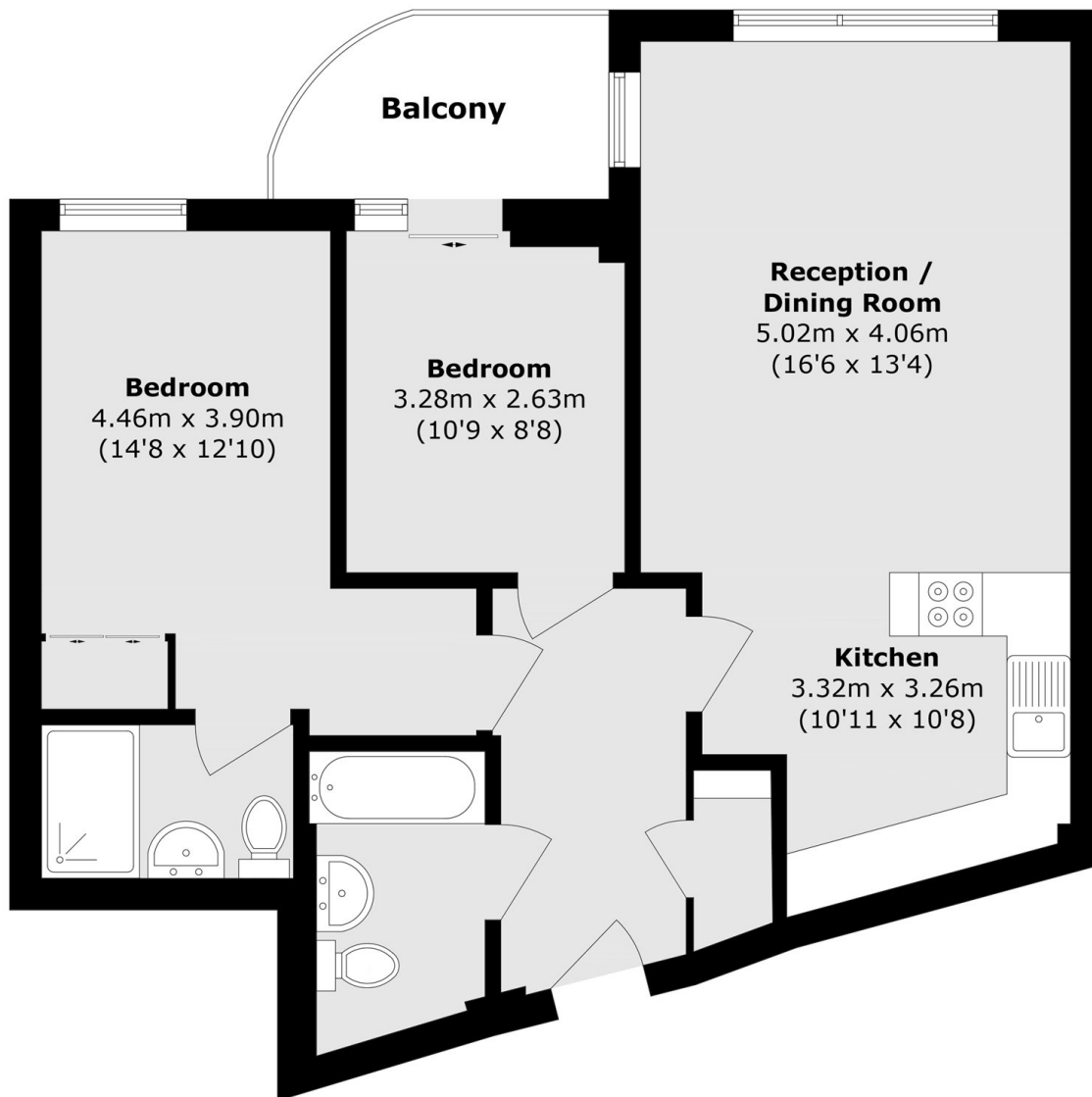

Total area (approx.): 71.5 sq. m (769.6 sq. ft)
Balcony area (approx.): 5.1 sq. m (54.8 sq. ft)