



Room 3 294c Mill Road

, Cambridge, CB1 3NL

£750 Per annum



Room 3 294c Mill Road

, Cambridge, CB1 3NL

£750 Per annum



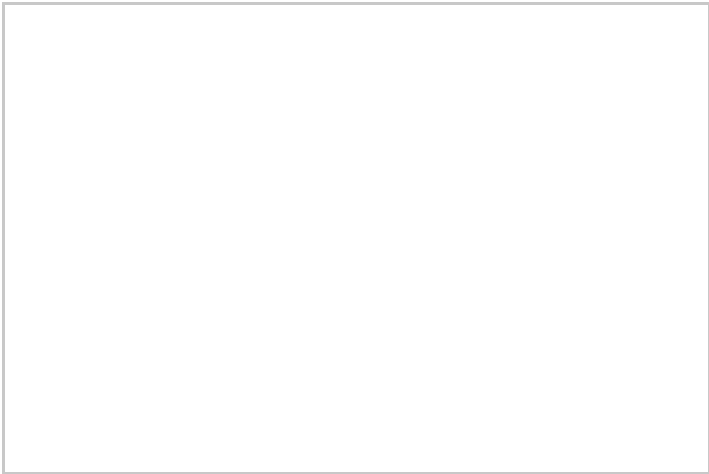
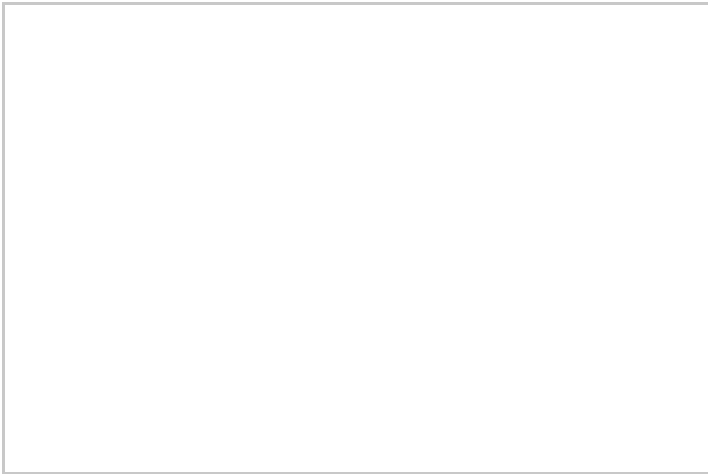
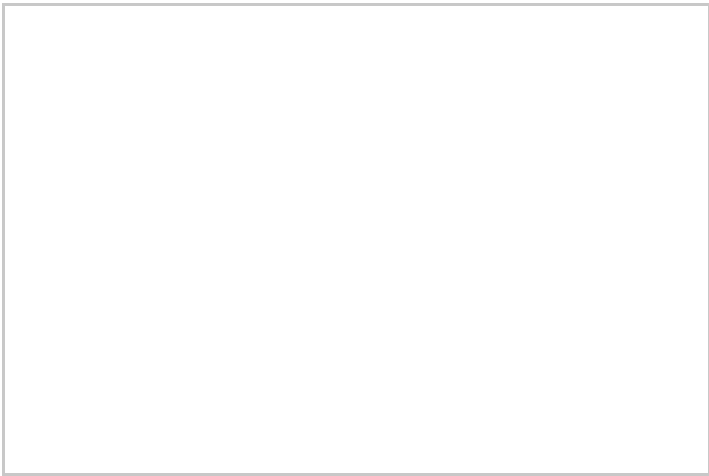
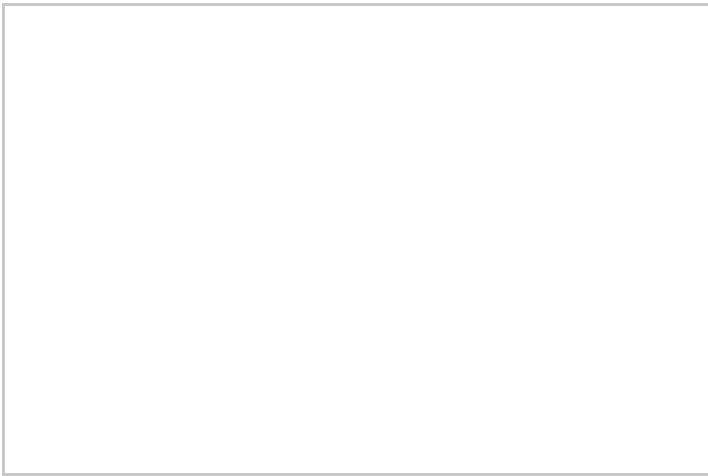

Road Map



Hybrid Map



Terrain Map

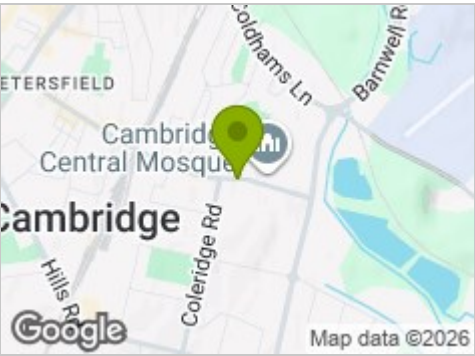

Floor Plan

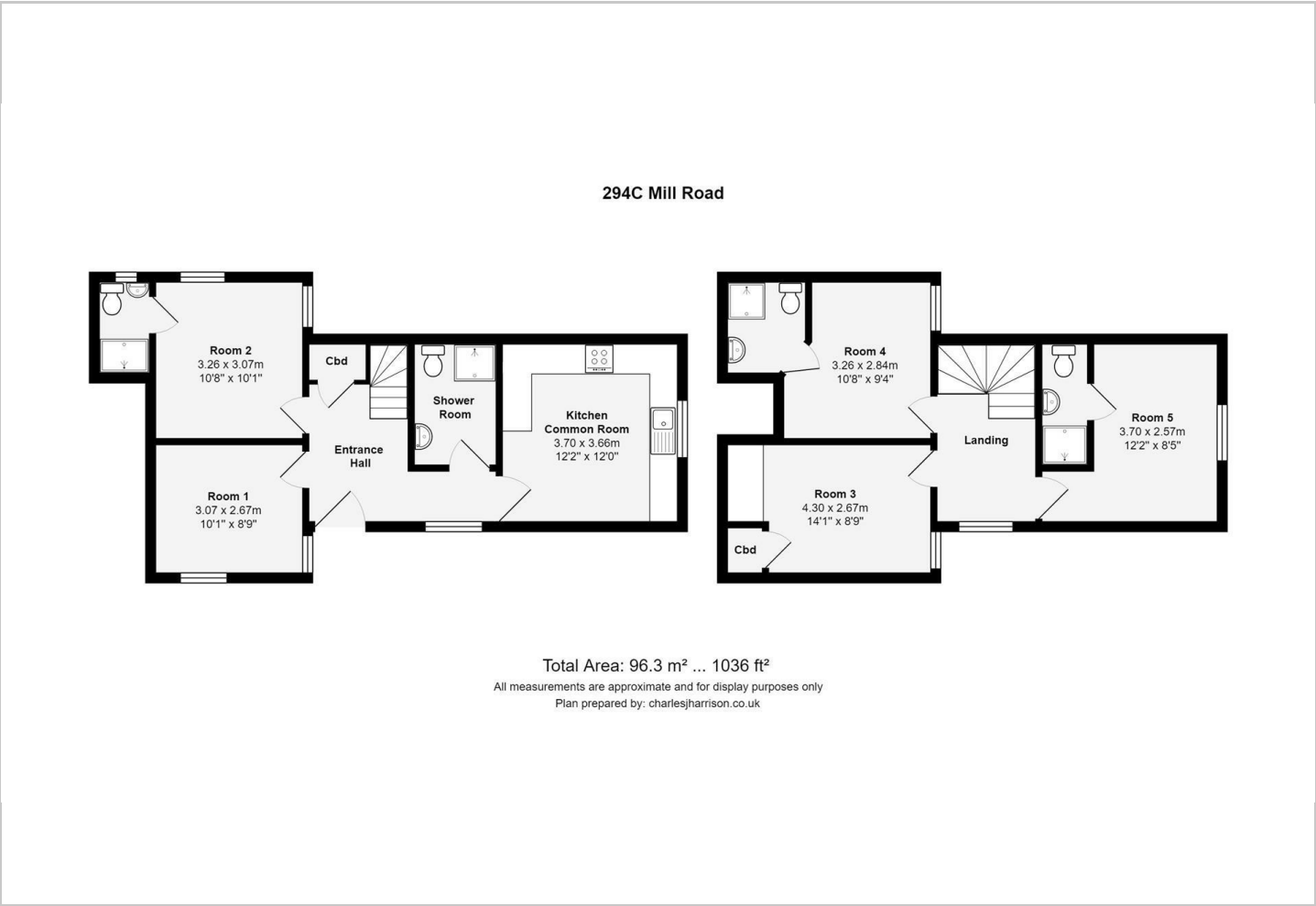

Viewing

Please contact our OpenArch Properties Limited Office on 01223 664200 if you wish to arrange a viewing appointment for this property or require further information.

Energy Efficiency Graph

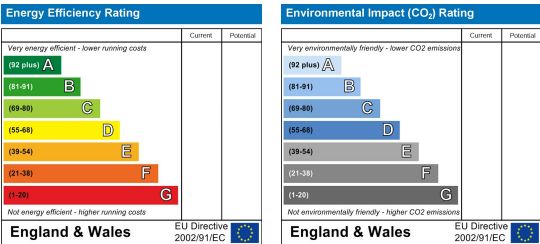

Credit References and Deposit

Prospective tenants will be required to complete a credit referencing application payable whether successful or not. Prior to taking occupation of the property you will be required to pay a deposit of 1½ times the monthly rent, the first months rent in advance and an administration fee.

The Grange Market Street, Swavesey, Cambridgeshire, CB24 4QG
Tel: 01223 664200 Email: enquiries@openarch.co.uk www.openarch.co.uk