



3, Ash Grove, Pontesbury, Shrewsbury, SY5 0RQ
£950 Per Month



3, Ash Grove, Pontesbury, Shrewsbury, SY5 0RQ

£950 Per Month

VIRTUAL TOUR AVAILABLE: Well maintained and recently renovated three bedroom semi detached modern house in a sought after cul de sac location in the village of Pontesbury, a short distance to the south west of Shrewsbury.

Available: Immediately

Description

Comprising: Porch, entrance hall, living room, study, dining area, new kitchen including oven & hob, spacious utility, downstairs WC. Stairs to first floor landing, two double bedrooms, one single bedroom, bathroom with shower. Front and rear gardens, driveway parking for two cars. EPC C



Unfurnished

Council Tax Band: C

Available: 11th February 2026

EPC: C

Floor Plans

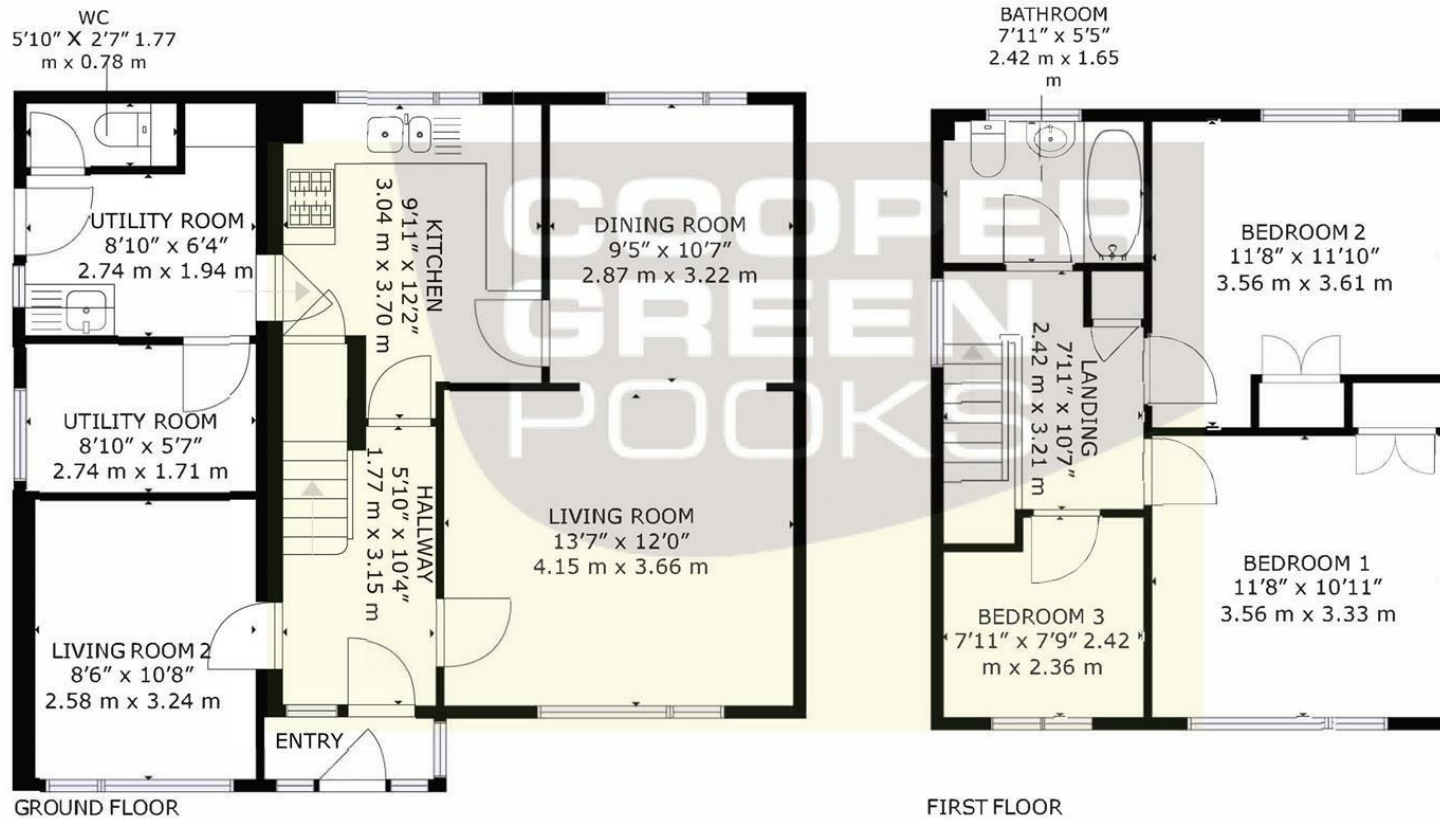

GROSS INTERNAL AREA
 GROUND FLOOR: 724 sq.ft, 69 m², FIRST FLOOR:
 452 sq.ft, 42 m² TOTAL: 1176 sq.ft, 111 m²
 SIZES AND DIMENSIONS ARE APPROXIMATE, ACTUAL MAY VARY.

These particulars, whilst believed to be accurate are set out as a general outline only for guidance and do not constitute any part of an offer or contract. Intending purchasers should not rely on them as statements of representation of fact, but must satisfy themselves by inspection or otherwise as to their accuracy. No person in this firm's employment has the authority to make or give any representation or warranty in respect of the property.