



Leander Avenue, Choppington, NE62 5BB

Offers Over £185,000

Harpers | POWERED BY **exp**™ UK
property people

Bedrooms: 2 | Bathrooms: 1 | Receptions: 2

This beautifully presented two-bedroom semi-detached bungalow, located in the heart of the Wansbeck Estate, offers comfortable and extended living with no onward chain. The property features two spacious reception rooms, providing versatile areas for relaxation and entertaining. The extended kitchen and dining room create a bright and open-plan space, ideal for daily meals and gatherings. There are two double bedrooms, offering ample accommodation, complemented by a well-appointed shower room. Externally, the property boasts an enclosed, low-maintenance garden, perfect for outdoor enjoyment, alongside a single garage offering additional storage and utility space. A driveway to the front provides convenient off-street parking. This home also benefits from a sizeable loft space, offering potential for future use. Well-presented throughout, this bungalow provides an excellent opportunity for those seeking a convenient and ready-to-move-into residence in a desirable location.

- Semi-Detached Bungalow
- Two Double Bedrooms
- Shower Room
- Extended Kitchen & Dining Room
- Garage Storage & Utility Space
- Enclosed Low Maintenance Garden
- Driveway To Front
- Well Presented Throughout
- No Onward Chain
- Sizeable Loft Space





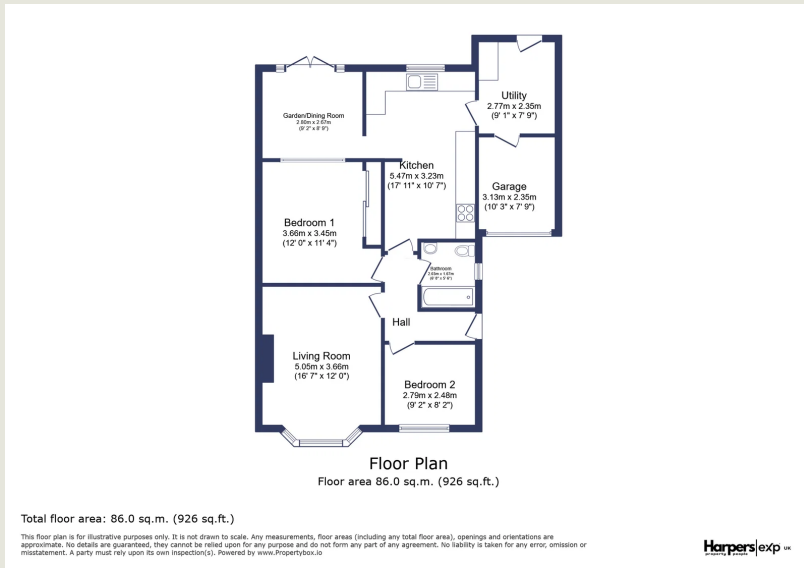

Harpers Property People
80 Windsor Gardens, Bedlington, NE22 5SY

07813 673 606
ali@harpersproperty.com
<https://harpersproperty.com>

Harpersexp uk
property people | POWERED BY