



## Belmont Street, NW1

£475,000



- Two Bedrooms
- Ground Floor Maisonette
- Family Bathroom
- Private Decked Garden
- No Onward Chain
- 99 Year Lease







## ABOUT THE PROPERTY

A ground floor two bedroom maisonette with a modern open plan kitchen and living area, one double and one single bedroom, a private decked garden, and the property is offered to the market with no onward chain.

Belmont Street benefits from excellent access to local public transport links, popular green spaces including Hampstead Heath and Primrose Hill, and a wide range of amenities such as Morrisons and Camden Market.



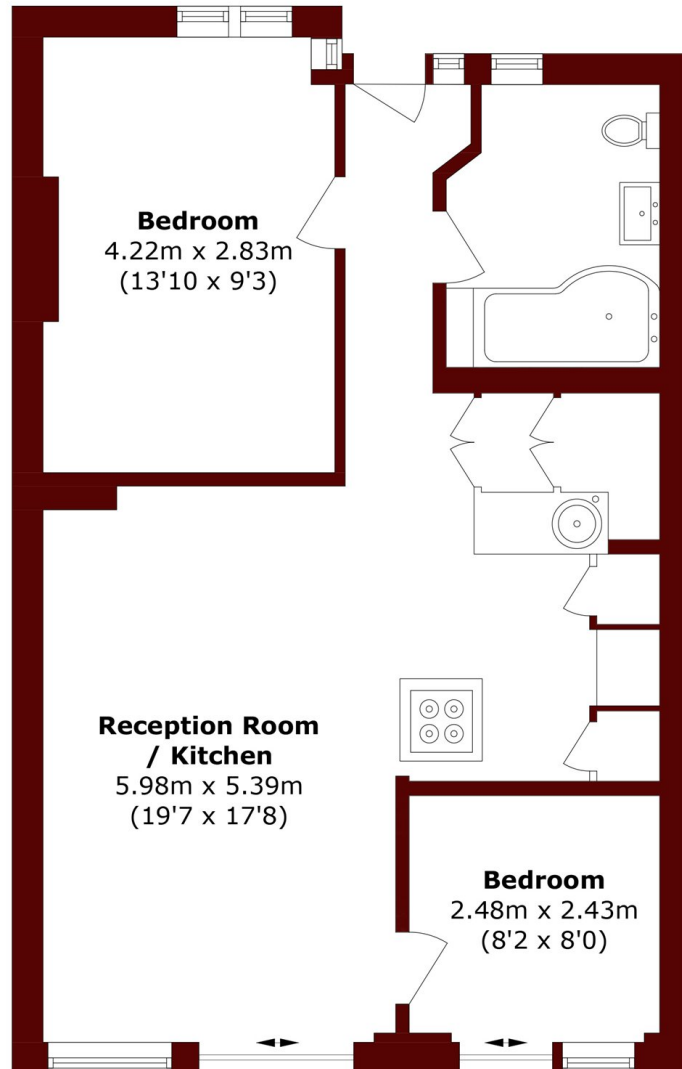

Total area (approx.): 56.6 sq. m (609.2 sq. ft)

## Marsh & Parsons Camden

27 Parkway, London, NW1

7PN

020 7244 2200

We aim to make our particulars both accurate and reliable. However, they are not guaranteed; nor do they form part of an offer or contract. If you require clarification on any points then please contact us, especially if you're traveling some distance to view. Please note that appliances and heating systems have not been tested and therefore no warranties can be given as to their good working order.