



2 Cowley Meadows Holmesfield Road, Dronfield Woodhouse, Dronfield,

Saxton Mee

2 Cowley

Dronfield Woodhouse

Offers In The Region Of

£185,000

A great opportunity for a single person or couple to acquire an exceptionally well presented two bedroomed ground floor flat which forms part of this purpose built block of just four similar properties being located on the fringe of the town yet within reach of a comprehensive range of amenities on Pentland Road and Barnes/Stubley Lane including shops, doctors/pharmacist, nearby parks and renowned schooling.

Offering nicely appointed accommodation is available with a very short established upward chain and offers gas fired central heating via a combination boiler which was fitted approx 5 years ago and briefly comprises: entrance lobby, hall with useful cloak store cupboard, living/dining room, breakfast kitchen, inner hall off which opens two double bedrooms and a superb shower room having been attractively refurbished.

Off road parking to the rear together with visitors parking and detached single garage.



- Superb two double bedroomed ground floor flat
- Part of a small purpose built complex of just four properties
- Semi rural fringe of the town
- Nicely appointed accommodation
- Parking and single garage
- Gas central heating and double glazing
- Short established upward chain
- Viewing essential
- EPC
- Leasehold: Council Tax Band:



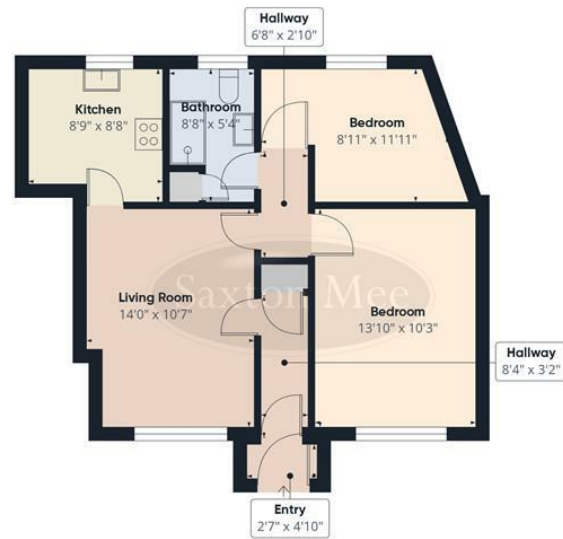

Floor 0 Building 1



Floor 0 Building 2

Approximate total area⁽¹⁾
699 ft²

(1) Excluding balconies and terraces

Calculations reference the RICS IPMS:
3C standard. Measurements are
approximate and not to scale. This
floor plan is intended for illustration
only.

GIRAFFE360

While we endeavour to make our sales particulars fair, accurate and reliable, they are only a general guide to the property and, accordingly, if there is any point, which is of particular importance to you, please contact the relevant office. The Agents have not tested any apparatus, equipment, fittings or services and so cannot verify they are in working order. The buyer is advised to obtain verification. Please note all the measurement details are approximate and should not be relied upon as exact. All plans, floor plans and maps are for guidance purposes only and are not to scale. Under no circumstances should they be relied upon as exact or for use in planning carpets and other such fixtures, fittings or furnishings. YOUR HOME IS AT RISK IF YOU DO NOT KEEP UP REPAYMENTS ON A MORTGAGE OR OTHER LOAN SECURED ON IT. 'A Life Assurance policy may be requested.' 'Written Quotations of credit terms available on request.'

Banner Cross
T: 0114 268 3241
E: bannercross@saxtonmee.co.uk
www.saxtonmee.co.uk

Dronfield
T: 01246 290992
E: dronfield@saxtonmee.co.uk

Hathersage
T: 01433 650009
E: hathersage@saxtonmee.co.uk

Bakewell
T: 01629 815307
E: bakewell@saxtonmee.co.uk

Matlock
T: 01629 828250
E: matlock@saxtonmee.co.uk

