



📍 34 Beechfield Drive, Devizes, Wiltshire, SN10 2SW

🔗 £975 PCM

- Top floor apartment
- Two Double Bedrooms
- Fabulous Views Over K & A Canal
- Two Allocated Parking Spaces
- Communal Garden Overlooking Canal
- Unfurnished
- Available Mid June



🏠 EPC Rating C



Refurbished 2 double bedroom top floor flat, in a quiet cul de sac overlooking the Kennet & Avon Canal. Freshly decorated, and with new carpets, light and airy accommodation comprises a dual aspect 19'10" open plan sitting room/ dining room with a Juliet balcony, a modern fitted kitchen with tiled flooring and granite effect worktops, 2 double bedrooms and modern bathroom with shower over the bath.. In addition the property boasts two allocated parking spaces and communal lawned gardens. Available end of June, unfurnished, £975.00pcm.

Situation

The property is set within a small established cul-de-sac forming part of the Marina development with communal gardens backing on to the Kennet and Avon Canal with countryside views beyond. There is a popular canal side public house called 'The Hourglass' and Devizes Marina Café just a few minutes walk up the road. The historic market town of Devizes has many amenities including town centre shopping, a leisure centre, schools for all ages, various supermarkets, a variety of shops, cinema, theatre and thriving weekly market. The historic Kennet & Avon Canal runs through the town providing fishing and walking facilities. The major centres of Bath, Salisbury, Swindon, Marlborough and Chippenham are all within a 30 mile radius.

Property Information

Services: Electric heating, mains water, electricity and drainage.

Council Tax Band: B

EPC Rating: C



Beechfield Drive, Devizes, SN10

Approximate Area = 651 sq ft / 60.4 sq m

For identification only - Not to scale

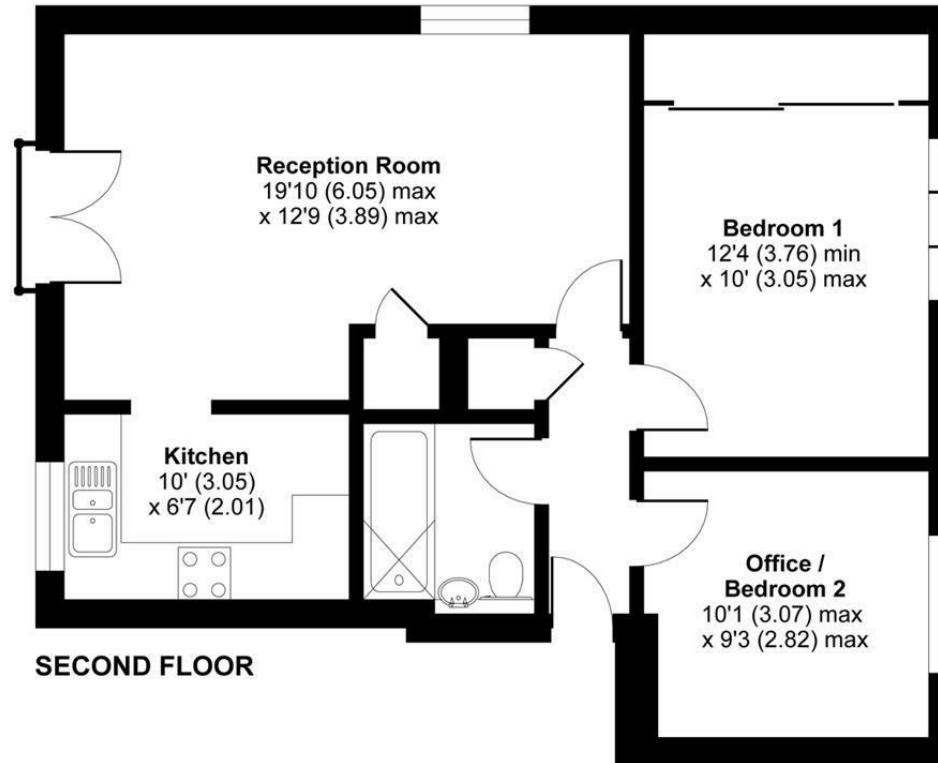

Floor plan produced in accordance with RICS Property Measurement Standards incorporating International Property Measurement Standards (IPMS2 Residential). © nichecom 2021. Produced for Strakers. REF: 708939

Disclaimer These particulars, whilst believed to be accurate are set out as a general outline only for guidance and do not constitute any part of an offer or contract. Intending purchasers should not rely on them as statements of representation of fact, but must satisfy themselves by inspection or otherwise as to their accuracy. No person in this firm's employment has the authority to make or give any representation or warranty in respect of the property. All measurements and distances are approximate only. Your home is at risk if you do not keep up repayments on a mortgage or other loan secured on it.