



Connells

Stymie Close
Basingstoke



Property Description

Situated in the sought-after Gillies Meadow development in Basingstoke, this beautifully presented two-bedroom semi detached home offers modern, low-maintenance living and is ideal for first-time buyers, downsizers, or investors alike.

The property is finished to a high standard throughout and benefits from the remainder of an NHBC warranty, providing peace of mind for years to come. Upon entering, you are welcomed into a bright and contemporary home with well-planned accommodation. The ground floor features a cloakroom, a separate modern kitchen with a range of fitted units and integrated appliances, along with a spacious lounge/diner to the rear. This versatile living space offers ample room for both relaxing and entertaining, with access to the rear garden.

Upstairs, the property offers two well-proportioned bedrooms, along with a modern family bathroom and en suite, all presented in excellent condition.



Externally, the home benefits from a private rear garden with side gate access and the rare advantage of two allocated parking spaces to the front.

This fantastic home combines contemporary living with a convenient location, close to local amenities, transport links, and green spaces. Early viewing is highly recommended to fully appreciate all that this property has to offer.

Situated in the sought-after Gillies Meadow development in Basingstoke, this beautifully presented two-bedroom semi detached home offers modern, low-maintenance living and is ideal for first-time buyers, downsizers, or investors alike.







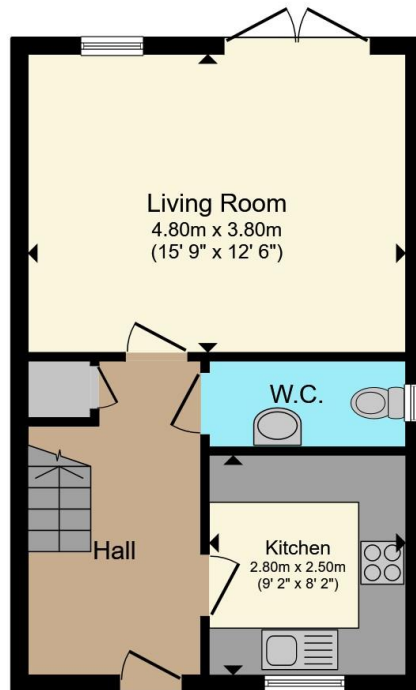

Ground Floor

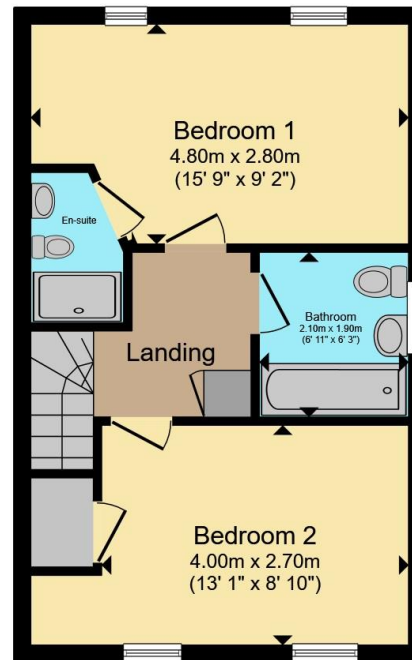

First Floor

Total floor area 75.8 m² (816 sq.ft.) approx

This floor plan is for illustrative purposes only. It is not drawn to scale. Any measurements, floor areas (including any total floor area), openings and orientation are approximate. No details are guaranteed, they cannot be relied upon for any purpose and they do not form part of any agreement. No liability is taken for any error, omission or misstatement. A party must rely upon its own inspection(s). Powered by www.propertybox.io



To view this property please contact Connells on

T 01256 464566
E basingstoke@connells.co.uk

1 Wote Street
 BASINGSTOKE RG21 7NE

EPC Rating: B Council Tax
 Band: D

Tenure: Freehold

view this property online connells.co.uk/Property/BTK314854



1. MONEY LAUNDERING REGULATIONS Intending purchasers will be asked to produce identification documentation at a later stage and we would ask for your co-operation in order that there will be no delay in agreeing the sale. 2. These particulars do not constitute part or all of an offer or contract. 3. The measurements indicated are supplied for guidance only and as such must be considered incorrect. Potential buyers are advised to recheck measurements before committing to any expense. 4. We have not tested any apparatus, equipment, fixtures, fittings or services and it is in the buyers interest to check the working condition of any appliances.

Connells Residential is registered in England and Wales under company number 1489613, Registered Office is Cumbria House, 16-20 Hockliffe Street, Leighton Buzzard, Bedfordshire, LU7 1GN. VAT Registration Number is 500 2481 05.

See all our properties at www.connells.co.uk | www.rightmove.co.uk | www.zoopla.co.uk

Property Ref: BTK314854 - 0002