



Connells

Barrow Gardens
Redhill



This attractive four bedroom mews home enjoys a pleasant outlook across a central play park and an area of open greenery, creating a welcoming environment for families and those seeking a community feel. Arranged across three floors, the property offers flexible accommodation, thoughtfully designed to suit modern lifestyles.

Upon entering, you are welcomed into the hallway which provides access to a guest W.C. To the front lies a well-appointed kitchen fitted with a range of modern units, integrated appliances, and ample workspace. To the rear, the open plan reception and dining area creates a bright and social heart to the home, with French doors opening directly onto the garden.

On the first floor, there is a well-proportioned double bedroom complete with fitted wardrobes and its own en-suite shower room, alongside a fourth bedroom with built-in storage that could also serve as a study or nursery. A family bathroom completes this level.

The top floor is home to the primary suite, which includes fitted wardrobes and an en-suite with both a bath and separate shower cubicle. Also occupying this level is another double bedroom with built in storage and doors that open to a Juliet balcony.

Externally, the rear garden has been thoughtfully landscaped to include a decked entertaining terrace, a central lawn area bordered by planting, and a useful timber shed. A rear access gate leads directly to the parking area where two allocated spaces are available for the property.



Ground Floor

Entrance Hallway

W.C

Kitchen

11' 1" x 8' 2" Max (3.38m x 2.49m Max)

Living & Dining Room

19' 8" Max x 13' 2" (5.99m Max x 4.01m)

First Floor

Landing

Bedroom Two

12' 9" Max x 11' 4" (3.89m Max x 3.45m)

En-Suite Shower Room

6' 2" Max x 5' 3" Max (1.88m Max x 1.60m Max)

Bedroom Four

9' 3" Plus built in storage x 6' 6" (2.82m Plus built in storage x 1.98m)

Bathroom

6' 9" x 5' 6" (2.06m x 1.68m)

Second Floor

Landing

Bedroom One

15' 9" Max x 13' 2" Max (4.80m Max x 4.01m Max)

En-Suite Bath & Shower Room

9' 2" Max x 6' 3" Max (2.79m Max x 1.91m Max)

Bedroom Three

11' 9" x 9' 7" Plus storage (3.58m x 2.92m Plus storage)

With doors opening to a:

Juliet Balcony

Outside

Rear Garden

Two Allocated Parking Spaces







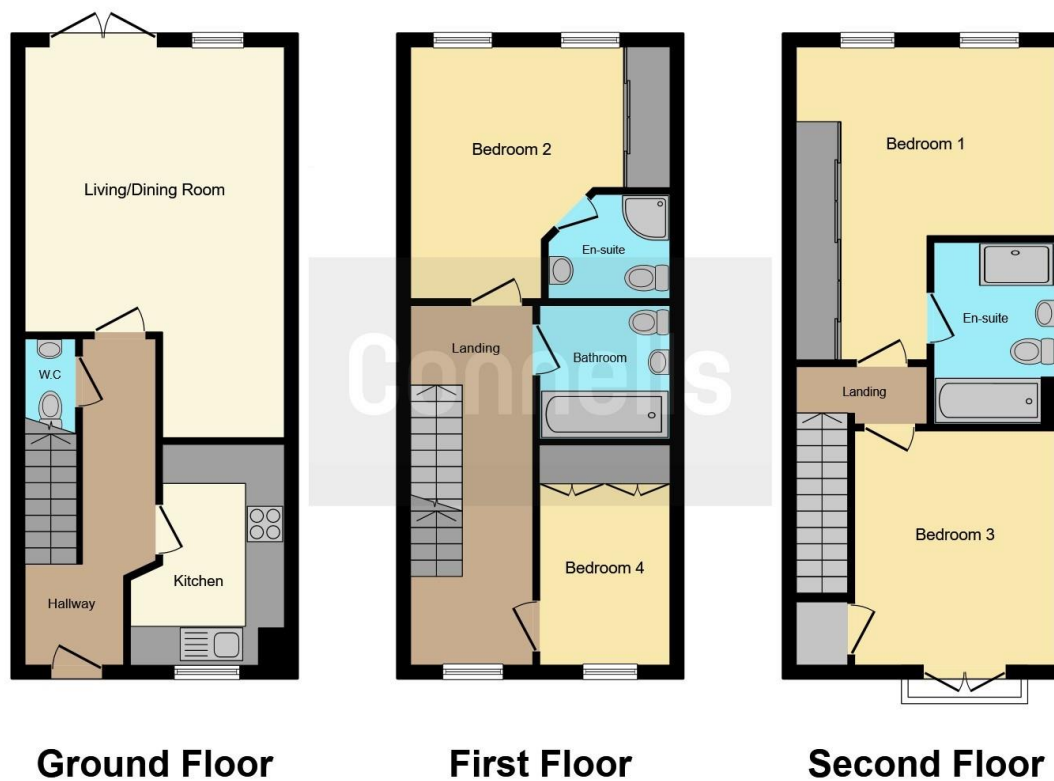

This floor plan is for illustrative purposes only. It is not drawn to scale. Any measurements, floor areas (including any total floor area), openings and orientation are approximate. No details are guaranteed, they cannot be relied upon for any purpose and they do not form part of any agreement. No liability is taken for any error, omission or misstatement. A party must rely upon its own inspection(s). Powered by www.focalagent.com

To view this property please contact Connells on

T 01737 774 277
E redhill@connells.co.uk

43 Station Road
 REDHILL RH1 1QH

EPC Rating: C Council Tax
 Band: E

Tenure: Freehold

view this property online connells.co.uk/Property/RED408229



1. MONEY LAUNDERING REGULATIONS Intending purchasers will be asked to produce identification documentation at a later stage and we would ask for your co-operation in order that there will be no delay in agreeing the sale. 2. These particulars do not constitute part or all of an offer or contract. 3. The measurements indicated are supplied for guidance only and as such must be considered incorrect. Potential buyers are advised to recheck measurements before committing to any expense. 4. We have not tested any apparatus, equipment, fixtures, fittings or services and it is in the buyers interest to check the working condition of any appliances.

Connells Residential is registered in England and Wales under company number 1489613, Registered Office is Cumbria House, 16-20 Hockliffe Street, Leighton Buzzard, Bedfordshire, LU7 1GN. VAT Registration Number is 500 2481 05.

See all our properties at www.connells.co.uk | www.rightmove.co.uk | www.zoopla.co.uk

Property Ref: RED408229 - 0005