



THE
YORKSHIRE PROPERTY
AGENCY

Undercliffe Hall, Dikes Lane, Great Ayton

£2,850,000

🛏 7 🚿 7 🛋 8

- Stunning Victorian Manor House
- Boasting almost 12,000 sq ft of luxurious modern interior
- Situated with approximately 11.26 acres of Grassland and woodland,
- Five bedrooms
- Separate two bedroom annex
- Original features throughout
- Games room and cinema
- Double-garage and off-street parking for multiple cars
- Incredible views of the Cleveland Hill and North Yorkshire countryside
- Council tax band H



The Yorkshire Property Agency is absolutely delighted to introduce a rare opportunity to purchase this stunning Victorian Manor House located on the outskirts of the popular North Yorkshire village of Great Ayton and within the boundaries of the North Yorkshire Moors National Park. Boasting almost 12,000 sq ft of luxurious modern interior and situated within its own grounds of approximately 11.26 acres of Grassland and Woodland, properties like Undercliffe Hall do not come onto the market often



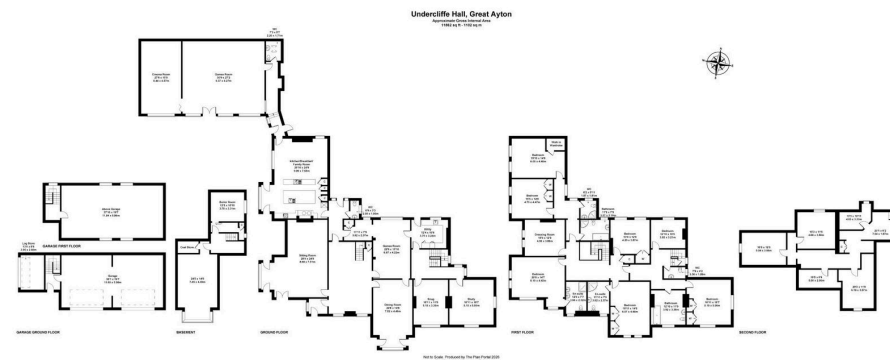

RICHARD TOWLER

DIRECTOR

The Yorkshire Property Agency.

07387 687 753

richard@theyorkshirepropertyagency.co.uk

Springboard Business Centre, Ellerbeck Way, Stokesley Business Park, Stokesley TS9 5JZ