

Hope Street, Leigh, WN7 1NB
£110,000

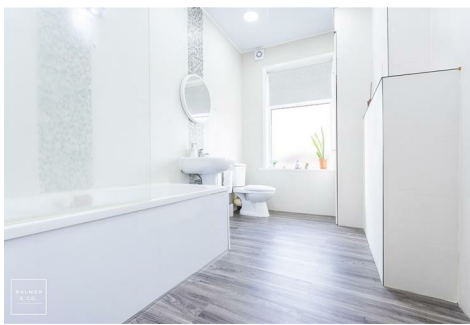

BALMER & CO in LEIGH are delighted to offer FOR SALE this fantastic two bedroom mid-terrace house in Leigh. Offered with NO ONWARD CHAIN and very nicely presented throughout, this property comprises in brief of entrance vestibule, large living room with gas fireplace and surround, with a modern fitted kitchen/dining room completing the ground floor. To the first floor is a large master bedroom, second large single bedroom, with a three piece family bathroom completing the accommodation on offer. Externally the property is pavement fronted whilst to the rear there is a fully enclosed, low maintenance, West facing yard. Early viewings highly recommended, all enquiries welcome.

Floor Plan

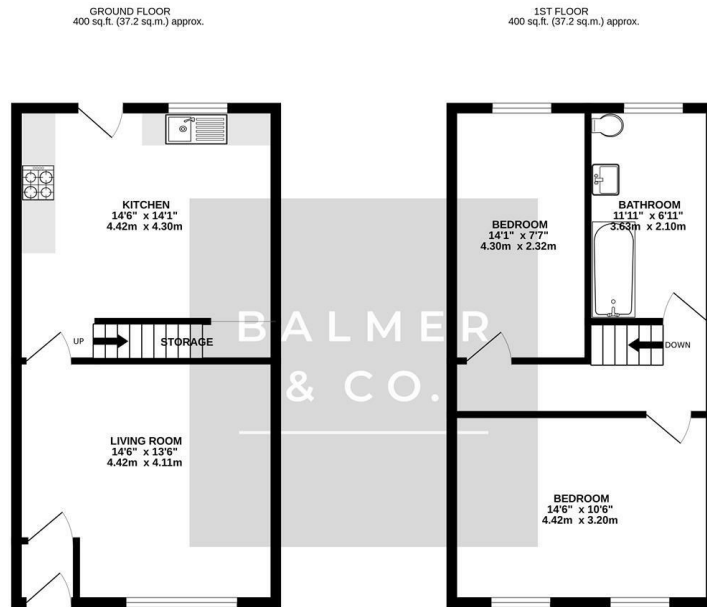

TOTAL FLOOR AREA: 801 sq.ft. (74.4 sq.m.) approx.
Whilst every attempt has been made to ensure the accuracy of the floorplan contained herein, measurements of doors, windows, rooms and any other items are approximate and no responsibility is taken for any error, omission or mis-statement. This plan is for guidance purposes only and should be used as such by any prospective purchaser. The services, systems and appliances shown have not been tested and no guarantee is given as to their operability or efficiency can be given.
 Made with Metrepro ©2025

Area Map

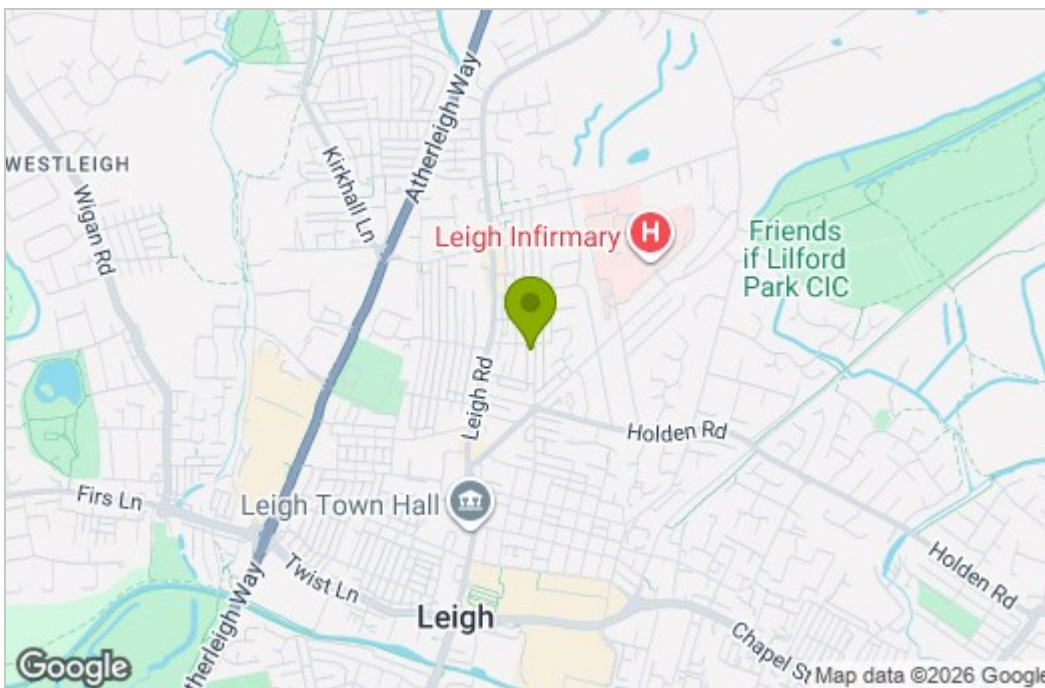

Energy Efficiency Graph

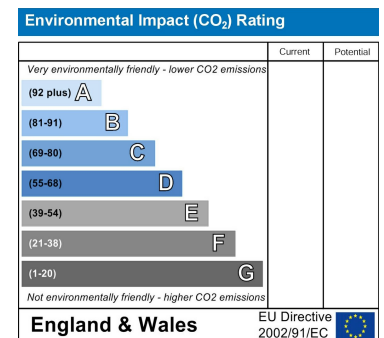
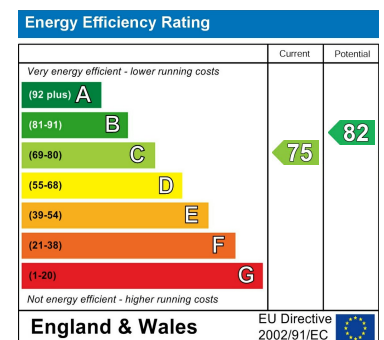

These particulars, whilst believed to be accurate are set out as a general outline only for guidance and do not constitute any part of an offer or contract. Intending purchasers should not rely on them as statements of representation of fact, but must satisfy themselves by inspection or otherwise as to their accuracy. No person in this firm's employment has the authority to make or give any representation or warranty in respect of the property.