



A well-proportioned two-bedroom first floor maisonette with private garden, offered chain free and available to view immediately. The property also benefits from a long lease.

The property comprises of a separate living room, fitted kitchen with access to a private balcony, family bathroom suite, and two good sized bedrooms. The accommodation is well laid out and provides practical living space throughout.

Firs Lane, N21

Approximate Gross Internal Area = 630 sq ft / 58.5 sq m

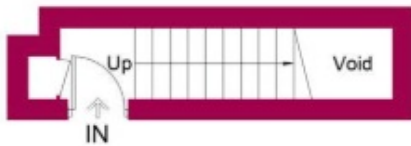

Ground Floor



First Floor

Score	Energy rating	Current	Potential
92+	A		
81-91	B		
69-80	C		
55-68	D	59 D	66 D
39-54	E		
21-38	F		
1-20	G		

