



Hillary Road, UB2

£525,000

A spacious three bedroom end-of-terrace house presented in good decorative order. On the ground floor is a double reception area, an open plan kitchen/dining room with side and garden access and an additional reception area with doors which open out onto the large south facing garden.



There are three bedrooms and a bathroom with separate WC on the first floor. The property further benefits from convenient side access and a useful entrance porch.

Hillary Road is well located for easy access to the M4 and Southall Broadway with various bus links to Ealing and Uxbridge. Southall station (Elizabeth line) is less than a mile away and provides fast and easy access into central London and Heathrow airport.

- End-Of-Terrace • Open Plan Kitchen/Diner • Double Reception •
- South Facing Garden • Three Double Bedrooms • Close To Transport Links •



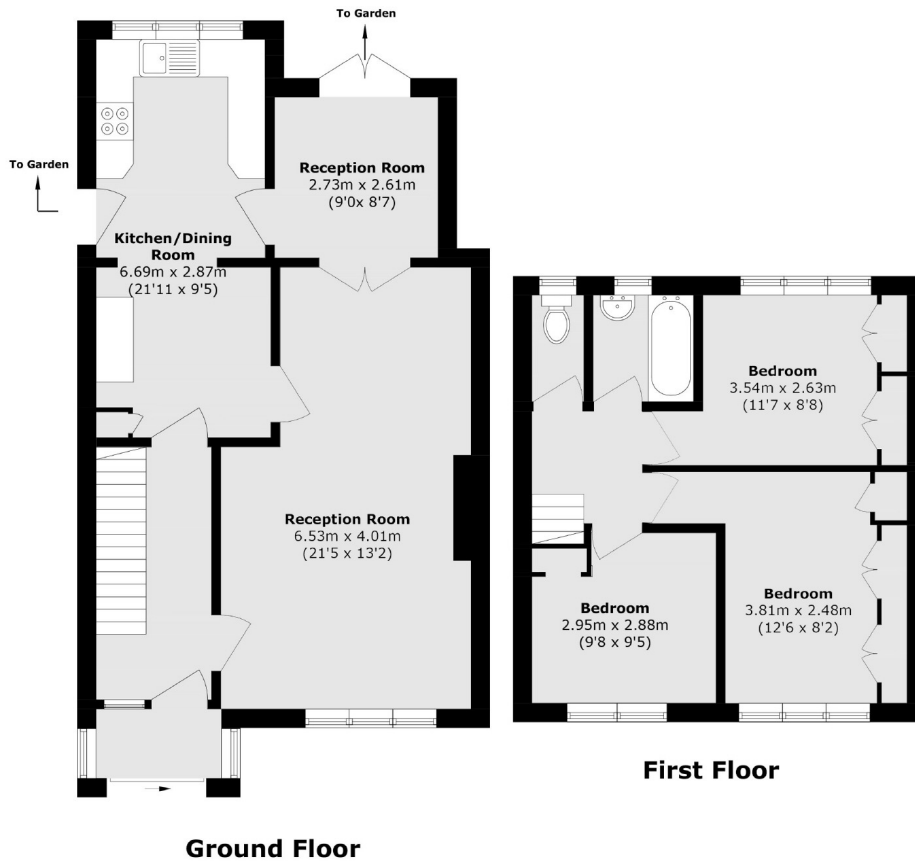

Total area (approx.): 100.8 sq. m (1085.0 sq. ft)

Robertson Smith & Kempson Hanwell Sales
69 Greenford Avenue,
London, W7 1LL
020 8566 2339
hanwellsales@robertsonsmithandkempson.co.uk

Energy Rating: D. We aim to make our particulars both accurate and reliable. However they are not guaranteed; nor do they form part of an offer or contract. If you require clarification on any points then please contact us, especially if you're traveling some distance to view. Please note that appliances and heating systems have not been tested and therefore no warranties can be given as to their good working order.