

# chris hamriding

lettings & estate agents



## 34 Heath Road, Sandbach, CW11 2JU

### Offers Over £240,000

Take a moment to view our guided, aerial tour of this impressive, three bedroom home with a fantastic rear garden!

Dating back to circa 1928, this three bedroom Victorian property is packed full of character whilst occupying an impressive plot, on a favoured road close to Sandbach Town Centre and it's many amenities.

Accompanying the home are a number of features to note, some of which include, double glazing throughout, gas central heating, original Minton tiled flooring to the entrance hall, a spacious lounge with feature fireplace and exposed wooden flooring, a sociable dining kitchen complete with cream 'shaker' style units and a wealth of storage, well equipped with integrated appliances and ample working surfaces. There is a separate utility keeping the kitchen nice and tidy plus a handy downstairs WC.

Upstairs, the spacious theme continues with three bedrooms, two of which are comfortable double rooms and a third single room, currently being used a dressing room but could also make a great single room or home office. Both of the main bedrooms also have some beautiful features and period-style fire grates!

Externally, the home continues to impress, with a large driveway providing ample off road parking for several vehicles and being set well back from the road! The rear garden is our favourite attribute of this wonderful

Accommodation

- Entrance Hall 7'11" x 3'7" (2.416 x 1.114)
- Lounge 13'2" x 12'5" (4.032 x 3.786)
- Kitchen Diner 15'5" x 10'5" (4.700 x 3.180)
- Utility 8'3" x 8'2" (2.529 x 2.495)
- Cloakroom 3'8" x 2'11" (1.123 x 0.900)
- First Floor Landing 8'3" x 6'4" (2.539 x 1.934)
- Bedroom One 13'3" x 9'3" (4.041 x 2.828)
- Bedroom Two 10'6" x 9'1" (3.224 x 2.780)
- Bedroom Three 8'0" x 6'4" (2.456 x 1.950)
- Family Bathroom 7'1" x 5'6" (2.174 x 1.691)



Floor Plan

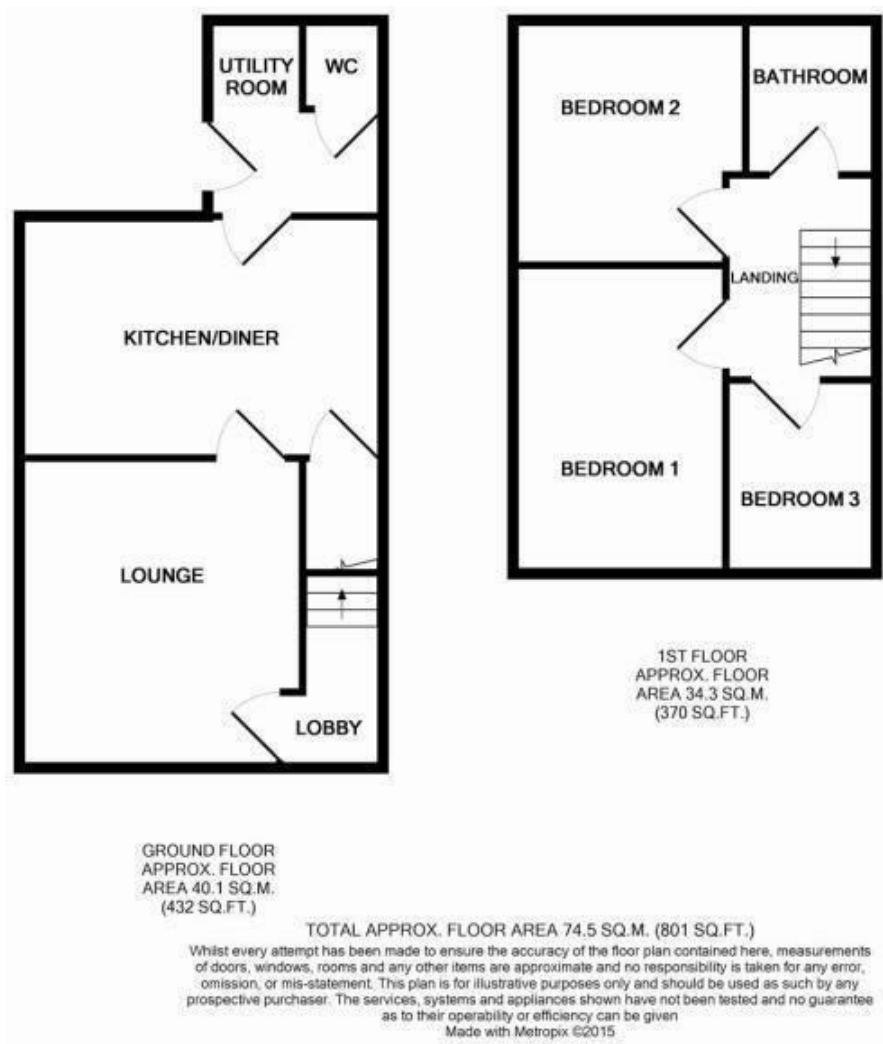

Area Map

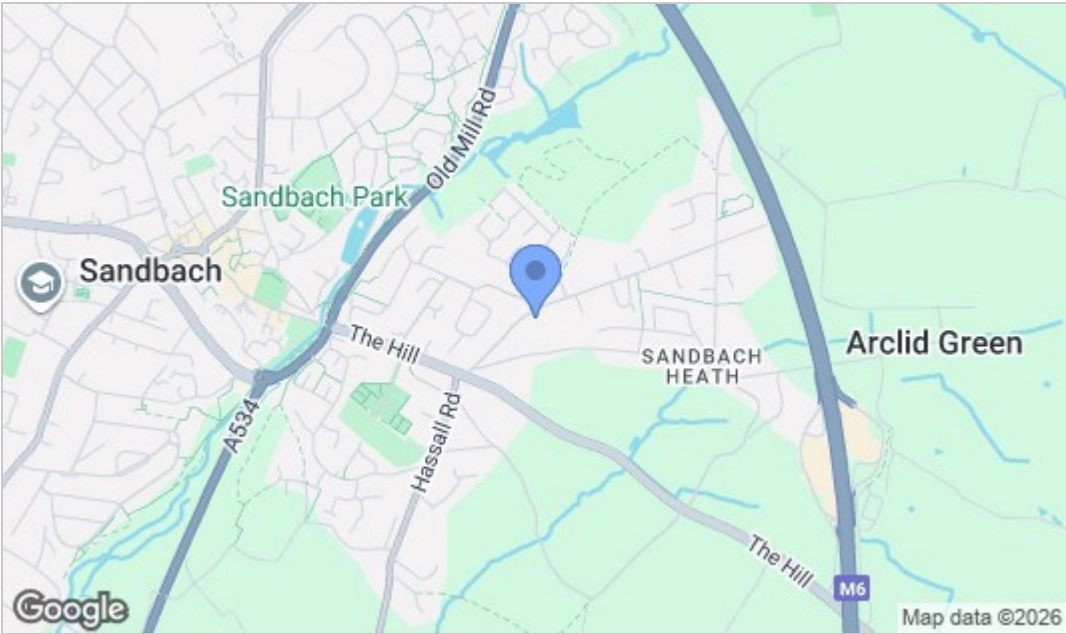

Energy Efficiency Graph

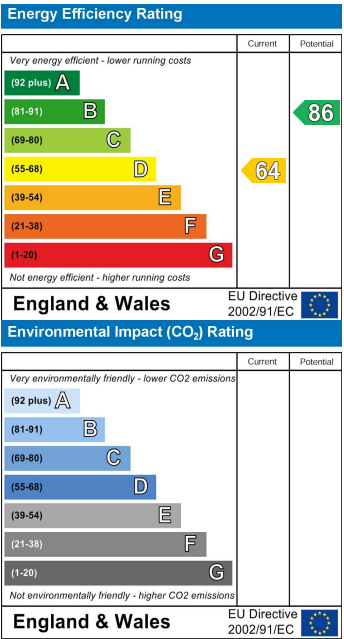

NOTICE Chris Hamriding Lettings & Estate Agents for themselves and for the vendor or lessors of this property whose agents they are given notice that: (i) the particulars are set out as a general outline only for the guidance of intending purchasers or lessees, and do not constitute, nor constitute part of, an offer of contract, (ii), all descriptions, dimensions, references to condition and necessary permissions for use and occupation, and other details are given in good faith and are believed to be correct but any intending purchasers or tenants should not rely on them as statement or representation of fact but must satisfy themselves by inspection or otherwise as to the correctness of each of them, (iii) no person in the employment of Chris Hamriding Lettings & Estate Agents has any authority to make or give any representation or warranty whatever in relation to this property.