

Because life is

PettyTM
Real

19 Clare Avenue
Colne
BB8 8LW



For Sale

Price £200,000

- Semi-detached bungalow on Clare Avenue, Colne
- Offered for sale with no onward chain
- Spacious and bright lounge
- Modern dining kitchen
- Conservatory overlooking the garden

- Useful separate utility room
- Two well-proportioned bedrooms
- Contemporary three-piece shower room
- Driveway, lawned garden and garden shed
- Ideal for a downsizer



Situated in a popular and well-established residential area of Clare Avenue in Colne, this attractive semi-detached bungalow offers comfortable single-level living and is available with the added benefit of no onward chain. Well maintained throughout, the property is ideally suited to those looking to downsize, retirees, or buyers seeking a manageable and convenient home.

The accommodation begins with a welcoming porch, providing a practical entrance into the property. From here, you are led into a spacious lounge, offering a comfortable setting for relaxation and everyday living. The room enjoys plenty of natural light and provides an inviting atmosphere throughout the year.

To the rear of the property is a modern dining kitchen, fitted with a range of contemporary units and offering ample space for both cooking and dining. The kitchen flows seamlessly into the conservatory, creating an additional reception area overlooking the garden and providing an ideal space for entertaining or simply enjoying the outdoor views.

There are two well-proportioned bedrooms, both offering comfortable accommodation, along with a modern three-piece shower room. A useful utility room provides additional storage and laundry facilities, adding further practicality to the home.

Externally, the property boasts a driveway providing off-road parking for several vehicles. The gardens are mainly laid to lawn, creating an attractive outdoor space that can be enjoyed throughout the seasons. A garden shed offers useful storage for tools and equipment. Combining convenience, generous outdoor space, and a desirable location, this bungalow represents an excellent opportunity for a wide range of purchasers.

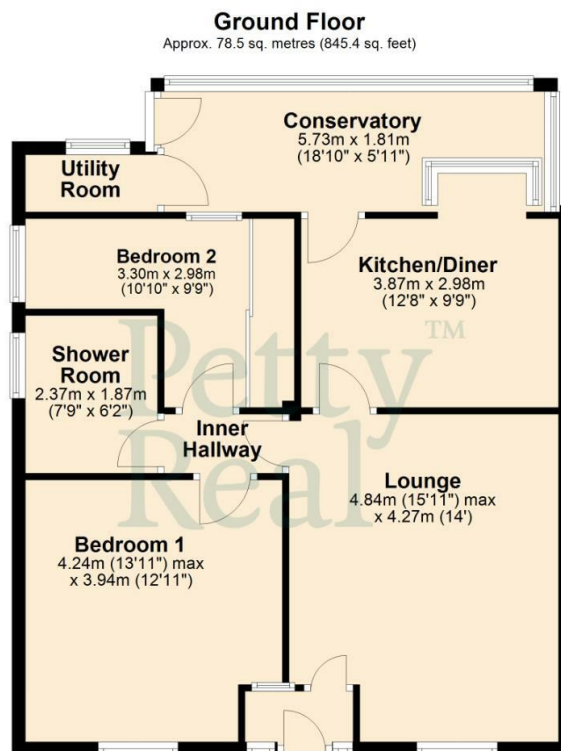

Total area: approx. 78.5 sq. metres (845.4 sq. feet)

All floorplans provided are for guidance only. Please check all dimensions before making any decisions reliant upon them.
Plan produced using PlanUp.



These particulars, whilst believed to be accurate are set out as a general outline only for guidance and do not constitute any part of an offer or contract. Intending purchasers should not rely on them as statements of representation of fact, but must satisfy themselves by inspection or otherwise as to their accuracy. No person in this firm's employment has the authority to make or give any representation or warranty in respect of the property.

11 Albert Road, Colne, Lancashire, BB8 0RY
T. 01282 868686
Colne.sales@pettyreal.co.uk

www.pettyreal.co.uk