

for sale

£290,000



Perseverance Road Hereford HR4 9SN

Situated on Perseverance Road, this well-established, extended, and well-presented family home offers comfortable living in a central, convenient location. Walking distance to multiple stores as well as the city centre, this home further benefits from off-road parking and sizable living space.

Perseverance Road Hereford HR4 9SN

Entrance Hall

Frosted window and door to the front, gas heated radiator, one centre light point.

Cloakroom

Window to the rear, gas heated radiator, wash basin, W.C, one centre light point.

Lounge

Bay window to the front of the property, gas heated radiator, one centre light point.

Kitchen

Modern, floor to ceiling gas heated radiator, wall and base units, plumbing for dishwasher, space for large fridge freezer, under cabinet lighting, integrated gas oven/electric hob and extractor fan, under stair storage cupboard, plumbing for washing machine and space for dryer, window and door to the rear.

Conservatory

Several double-glazed windows to the rear, French doors to the rear, two wall light points, gas heated radiator.

Landing

Window to the side of the property, loft hatch, one centre light point.

Bedroom One

Window to the front of the property, gas heated radiator, one centre light point.

Bedroom Two

Window to the rear of the property, gas heated radiator, one centre light point.

Bedroom Three

Window to the rear of the property, gas heated radiator, one centre light point.

Bathroom

Modern suite, frosted window to the rear of the property, storage cupboard housing the gas boiler, panelled shower cubicle with shower, gas heated towel rail, W.C, wash basin, one centre light point.

Rear Garden

Fence surround, grass patch with stone path to storage shed, pond, lean to by the rear.

Parking

Driveway for multiple cars.





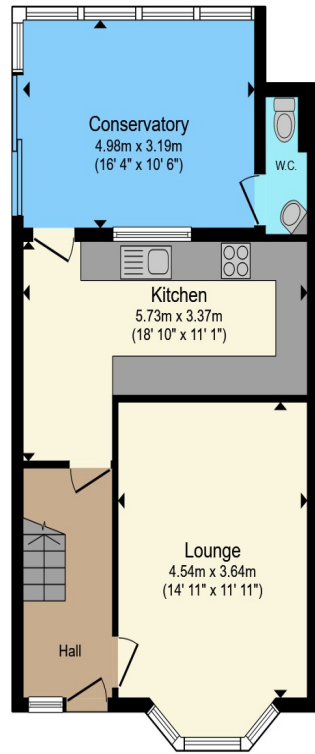

Ground Floor

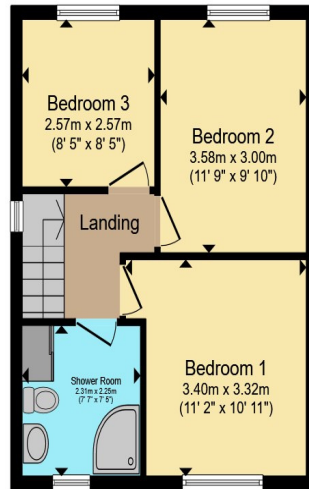

First Floor

Total floor area 93.7 m² (1,009 sq.ft.) approx

This floor plan is for illustrative purposes only. It is not drawn to scale. Any measurements, floor areas (including any total floor area), openings and orientation are approximate. No details are guaranteed, they cannot be relied upon for any purpose and they do not form part of any agreement. No liability is taken for any error, omission or misstatement. A party must rely upon its own inspection(s). Powered by www.propertybox.io

Connells

To view this property please contact Connells on

T 01432 267 511
E hereford@connells.co.uk

23 King Street
HEREFORD HR4 9BX

Property Ref: HER316222 - 0008

Tenure:Freehold EPC Rating: Awaited

Council Tax Band: B

view this property online connells.co.uk/Property/HER316222



1. MONEY LAUNDERING REGULATIONS Intending purchasers will be asked to produce identification documentation at a later stage and we would ask for your co-operation in order that there will be no delay in agreeing the sale. 2. These particulars do not constitute part or all of an offer or contract. 3. The measurements indicated are supplied for guidance only and as such must be considered incorrect. Potential buyers are advised to recheck measurements before committing to any expense. 4. We have not tested any apparatus, equipment, fixtures, fittings or services and it is in the buyers interest to check the working condition of any appliances.

Connells Residential is registered in England and Wales under company number 1489613, Registered Office is Cumbria House, 16-20 Hockliffe Street, Leighton Buzzard, Bedfordshire, LU7 1GN. VAT Registration Number is 500 2481 05.

see all our properties at www.connells.co.uk | www.rightmove.co.uk | www.zoopla.co.uk