

HENDERSON CONNELLAN

ESTATE AGENTS

Kingsley Avenue, Kettering NN16

“Period with Contemporary Twist”

"Period With Contemporary Twist"

This impressive bay-fronted Victorian end of mews home is situated in this sought-after tree lined avenue in the North end of town. The fabulous period features blend seamlessly with the well-presented, up to date interior to include an entrance hall with stained glass window and black and white alternate flooring, living room with feature fireplace and wood burner, guest cloakroom, generous free flowing kitchen/dining room with integrated appliances and a striking redbrick fireplace. Upstairs, the large landing features coving, a loft ladder providing access to a partially boarded loft, and doors leading to three double bedrooms all with period feature fireplaces and a contemporary principal bathroom. Outside, the walled front garden has a gate and pathway to the front door, the South-facing rear garden is a great size featuring a large natural stone patio, perfect for outdoor furniture and a large outbuilding with power and lighting, as well as an additional garden brick shed for storage. Restaurants, Parks, schools the town centre and a wealth of amenities are a short walk away.

- Period Character Charm & Features
- Living Room with Open Fireplace
- Free Flowing Kitchen/Dining Room
- Decorative Fireplaces in all Bedrooms
- Gas Central Heating
- UPVC Double Glazed Windows
- South Facing Large Garden with Sheds
- Walled Fore Garden with Gate to the Front Door
- EPC RATING: D
- COUNCIL TAX: B

Tenure: Freehold





Ground Floor

Approx. 44.4 sq. metres (478.1 sq. feet)

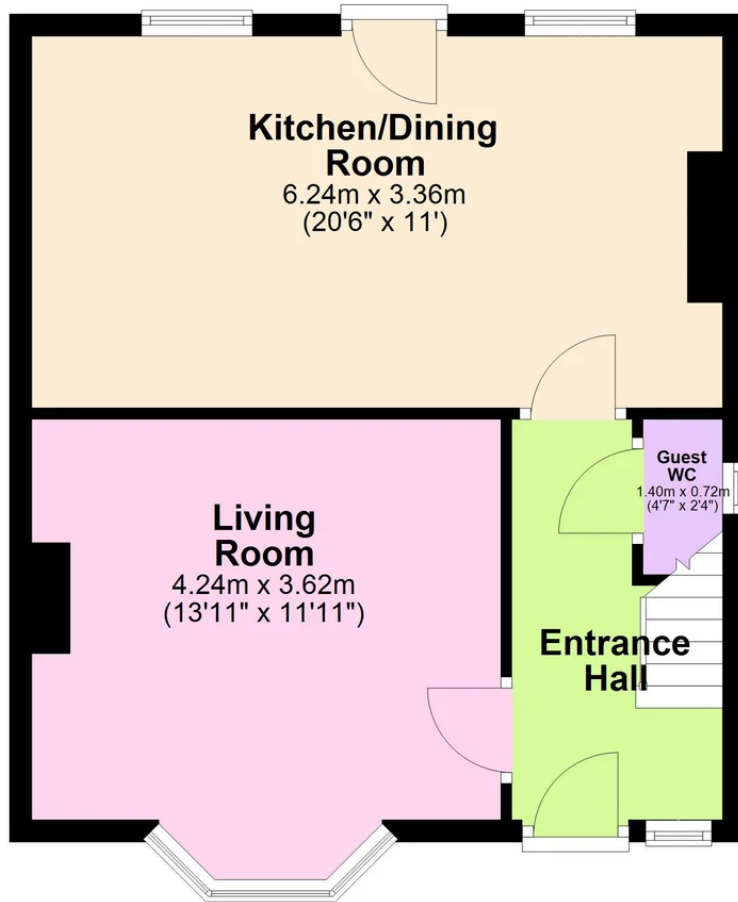

First Floor

Approx. 45.0 sq. metres (484.6 sq. feet)

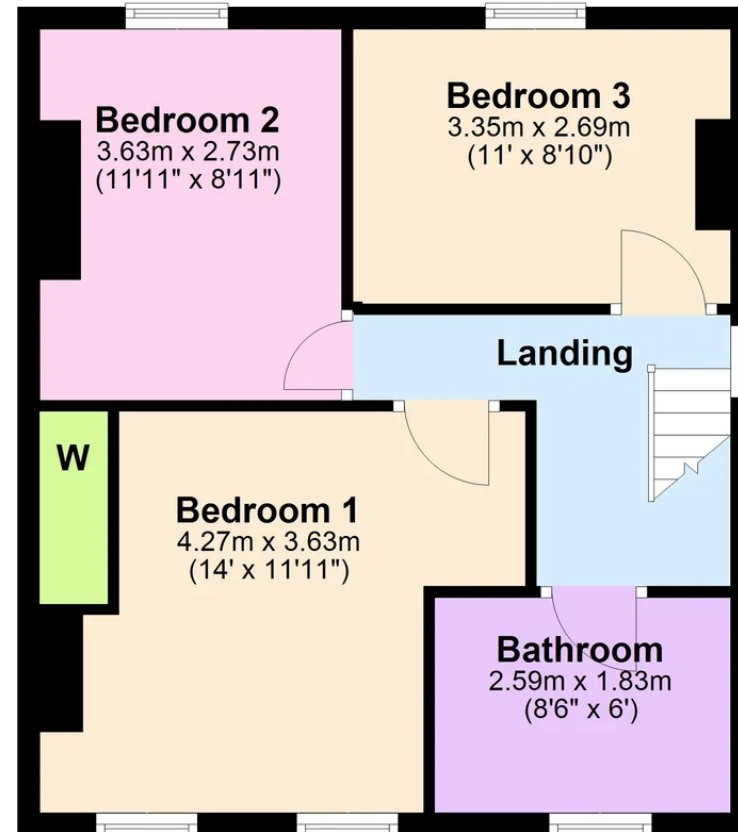

Total area: approx. 89.4 sq. metres (962.7 sq. feet)