



## Lawrence Road, W5

£575,000

\* Offer In Excess Of \*

A smartly presented two bedroom maisonette with a private South facing garden.

Offered in immaculate condition, this would be a perfect first home or ideal for a buyer looking to downsize.

Located just off South Ealing road so close to all amenities including the Piccadilly line tube with easy access to Ealing Broadway.

### Features

Garden Maisonette  
Two Bedrooms  
South Facing  
Excellent Condition  
Convenient Location  
Long Lease



## Lawrence Road, W5

As soon as you get through the front door, you'll realise this is a very nice home.

The private entrance and hallway bring you through to a central lobby. The main bedroom with ensuite shower room is to the front. The main bathroom is very well fitted. You then come through to the spacious 23 ft. Living room with French doors to the South facing garden. This is open plan to the recently fitted high spec kitchen. The second bedroom is also to the rear of the flat.

Ideal for a purchaser looking for a property in turn key condition with a good garden.



Lawrence Road,  
London, W5

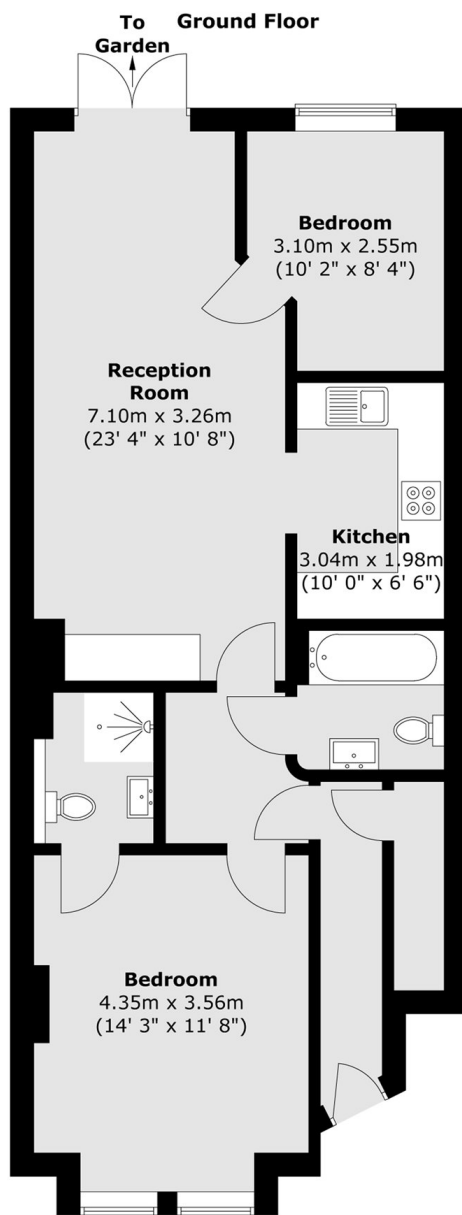

Total area (approx.) : 69 sq. m (743 sq. ft)