

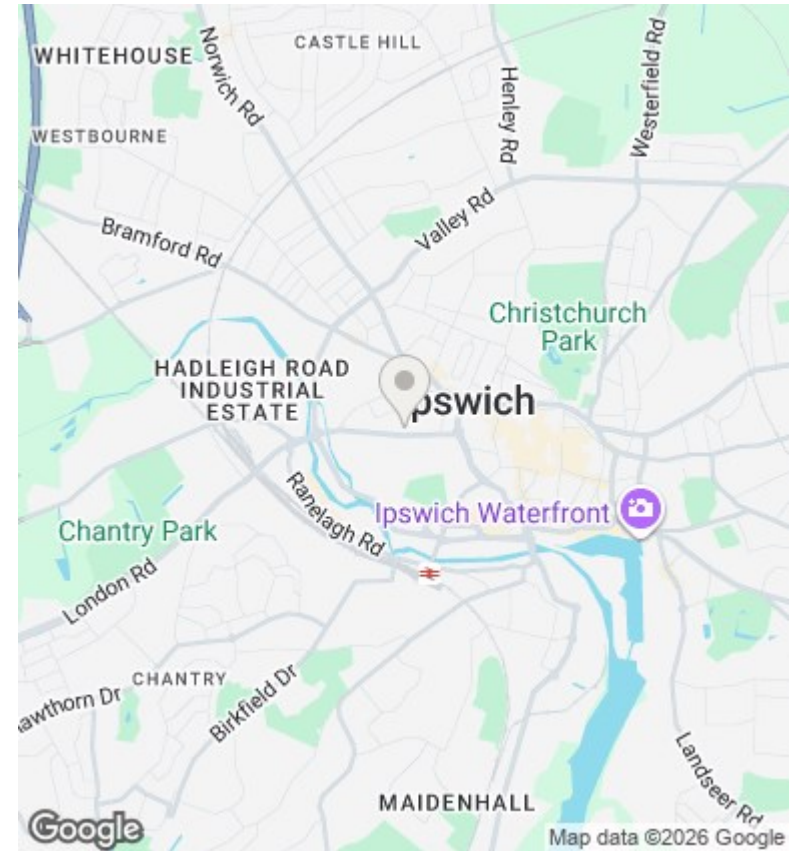

Burlington Road, Ipswich, IP1 2HS

£750 PCM

- Unfurnished One Bedroom Maisonette - West Ipswich
- New Kitchen & Bathroom
- Electric Heating
- AVAILABLE FROM 02/07/2026
- Freshly Decorated Throughout
- EPC Rating - D
- New Carpets/Flooring Throughout
- Permit Parking

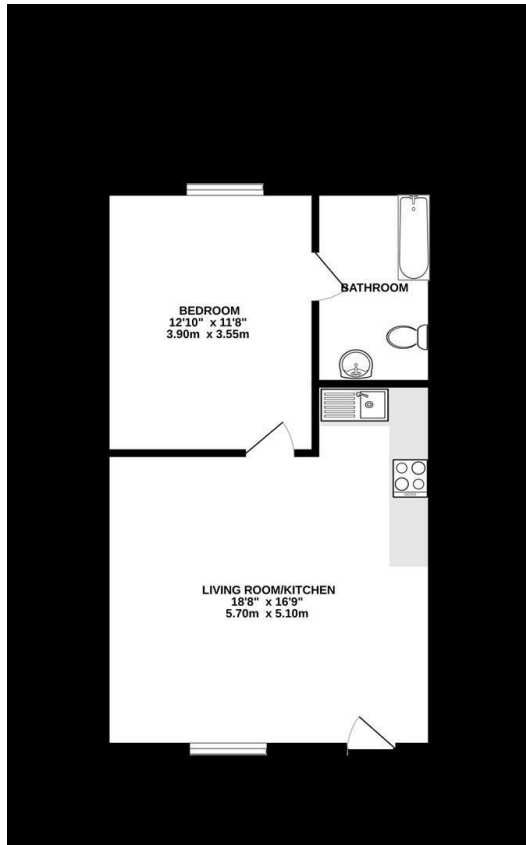

Directions

Viewings

Viewings by arrangement only. Call 01473 221 399 to make an appointment.

EPC Rating:
D

Energy Efficiency Rating		
	Current	Potential
<i>Very energy efficient - lower running costs</i>		
(92 plus) A		
(81-91) B		82
(69-80) C		
(55-68) D	58	
(39-54) E		
(21-38) F		
(1-20) G		
<i>Not energy efficient - higher running costs</i>		
England & Wales	EU Directive 2002/91/EC	