

Towers Wills

Town & Country

📞 01935 577 032 | 01460 298 530 | ✉ info@towerswills.co.uk



14, Watercombe Lane, Yeovil, Somerset BA20 2ED

£425,000

Towers Wills are delighted to present to the market this well-appointed and beautifully presented three-bedroom detached bungalow, originally built in 1947 and significantly enhanced during the current ownership to create a superb home ideal for modern family living and entertaining alike.

Accommodation:

The property is offered in extremely good decorative order throughout and has benefitted from a thoughtful programme of reconfiguration and renovation over the past 15–16 years, resulting in a light and versatile layout that flows particularly well for both everyday use and hosting guests.

The accommodation comprises three good-sized bedrooms, together with a semi-open-plan living and dining area which connects seamlessly to the kitchen, with the added benefit of a separate utility room positioned to the rear. To the first floor, there is the advantage of a generous loft room which enjoys an outlook over the rear garden and provides useful additional space.

Outside:

Externally, the property offers driveway parking to the front for a number of vehicles. A standout feature of the property is the spacious rear garden which is of an excellent size, predominantly laid to lawn and featuring a summer house positioned to one corner and offering a variety of uses. There is a large summer house fully insulated, with electrical supply and a veranda.

Situation:

Watercombe Lane is situated on the eastern side of Yeovil within a highly sought-after and desirable residential location, conveniently placed for local amenities and supermarkets, while remaining within easy reach of the town centre and surrounding transport links.

An early viewing is highly recommended to fully appreciate the space, condition and location this attractive bungalow has to offer.

Key Features

- Detached Bungalow
- Well Presented Throughout
- Popular Location
- Three Bedrooms
- Gardens
- Driveway Parking

Contact Us

**Towers Wills Estate
Agents - Yeovil**

114, Hendford Hill
Yeovil

Somerset

BA202RF

T: 01935 577032

E: info@towerswills.co.uk



Floor Plan

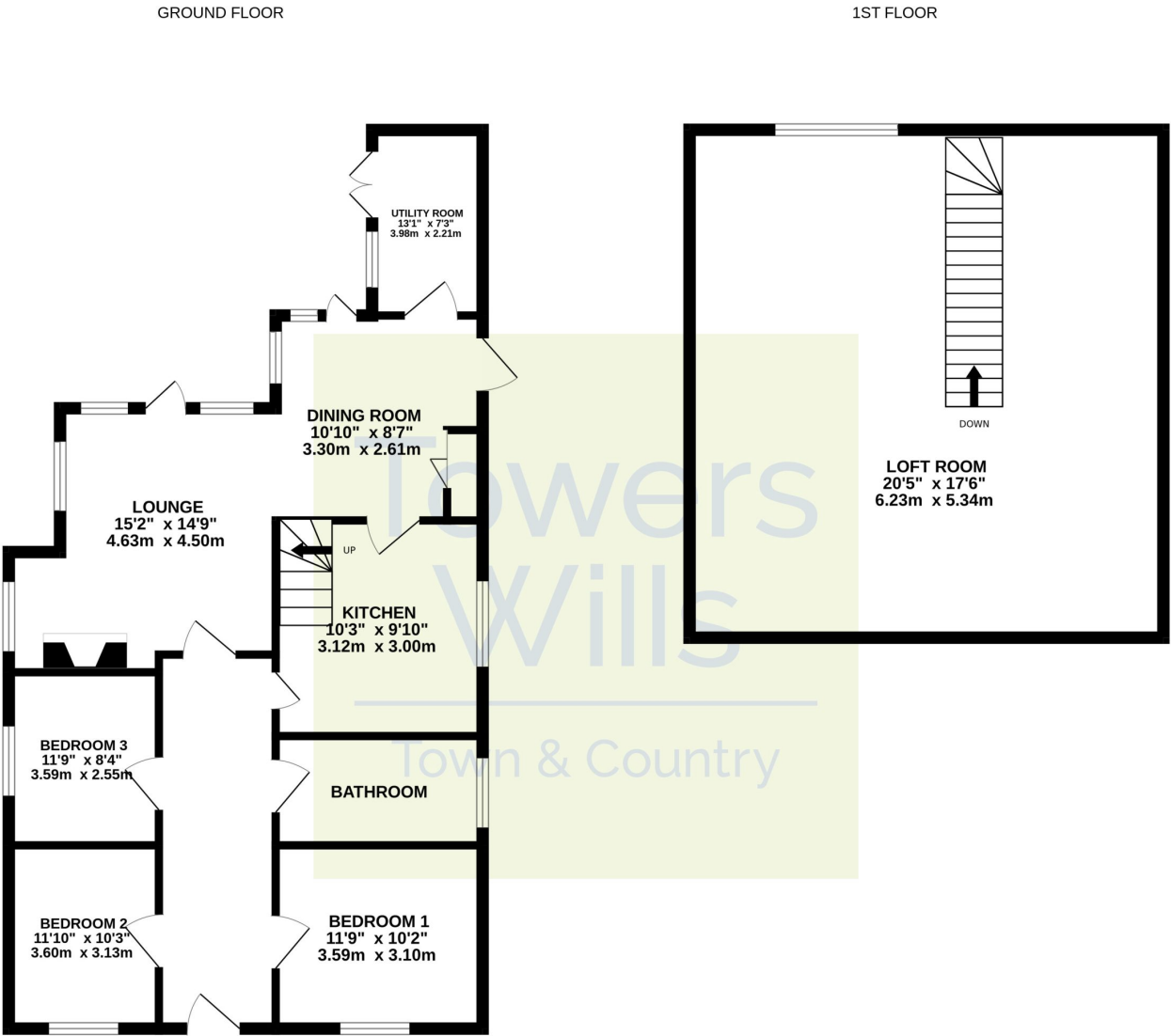

Whilst every attempt has been made to ensure the accuracy of the floorplan contained here, measurements of doors, windows, rooms and any other items are approximate and no responsibility is taken for any error, omission or mis-statement. This plan is for illustrative purposes only and should be used as such by any prospective purchaser. The services, systems and appliances shown have not been tested and no guarantee as to their operability or efficiency can be given.
Made with Metropix ©2026

Please Note No tests have been undertaken of any of the services and any intending purchasers should satisfy themselves in this regard. Towers Wills Ltd for themselves and for the vendor of this property whose agents they are, give notice that, (i) these particulars do not constitute any part of an offer or contract, (ii) all statements contained within these particulars are made without responsibility on the part of Towers Wills or the vendor , (iii) whilst made in good faith, none of the statements contained within these particulars are to be relied upon as a statement of representation or fact , (iv) any intending purchaser must satisfy him/herself by inspection or otherwise as to the correctness of each of the statements contained within these particulars, (v) the vendor does not make or give either Towers Wills or any person in their employment any authority to make or give representation or warranty whatsoever in relation to this property.

Photographs / Floor Plans Photographs are reproduced for general information and it must not be inferred that any item is included for sale with this property. Please note floor plans are not to scale and are for identification purposes only. The photographs used in these particulars may have been taken with the use of a wide angle lens. If you have any queries as to the size of the accommodation or plot, please address these with the agent prior to making an appointment to view