



## Quarry Lane, Red Lake, Telford

£499,900



4



2



3

Freehold | EPC rating: C

- 4 Double Bedrooms
- Expansive 1/4 Acre Spot
- Large Kitchen/Diner

- Bar/Games Room
- Driveway Parking for 6 Cars
- Desirable Red Lake Location

# BELVOIR!

Property is personal

Email  
[telford@belvoir.co.uk](mailto:telford@belvoir.co.uk)

Phone  
**01952 258562**



## Description

Impressive 4-Bedroom Family Home in Red Lake with Converted Double Garage  
Located in the sought-after area of Red Lake, this spacious and beautifully presented four-bedroom detached home offers generous living space throughout—perfect for modern family life and entertaining.

On the ground floor, the property features a stylish open-plan kitchen/diner with plenty of space for cooking and dining, a separate sitting room for cosy evenings, a practical utility room, and a downstairs WC. A standout feature is the converted double garage, now a vibrant bar and games room—ideal for hosting or relaxing in your own private retreat. Between the house and the games room is a single carport with an electric roller door, adding further secure parking.

Upstairs, you'll find four generously sized double bedrooms. The principal bedroom benefits from a modern en suite with both a separate bath and shower, while the family bathroom also features a separate bath and shower, providing luxury and convenience for the whole household.

Outside, the home is surrounded by well-maintained gardens extending to approximately a quarter of an acre, offering plenty of space for outdoor living. A large driveway provides parking for up to six cars, making this home as practical as it is impressive.

Located in a quiet and well-connected area close to local amenities, schools, and commuter routes, this is a rare opportunity to own a truly exceptional family home.

Freehold / EPC U / Council Tax E

## Photographs



Rooms

Hallway

3.61m x 3.28m (11'10" x 10'10")

Living Room

8.2m x 4.37m (26'11" x 14'4")

Kitchen

8.14m x 5.22m (26'8" x 17'1")

Dining Room

Utility Room

3.08m x 1.51m (10'1" x 5'0")

WC

1.77m x 0.76m (5'10" x 2'6")

Bar/Games Room

6.2m x 5.96m (20'4" x 19'7")

Bedroom 1

4.6m x 4.07m (15'1" x 13'5")

Ensuite

3.5m x 2.08m (11'6" x 6'10")

Bedroom 2

4.97m x 3.69m (16'4" x 12'1")

Bedroom 3

4.49m x 3.26m (14'8" x 10'8")

Bedroom 4

3.09m x 2.96m (10'1" x 9'8")

Floorplan

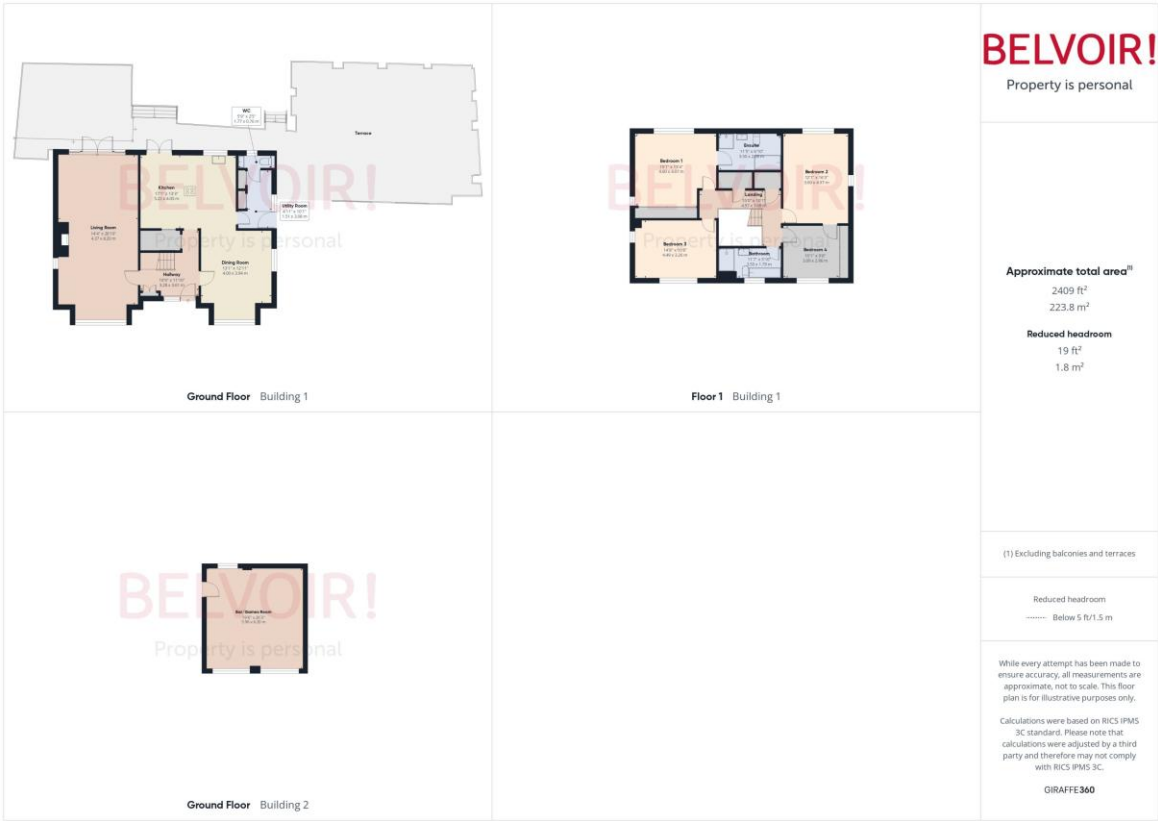

Map

