



For Sale £150,000



Bekeswell Place, Chelmsford

Being offered for sale with no onward chain is this top floor one bedroom apartment located in the Galleywood area. The property benefits from being close to local shops, has panoramic views and a garage in a nearby block.



1 Bedroom(s)



1 Reception(s)



1 Bathroom(s)



ENTRANCE HALL

Deep storage cupboard housing electric fuse box, further storage cupboard with adjacent airing cupboard.

KITCHEN

Fitted in wall and base level units with roll edge worktops, inset single bowl stainless steel sink unit, space for washing machine, fridge/freezer and oven, tiled splashbacks, double glazed window to rear.

LOUNGE

Double glazed window to rear with good views, electric heater.

BEDROOM

Double glazed window to rear, electric heater.

BATHROOM

White suite, bath with mixer taps, low level W.C and wash hand basin, double glazed obscure window to side.

OUTSIDE

Communal grounds include storage shed and garage.

FLOOR PLAN

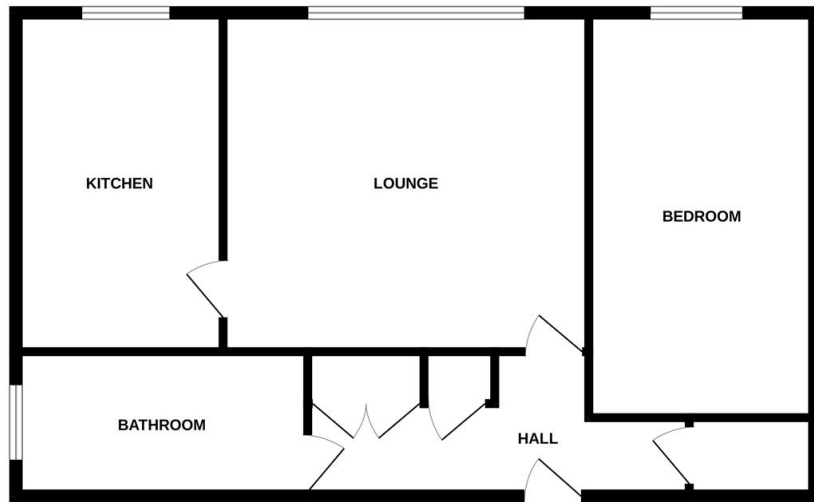

Whilst every attempt has been made to ensure the accuracy of the floorplan contained here, measurements of doors, windows, rooms and any other items are approximate and no responsibility is taken for any error, omission or mis-statement. This plan is for illustrative purposes only and should be used as such by any prospective purchaser. The services, systems and appliances shown have not been tested and no guarantee as to their operability or efficiency can be given.
Made with Metropix i2025

EPC RATING: D
COUNCIL TAX BAND: B
Leasehold

LENGTH OF LEASE: approx. 87 years remaining
ANNUAL GROUND RENT: £10
ANNUAL SERVICE CHARGE: £748.24

These particulars do not constitute an offer or contract and although thought to be accurate are intended only to provide a general guide. Interested parties must personally verify their accuracy. We have not carried out a detailed survey therefore services, heating or specific appliances have not been tested. Sizes indicated should not be relied upon and must be used as a guide only.
ALL NEGOTIATIONS MUST BE CONDUCTED THROUGH ADRIANS ESTATE AGENTS

Please be aware that should you be successful in having an offer accepted through Adrians, we are legally required by the HMRC to conduct AML (Anti-Money Laundering) Checks for compliance efforts. For this there is a non-refundable charge of £25.00 including VAT per person which will be invoice receipted for your records.

For more information, please contact

Adrians, 16 Duke Street, Chelmsford, Essex, CM1 1UP
01245 265303 | info@adrians-property.co.uk | www.adrians-property.co.uk