



Victoria Road, NW7

£2,400 Per calendar month

A unique and spacious duplex apartment offering versatile accommodation across two floors, finished with wood flooring throughout. The property boasts a bright open-plan kitchen and living room with a Juliet balcony, two generous double bedrooms, a separate study, two bathrooms (including an en-suite), and an additional reception room, providing excellent flexibility for modern living

Ideally positioned on the sought-after Victoria Road, the apartment is just moments from Mill Hill Park and within easy walking distance of Mill Hill Broadway. Residents can enjoy an excellent selection of shops, cafés, restaurants, and everyday amenities, while Mill Hill Broadway Thameslink station provides fast and convenient links into Central London.

Features

- Three Bedrooms
- One Reception
- Two Bathrooms
- Wood Flooring
- Split Level
- Terrace

Victoria Road, London, NW7

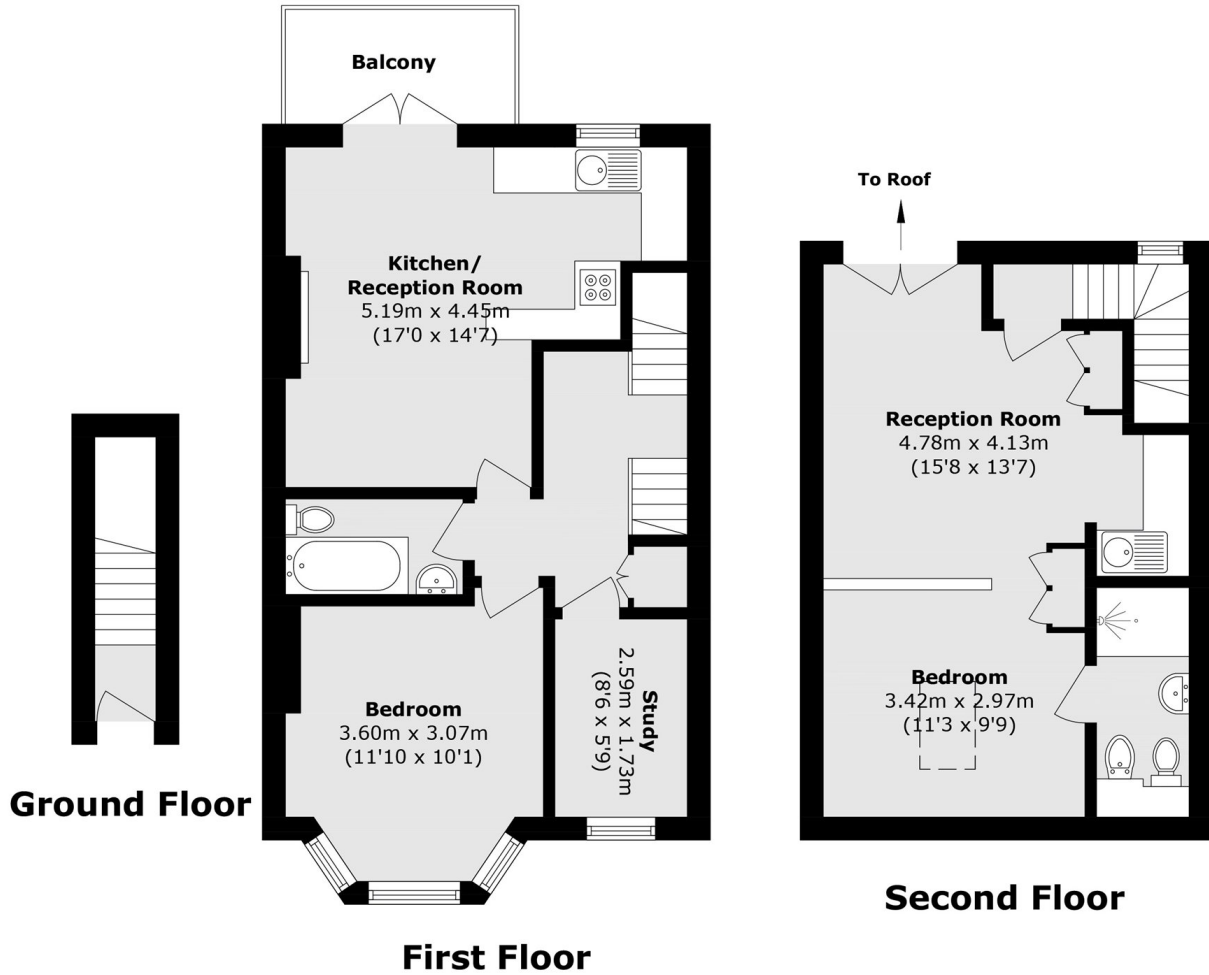

Total area (approx.): 85.3 sq. m (918.2 sq. ft)
Balcony area (approx.): 4.5 sq. m (48.4 sq. ft)