



Luscombe Maye

Since 1873

# Grenville Close, Stokenham, Kingsbridge, TQ7 2SY

Guide Price £450,000

3 1 1



- Three Bedrooms
- Detached Bungalow
- Driveway
- Garage
- Front and Rear Gardens
- Countryside Views
- Spacious Sitting Room with Patio Doors
- Kitchen / Dining Room
- Greenhouse and Garden Shed



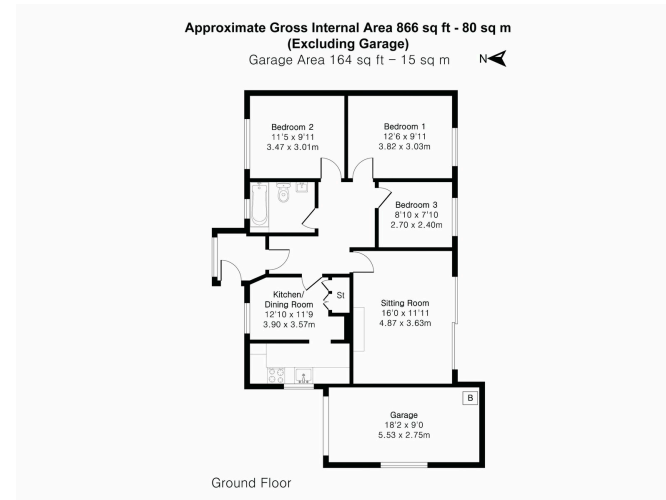

PINK PLAN

Floor plan produced in accordance with RICS Property Measurement 2nd Edition. Although Pink Plan Ltd assures the highest level of accuracy, measurements of doors, windows and rooms are approximate and no responsibility is taken for error, omission or misstatement. These plans are for representation purposes only and no guarantee is given on the total square footage of the property within this plan. The figure seen is for initial guidance only and should not be relied on as a basis of valuation.



Three bedroom detached bungalow with driveway parking, garage and generous gardens, enjoying attractive countryside views and offering a spacious layout with excellent potential.

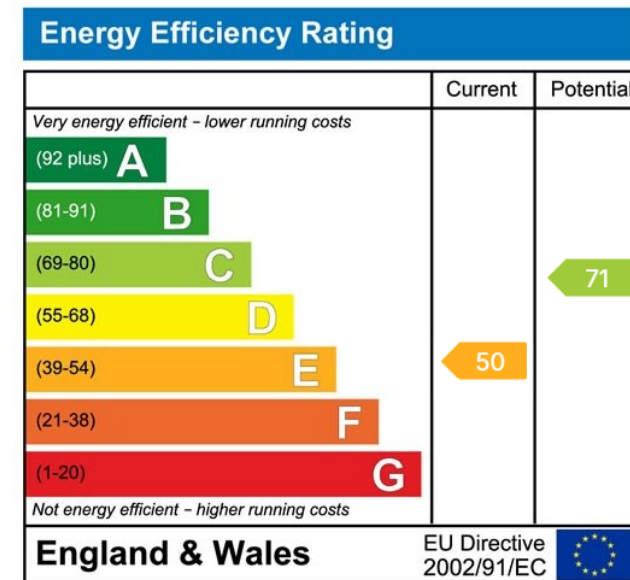

Important Notice: Luscombe Maye gives notice that: 1. These particulars do not constitute an offer or contract or part thereof. 2. All descriptions, photographs and plans are for guidance only and should not be relied upon as statements or representations of fact. All measurements are approximate and not necessarily to scale. Any prospective purchaser must satisfy themselves of the correctness of the information within the particulars by inspection or otherwise. 3. Luscombe Maye does not have any authority to give any representations or warranties whatsoever in relation to this property (including but not limited to planning/building regulations), nor can it enter into any contract on behalf of the Vendor.



**Kingsbridge:**  
62 Fore Street, Kingsbridge TQ7 1PP  
01548 857474  
kingsbridge@luscombemaye.com  
[www.luscombemaye.com](http://www.luscombemaye.com)