



## 5 The Knowle

Hoddesdon, EN11 8LD

**Guide Price £525,000**



Kirby Colletti are delighted to bring to market this well-presented End Terraced four-bedroom town house, ideally located in the sought-after area of The Knowle, Hoddesdon. Perfect for families and professionals alike, the property is just moments from Hoddesdon town centre with its wide range of shops, cafes and local amenities.

The accommodation offers two spacious reception rooms, a modern re-fitted kitchen, two bathrooms and a useful utility room — all designed for comfortable everyday living. Outside, there is off-street parking, an integral garage, and a low-maintenance rear garden.

Situated within easy reach of excellent local schools and under a mile from Broxbourne Railway Station, the home is ideally placed for commuters. Barclay Park is also just a short stroll away, providing a wonderful green space for walks and recreation.

A fantastic opportunity to secure a spacious home in a popular location — early viewing is highly recommended.

- End Terraced Town House
- Re-Fitted Kitchen
- Gas Central Heating
- Close To Town Centre
- Four Bedrooms
- Utility Room
- Double Glazed
- Lounge
- Family Bathroom
- Integral Garage

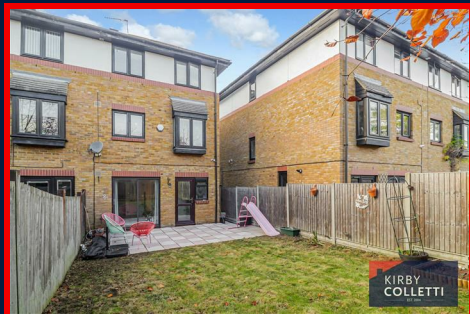

## ACCOMMODATION

uPVC Double glazed door to:

### ENTRANCE HALL

22'7 x 3'2 (6.88m x 0.97m)

Side aspect windows. Stairs to first floor. Storage cupboard. Radiator. Laminated wood flooring. Door to Garage.

### GROUND FLOOR W.C

6'5 x 3'2 (1.96m x 0.97m)

Front aspect uPVC double glazed window. White suite comprising Low level w.c and wash hand basin. Fully tiled walls. Radiator. Laminated wood flooring.

### BEDROOM 4

13'1 x 8'5 (3.99m x 2.57m)

Rear aspect double glazed sliding patio door. Laminated wood flooring. Radiator. Door to:

### EN SUITE SHOWER ROOM

7'8 x 2'5 (2.34m x 0.74m)

White suite comprising fully tiled shower cubicle. Wash hand basin. Fully tiled walls. Extractor fan.

### UTILITY ROOM

6'5 x 6'1 (1.96m x 1.85m)

Rear aspect double glazed window and door to rear garden. Range of wall and base mounted units with wooden work surfaces over. Inset stainless steel single drainer sink unit. Plumbing for washing machine. Fully tiled walls. Laminated wood flooring.

### FIRST FLOOR LANDING

11'1 x 6'6 (3.38m x 1.98m)

Stairs to 2nd floor. Doors to:

### RE FITTED KITCHEN

16'3 max x 15'7 max (4.95m max x 4.75m max)

Rear aspect windows. Range of wall and base units with work surfaces over and 'metro' tiling splashbacks. Ceramic one and a half bowl sink unit with mixer tap over. NEFF electric 4 ring hob with extractor fan above and built electric oven below. Integrated dishwasher. Space for fridge/freezer. Radiator. Access to:

## LIVING ROOM

15'8 x 11'1 (4.78m x 3.38m )

Front aspect uPVC double bay window and separate uPVC double glazed window to front. Radiator. T.V aerial point. Recessed ceiling spotlights. Laminated wood flooring.

## 2ND FLOOR LANDING

10'3 x 6'6 (3.12m x 1.98m)

Side aspect window. Airing cupboard housing wall mounted gas boiler.

## BEDROOM 1

13'8 max x 9'10 (4.17m max x 3.00m )

Two rear aspect windows. Built in wardrobes. Storage cupboard. Radiator.

## BEDROOM 2

12'1 x 8'8 (3.68m x 2.64m)

Front aspect uPVC double glazed window. Built in wardrobe. Radiator.

## BEDROOM 3

8'9 x 6'6 (2.67m x 1.98m )

Front aspect uPVC double glazed window. Built in wardrobe. Radiator

## RE FITTED BATHROOM/W.C

8'10 max x 6'8 (2.69m max x 2.03m)

Fully tiled walls and floor to complement a White suite comprising panel enclosed bath with mixer tap and shower attachment . Separate shower unit with glazed screen. Wash hand basin. Low level W.C. Heated towel rail.

## OUTSIDE

### INTEGRAL GARAGE

17'10" x 8'4" (5.44m x 2.54m)

Up and over door. Light and power connected.

### FRONT GARDEN

Off street parking and access to Garage. Pedestrian side access.

### REAR GARDEN

Paved patio with remainder laid to lawn.

## AGENTS NOTES

COUNCIL TAX: Borough Of Broxbourne BAND C







Road Map



Hybrid Map



Terrain Map



Floor Plan

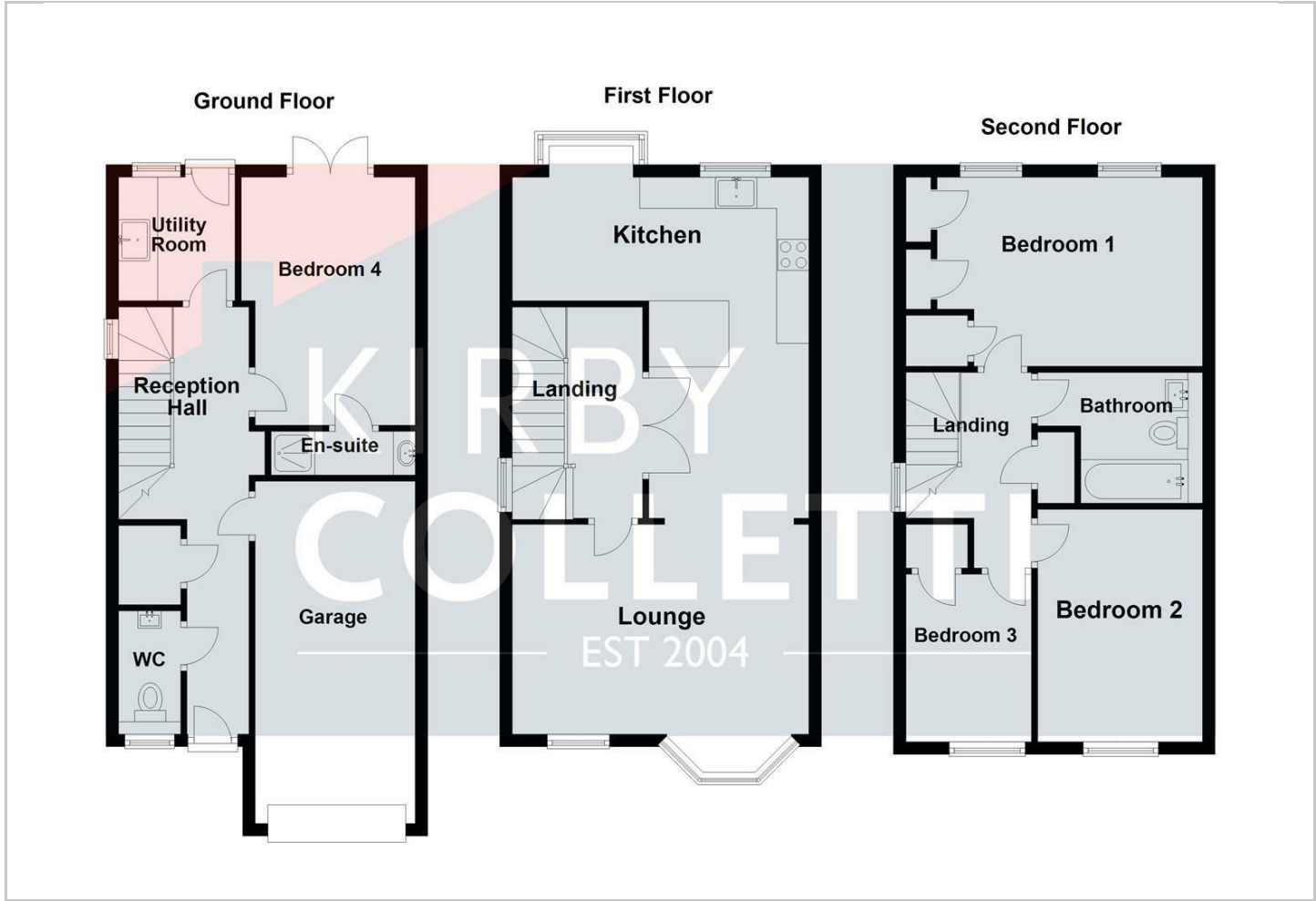

Viewing

Please contact our Kirby Colletti Office on 01992471888 if you wish to arrange a viewing appointment for this property or require further information.

These particulars, whilst believed to be accurate are set out as a general outline only for guidance and do not constitute any part of an offer or contract. Intending purchasers should not rely on them as statements of representation of fact, but must satisfy themselves by inspection or otherwise as to their accuracy. No person in this firms employment has the authority to make or give any representation or warranty in respect of the property.

Energy Efficiency Graph

