



## Park Hill, SW4

£3,300 Per calendar month

A spacious three bedroom flat situated on a popular residential street in Abbeville Village. Offering a spacious reception room with space for dining, a separate kitchen and three double bedrooms.

Crescent Court is half a mile from both Clapham Common Tube and Abbeville Road with vibrant restaurants and shops including, Gail's Bakery and The Abbeville Pub.

### Features

- Three Double Bedrooms
- Spacious Reception
- Separate Kitchen
- Private Balcony
- Built-In Storage
- Communal Garden

# Park Hill, London, SW4

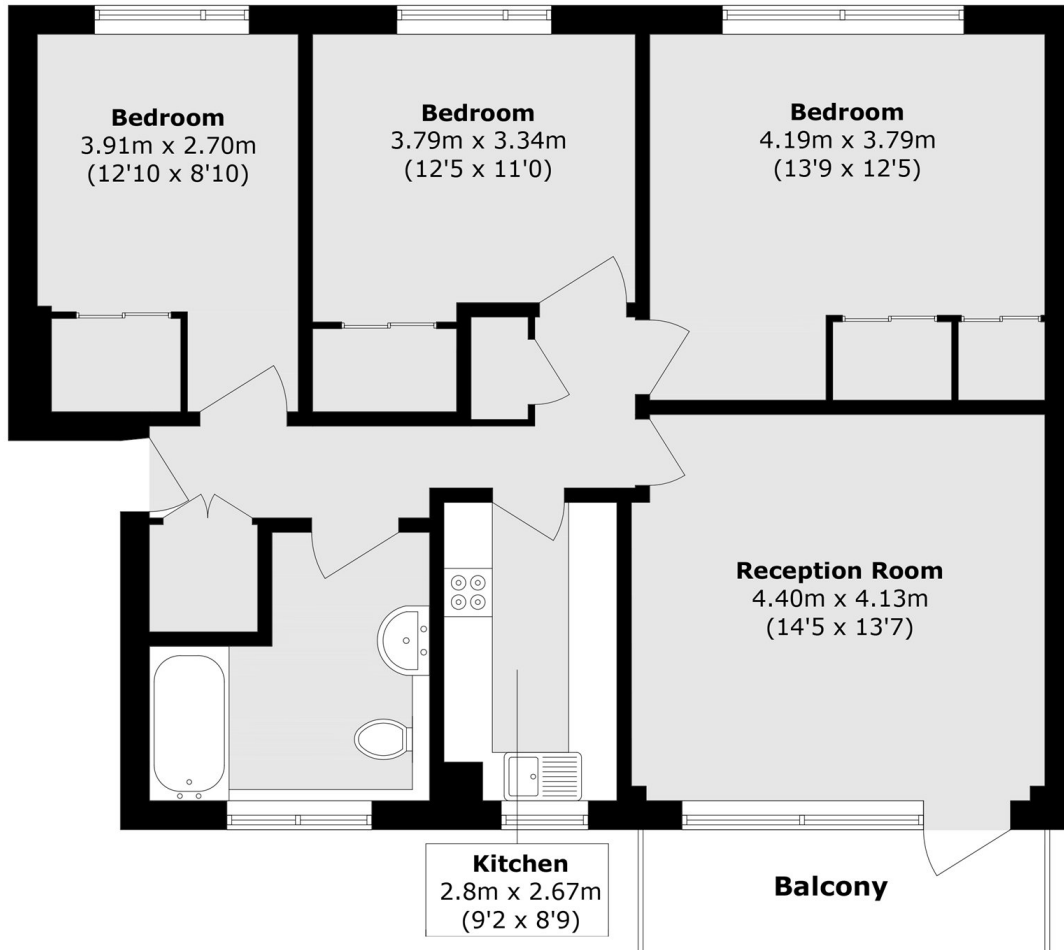

Total area (approx.): 78.1 sq. m (840.6 sq. ft)  
Balcony area (approx.): 5.2 sq. m (55.9 sq. ft)