



East of   
ESTATE AGENTS

East & West of 

Ashford Road  
Topsham OIEO £465,000

# Ashford Road

Topsham OIEO £465,000

A charming two-bedroom mid-terraced home situated on the highly sought-after Ashford Road in Topsham. Full of character and original features, the property offers an exciting opportunity for updating and personalisation, making it ideal for a first-time buyer, investor or those looking to downsize. The accommodation includes two reception rooms, kitchen, ground floor cloakroom and a family bathroom, together with a delightful rear garden. A wonderful chance to create a lovely home in a prime location, offered with no ongoing chain.

Two Bedrooms | Mid Terrace | Sitting/Dining Room | Conservatory | Kitchen | Cloakroom | Family Bathroom | Rear Garden | Parking | Sought After Location | No Ongoing Chain.

## DESCRIPTION

A charming two-bedroom mid-terraced home situated in the highly sought-after Ashford Road in Topsham, offering character features, well-balanced accommodation and a generous rear garden. Requiring a degree of updating and modernisation, the property presents an excellent opportunity for a buyer to put their own stamp on a home in this highly desirable location.

The property opens into a lovely entrance hallway with stairs rising to the first floor, from here access leads into the spacious sitting/dining room, which offers a bright and welcoming space featuring exposed floorboards, bay window to the front and an attractive open fireplace. The room flows through to the modern conservatory, providing additional reception space with doors opening straight out into the garden. The galley kitchen is positioned to the rear of the property and offers practical worktop and storage space. Included in the kitchen is the delightful economy second electric Aga, with two electric ovens and gas hob with module attached.



Located at the end of the kitchen is a convenient ground floor WC.

Upstairs, there are two well-proportioned double bedrooms, both retaining character features including exposed floorboards and feature fireplaces. A family bathroom completes the first-floor accommodation. Outside, the rear garden is mainly laid to lawn and offers a good amount of space for relaxing or entertaining, together with a useful shed and rear access to the back lane. To the rear of the garden is two private parking spaces. With scope for improvement and plenty of potential, this is a wonderful opportunity to create a lovely home in one of the area's most sought-after settings.

### LOCATION

Ashford Road is a highly regarded residential address situated in the sought-after estuary town of Topsham, on the outskirts of Exeter. The area is particularly popular with families and professionals alike, offering a wonderful balance of town and coastal living. Topsham is renowned for its charming Georgian architecture, independent boutiques, cafés and well-regarded restaurants, together with a strong sense of community. The River Exe is only moments way and provides scenic walks along the river with beautiful views and opportunities for sailing, paddle boarding and waterside strolls. The well-regarded local school is only a 2-minute walk away making this a practical as well as desirable place to live. Topsham also benefits from excellent transport links- the railway station offers regular services to Exeter and along the coast towards Exmouth, while the nearby M5 and A30 provide convenient road connections further afield.



## Ground Floor

Approx. 42.0 sq. metres (451.9 sq. feet)

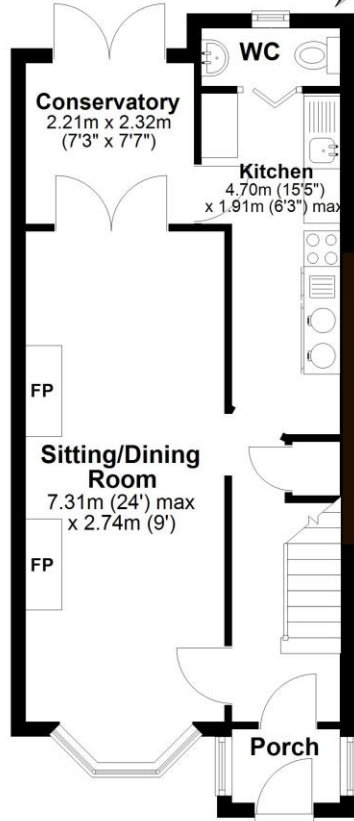

## First Floor

Approx. 29.6 sq. metres (318.1 sq. feet)

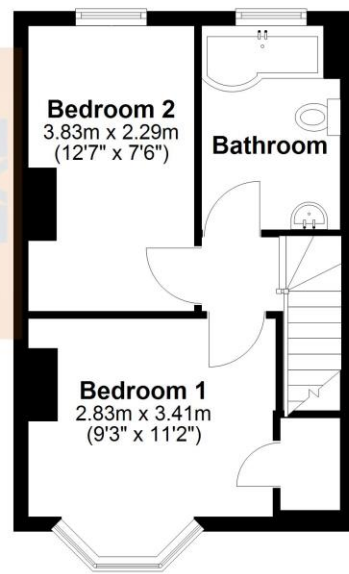

Total area: approx. 71.5 sq. metres (770.0 sq. feet)

### AGENTS NOTES

To the best of the Vendors knowledge, they have advised the following: -

Tenure: Freehold

Council Tax Band: C

Council: Exeter City Council

Parking: TR1 Parking Permits

Garden: Rear Garden

Electricity: Mains

Heating: Mains Gas Boiler

Water supply: Mains

Sewerage: Mains

Broadband: Full Fibre Broadband is available with upto 1600mbps download and 115mbps upload.

Mobile Signal: Several networks currently showing as available at the property including EE and 02

East & West of Exe  
ESTATE AGENTS  
Exceptional Estate Agents



Score	Energy rating	Current	Potential
92+	A		
81-91	B		
69-80	C		
55-68	D	60 D	73 C
39-54	E		
21-38	F		
1-20	G		

Agents Note: Whilst every care has been taken in the preparation of these sales particulars, they are for general guidance only. All measurements, descriptions and other details are approximate and should not be relied upon as statements of fact. Prospective purchasers must satisfy themselves, as to the accuracy of the information by inspection, measurement or otherwise. If inadvertently omitted or inaccurate details come to light after distribution, East and West of Exe reserves the right to withdraw, amend and reissue this brochure without notice or liability for any financial loss prior to exchange of contracts. East and West of Exe has no authority to make legal representations or warranties in relation to the property, including but not limited to boundaries, environmental matters, planning, building regulations and title matters, and cannot enter into any contract on behalf of the Vendor. All offers are subject to contract and the Vendor reserves the right to refuse any offer without giving reason. We do not accept responsibility for any expenses incurred by prospective purchasers at any stage of the transaction, in relation to properties that have been sold, let, or withdrawn. These particulars are prepared in accordance with the Consumer Protection from Unfair Trading Regulations (2008) and the Business Protection from Misleading Marketing Regulations (2008). Any material information known to the agent has been disclosed; however, buyers must make their own enquiries to confirm any details that are material to their purchasing decision.



### EXETER OFFICE

18 Southernhay West Exeter EX1 1PJ

Tel: 01392 833999

enquiries@eastofexe.co.uk

www.eastofexe.co.uk

### EAST DEVON OFFICE

61 Fore Street Topsham Exeter EX3 0HL

Tel: 01392 345070

enquiries@eastofexe.co.uk

www.eastofexe.co.uk

### WEST OF EXE OFFICE

Main Road Exminster EX6 8DB

Tel: 01392 833999

enquiries@westofexe.co.uk

www.westofexe.co.uk