

London Road, Hazel Grove, Stockport, SK7 6AA

£1,150 Per Month

Council Tax Band: A



\*\*\* 2 BEDROOM TERRACED HOUSE IN STOCKPORT SK7 \*\*\*

Nestled on the charming London Road in Hazel Grove, Stockport, this delightful mid-terrace house offers a perfect blend of character and modern living. Built in 1900, the property boasts a rich history while providing a comfortable and inviting atmosphere for its residents.

Spanning an area of 667 square feet, this home features a well-proportioned reception room that serves as an ideal space for relaxation or entertaining guests. The two bedrooms are thoughtfully designed, providing ample space for rest and personalisation, making it suitable for a small family or professionals seeking a cosy retreat.

The property includes a well-appointed bathroom, ensuring convenience for daily routines. The mid-terrace design not only enhances the property's charm but also fosters a sense of community in this desirable neighbourhood.

With its prime location on London Road, residents will enjoy easy access to local amenities, including shops, schools, and parks, all within a short distance. The area is well-connected to public transport, making commuting to nearby towns and the city centre a breeze.

This charming house presents an excellent opportunity for those looking to establish their home in a vibrant and welcoming community. Whether you are a first-time buyer or seeking a rental investment, this property is sure to impress with its character and potential. Don't miss the chance to make this lovely house your new home and contact us today.

Open House Estate Agents  
61 Kingsway, Manchester M19 2LL  
0161 225 6926



Open House South East Manchester

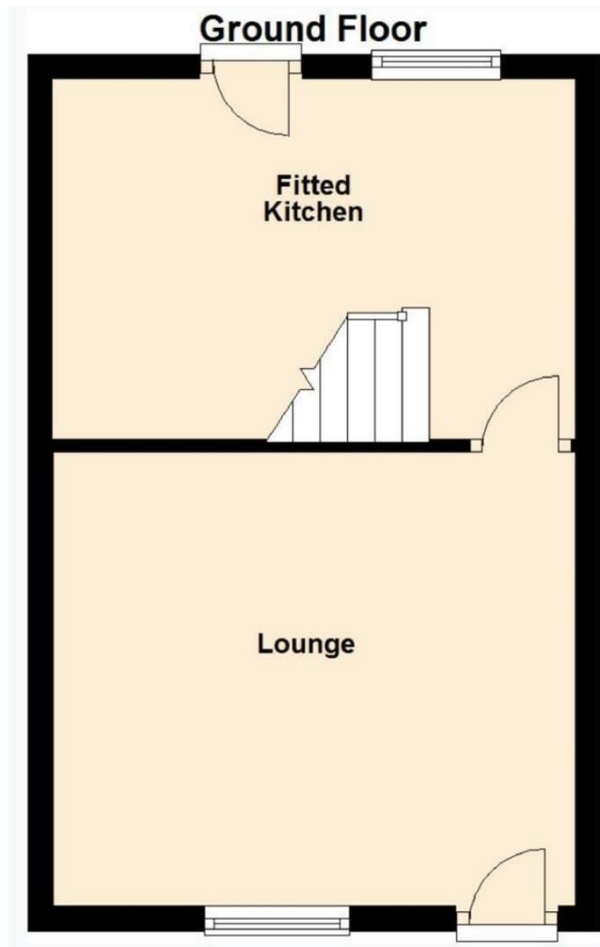

Energy Efficiency Rating		
	Current	Potential
Very energy efficient - lower running costs		
(92 plus) <b>A</b>		
(81-91) <b>B</b>		
(69-80) <b>C</b>		
(55-68) <b>D</b>		
(39-54) <b>E</b>		
(21-38) <b>F</b>		
(1-20) <b>G</b>		
Not energy efficient - higher running costs		
<b>England &amp; Wales</b>	EU Directive 2002/91/EC	